

TRAILBLAZER SERIES

BASECAMP 55

Basecamp 55RTGO

Assembly Manual

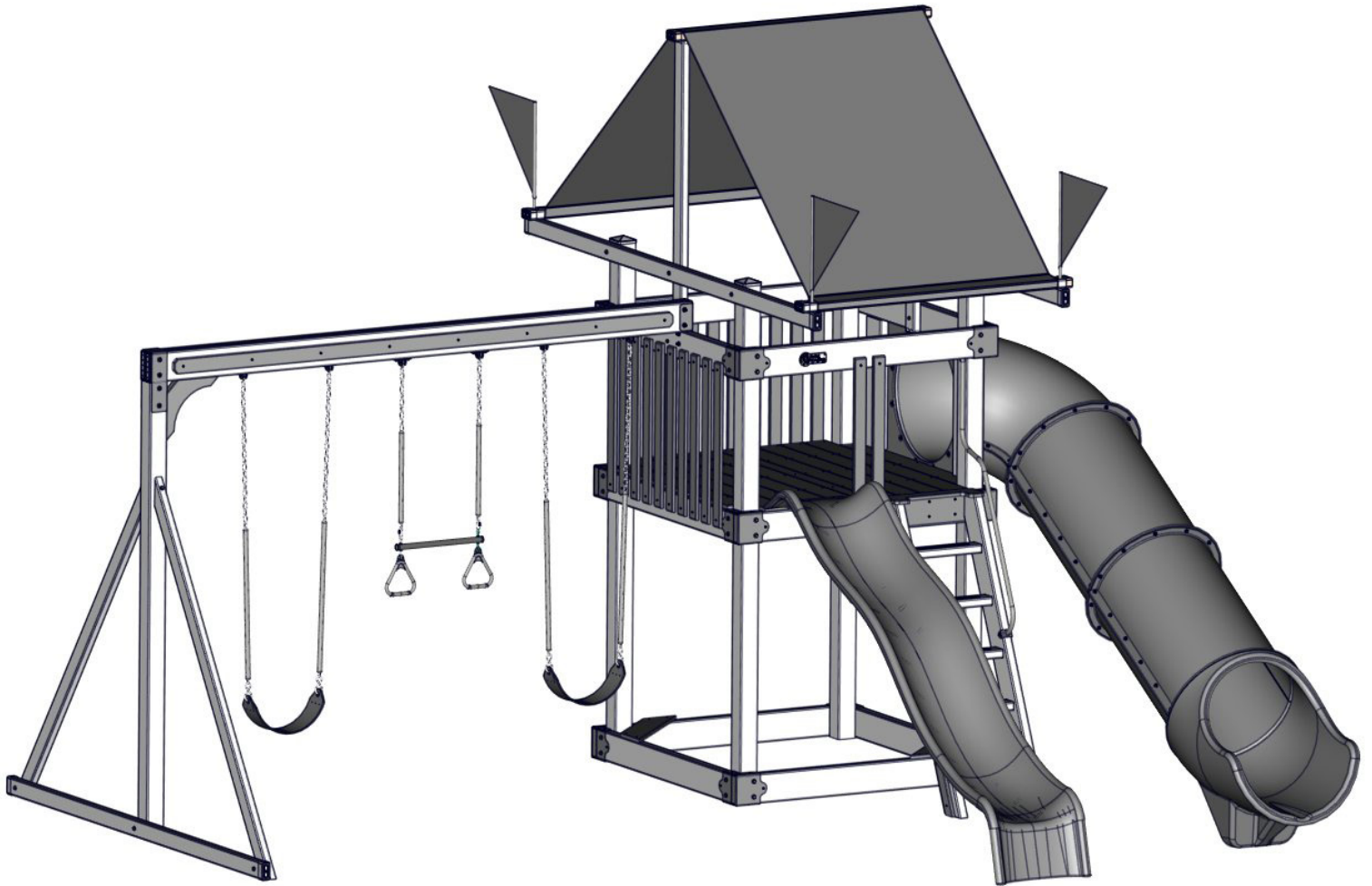

Recommended People: 2

Assembly Time: 3-4 hours



Swing Kingdom

www.swingkingdom.com

CONTENTS

| | |
|----------------------------|----|
| Safety Info | 4 |
| Parts List | 5 |
| Part Drawings | 6 |
| Hardware | 9 |
| Tower Assembly..... | 10 |
| Floor Assembly | 13 |
| Railing Assembly..... | 14 |
| Poly Slat Assembly | 15 |
| Ladder Install..... | 17 |
| Swing Frame Assembly | 18 |
| Roof Assembly..... | 20 |
| Accessory Install | 21 |
| Stake Install..... | 22 |

TOOLS INCLUDED FOR ASSEMBLY

- #2 Square Drive Bit
- Slat Spacer

TOOLS REQUIRED FOR ASSEMBLY

- Impact Drill
- Socket Attachment
- 1/2" Socket
- 9/16" Socket
- Step Ladder
- Tape Measure
- Safety Glasses
- Level
- 9/16" Wrench
- Hammer
- Knife or Box Cutter

ABOUT US

For loads of fun and family time, count on Swing Kingdom. A family operated manufacturer of premier vinyl playsets, we strive to design and build fine quality, affordable playsets perfect for children of all ages.

From the 500 square foot building where we started our business in 2000, to our current 43,000 square foot facility, Swing Kingdom has expanded to meet the growing demand for high quality, virtually maintenance-free playsets. We were the first manufacturer to combine vinyl PVC and structural wood, along with stainless steel hardware for superior strength. Today, we continue to use only the finest quality materials to ensure safe, durable playsets built to offer years of enjoyment.

Our playsets are loaded with activities that will spark every child's imagination and encourage daily physical activity and never-ending fun!

SUPPORT

Support@SwingKingdom.com

717-656-4449

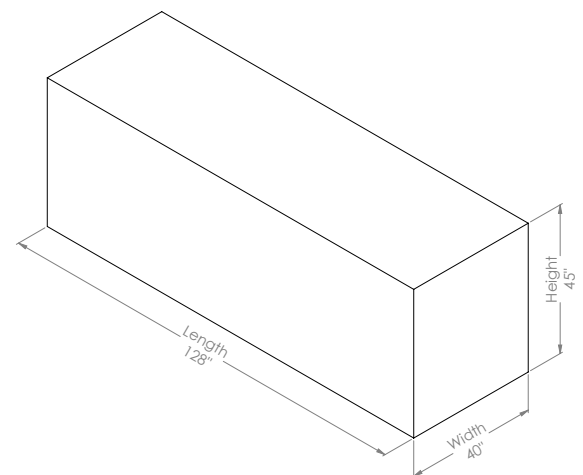

Skid Dimensions:
128" Length x 40" Width x 45" Height

Package Weight: 1,290 lbs

Version: 1.1

Last Updated: April 15, 2025

INTRODUCTION

Swing Kingdom's playsets are engineered from a safety first perspective. Our slip resistant vinyl-clad construction materials are always splinter free and no wood means no harsh chemical treatments. Stainless steel hardware brings added stability, while preventing rust and corrosion.

Our premium vinyl playsets are five times stronger than traditional wooden playsets. Each playset is manufactured with a high standard of durability and quality along with a 5-year warranty to stand behind our product.

We hope that the information on these pages will help you with assembling your Swing Kingdom playset. If you are unable to find the answers to your questions here when building, please contact your local authorized Swing Kingdom dealer, or call us direct at 717-656-4449.

WARRANTY

Subject to ordinary residential use and proper installation.

Swing Kingdom warrants to the original purchaser at the original installation address, that the structural components of the playset, such as the PVC vinyl and wood components are covered by a 5-year warranty. In addition, all canopies, slides, metal components, swings and accessories are warranted for 5 years from date of original purchase.

Swing Kingdom's products are not warranted as being suitable for a particular purpose. The suitability of the product is for the purchaser to determine. This warranty does not cover normal wear and tear, failure to properly maintain the product, or damage resulting from misuse or abuse of the product, additionally any acts of nature such as lightning, storms, hurricanes, tornadoes, earthquakes or any extreme weather conditions. Also any alteration, additions or relocation of the product will void this warranty.

Swing Kingdom reserves the right to examine photographs and/or physical evidence of the product claimed to be defective, and to recover product prior to any warranty claims. All products returned for inspection must be sent freight prepaid. In the event of a defect covered by these warranties, Swing Kingdom will remedy the defect within a reasonable time. The remedy will consist of repair or replacement of the defective piece unless it is not practical. Then Swing Kingdom will reimburse the original purchaser for the value of the defective piece.

All freight cost of replacement parts are not covered under warranty and will be the purchaser's responsibility to cover.

Adult supervision is recommended while enjoying your play system.



WARNING

- This instruction manual contains important information necessary for the proper assembly and safe use of the playset.
- Read and follow all warnings and instructions before assembling.
- Follow all warnings and instructions.
- Keep this manual for future reference.

SAFETY WARNING

Failure to follow these instructions could result in faulty equipment, which could cause property damage, personal injury or death! **Remember: Think Safety and Use Common Sense!**

Prevent Serious Injury or Death and Equipment Damage When Installing

- Work on dry sunny days to minimize the risk of slipping.
- Move items close to your body and use your legs when lifting an item from a low location.
- Avoid twisting, especially when bending forward while lifting. Turn by moving the feet rather than twisting the torso.
- Keep your elbows close to your body and keep the load as close to your body as possible.
- Limit weight you lift to no more than 50 pounds. When lifting product heavier than 50 pounds, use two or more people to lift the product up.
- Use personal protective equipment and clothing such as safety helmets, gloves, safety goggles, ear protection, and safety footwear.

Maintenance

It is of particular importance that these guidelines be followed at the beginning of each season as well as at regular intervals during the usage season:

- Check all nuts and bolts for tightness and tighten when required.
- Check all coverings for bolts and sharp edges and replace when required.
- Check swing seats, chains, ropes and other means of attachments for evidence of deterioration.
- Replace defective parts in accordance with the manufacturer's instructions.

General Safety Precautions

Users who use hand and power tools and who are exposed to the hazards of falling, flying, abrasive and splashing objects, or exposed to harmful dusts, fumes, mists, vapors, or gases must be provided with the particular personal equipment necessary to protect them from the hazard.

All hazards involved in the use of power tools can be prevented by following five basic safety rules:

- Keep all tools in good condition with regular maintenance.
- Use the right tool for the job.
- Examine each tool for damage before use.
- Operate according to the manufacturer's instructions.
- Provide and use the proper protective equipment.

Fasteners

When using power tools to apply fasteners, there are some precautions to consider:

- Fasteners must not be fired into material that would let them pass through to the other side.
- The fastener must not be driven into materials like brick or concrete any closer than 3 inches to an edge or corner.
- In steel, the fastener must not come any closer than one-half inch from a corner or edge.
- Fasteners must not be driven into very hard or brittle materials which might chip, splatter, or make the fastener ricochet.

Parts

Tower

| Qty | Parts |
|-----|--|
| 6 | 60" 2x6 |
| 6 | 56" 2x6 |
| 4 | 105" 4x4 Post |
| 2 | 55 ³ / ₄ " 2x4 Joist |
| 1 | 3 ³ / ₈ " x 59 ¹ / ₂ " Floorboard |
| 6 | 5 ¹ / ₂ " x 59 ¹ / ₂ " Floorboard |
| 2 | 5 ¹ / ₂ " x 48" Floorboard |
| 2 | Poly Corner Seats |
| 20 | ³ / ₄ " x 2 ⁵ / ₈ " x 33 ³ / ₈ " Poly Slat |
| 2 | 26 ¹ / ₄ " 2x6 w/ poly attached |

Swing Frame

| | |
|---|------------------------|
| 1 | 5x5 Poly Slat Template |
| 2 | 126" 2x6 Swing Beam |
| 2 | 92" 4x4 Post |
| 1 | 106" 2x4 Ground Board |
| 2 | 89" 2x4 Brace |
| 1 | Poly Brace |
| 2 | Swing Beam Post Plate |
| 1 | Swing Beam Bracket |

Roof

| | |
|---|--------------------------------------|
| 2 | 120" 2x4 |
| 2 | 63 ⁵ / ₈ " 2x4 |
| 1 | 59 ¹ / ₂ " 2x4 |
| 1 | Canvas Roof |
| 2 | 62 ¹ / ₂ " 2x4 |
| 4 | Roof Flags |

Accessories

| | |
|---|------------------|
| 1 | Access Ladder |
| 1 | Ladder Handrail |
| 1 | Waterfall Slide |
| 2 | Belt Swing |
| 1 | Trapeze |
| 1 | Sidewinder Slide |

Hardware Packs

Tower

| | |
|----|---|
| 48 | ⁹ / ₁₆ " x 4" Lag |
| 48 | ³ / ₈ " Washer |
| 36 | 1 ³ / ₄ " Washer Head Screw |

Floor

| | |
|-----|---------------------|
| 109 | 2" Polybuster Screw |
|-----|---------------------|

Poly Slat

| | |
|----|---|
| 44 | 1 ³ / ₄ " Washer Head Screw |
|----|---|

Swing Frame

| | |
|----|---|
| 6 | ⁹ / ₁₆ " x 5" Bolt |
| 2 | ⁹ / ₁₆ " x 2 ³ / ₄ " Bolt |
| 8 | ⁹ / ₁₆ " Locking Nut |
| 3 | ⁹ / ₁₆ " x 4" Lag |
| 2 | ⁹ / ₁₆ " x 3" Lag |
| 21 | ³ / ₈ " Washer |

Swing Hook

| | |
|----|---|
| 6 | Swing Hooks |
| 12 | ⁹ / ₁₆ " x 4" Lag |
| 12 | ³ / ₈ " Washer |

Roof

| | |
|----|---|
| 10 | ⁹ / ₁₆ " x 4" Lag |
| 4 | ⁹ / ₁₆ " x 3" Lag |
| 14 | ³ / ₈ " Washer |

Accessories

| | |
|---|---|
| 6 | 1 ³ / ₄ " Washer Head Screw |
| 3 | 1/4" x 1 ¹ / ₄ " Pan Head Screw |
| 3 | ⁵ / ₁₆ " Washer |

Stake

| | |
|---|--|
| 2 | Stake |
| 2 | 1/2" x 1 ¹ / ₂ " Lag |
| 2 | ⁵ / ₁₆ " Washer |

Tower Parts

A1 - 60" 2x6 (x5)



A2 - 60" 2x6 with Sequence Plaque (x1)



B1 - 56" 2x6 (x2)



B2 - 56" 2x6 with roof hole (x1)



B3 - 56" 2x6 with roof & swing beam holes (x1)



D - 56" 2x6 w/ Joist Hangers (x2)



C1 & C2 - 105" 4x4 Post (x4)



E - 55 3/4" 2x4 Joist (x3)



F1 - 3 3/8" x 59 1/2" Floorboard (x1)



G - Poly Corner Seat (x2)



F2 - 5 1/2" x 59 1/2" Floorboard (x8)



H - 2 5/8" x 33 3/8" Poly Slat (x22)



F3 - 5 1/2" x 48" Floorboard (x2)



I - Poly Slat Template (x1)



V - 26 1/4" 2x6 w/ poly attached (x2)

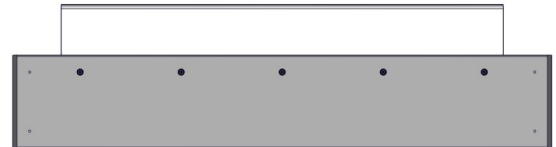

Roof Parts

Q - 120" 2x4 Roof Railing (x2)



U - Flag (x4)

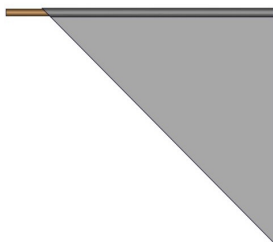

R - 63 5/8" Vertical 2x4 (x2)



S - 50 1/2" 2x4 (x2)



T - (1) Canvas with (2) 62 1/2" 2x4



Swing Frame Parts

J - 126" 2x6 Swing Beam (x1)



L - 106" 2x4 Ground Board (x1)



K - 92" 4x4 Post (x1)



P - Bracket (x1)



O - Post Plate (x2)



M - 89" 2x4 Brace (x2)



N - Poly Brace (x1)



Accessories

Belt Swing (x2)

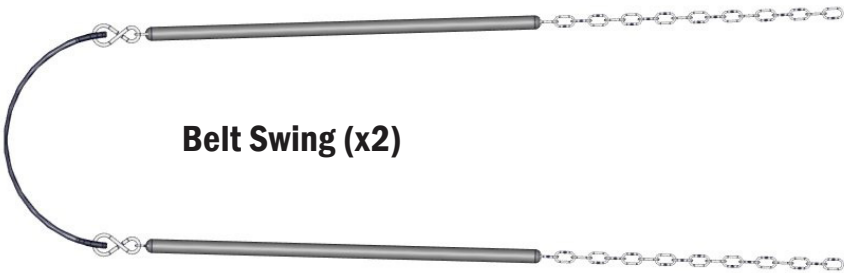

Trapeze (x1)

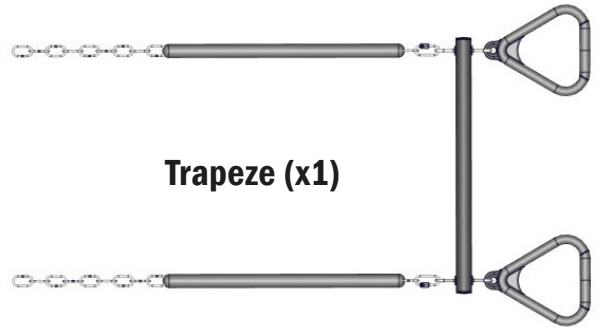

Waterfall Slide (x1)

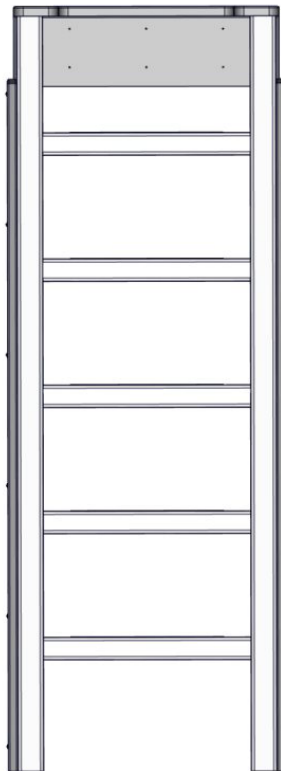

Ladder (x1)

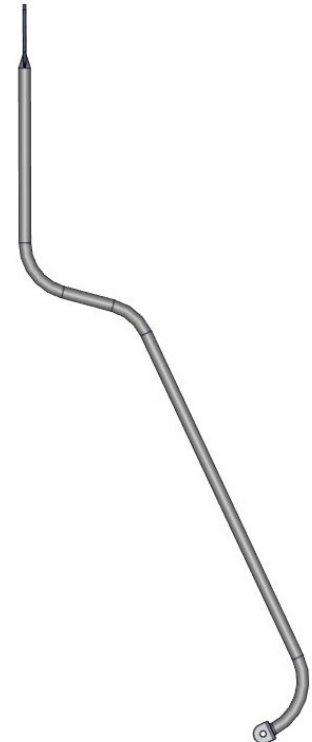

Ladder Handrail (x1)

Sidewinder Slide Parts

Entry Plate (x1)

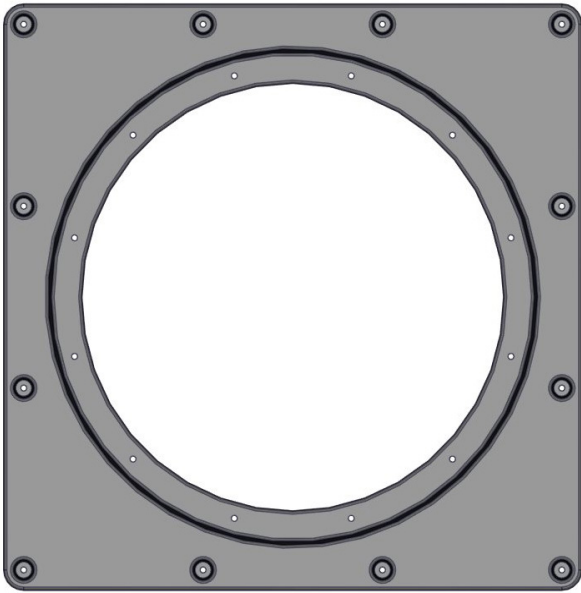

Elbow - Top (x1)



Elbow - Bottom (x1)



Straight Tube - Top (x2)



Straight Tube - Bottom (x2)



Tube Slide Exit (x1)

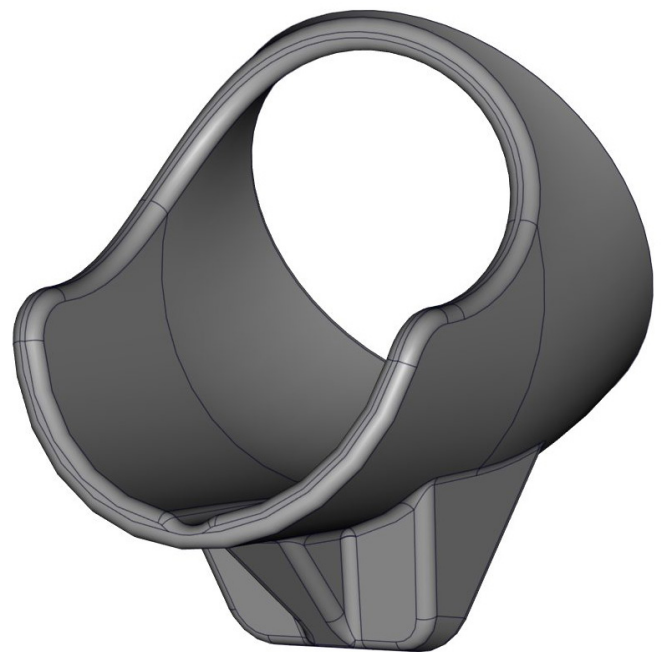

HARDWARE

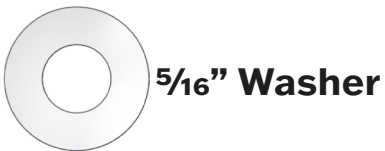
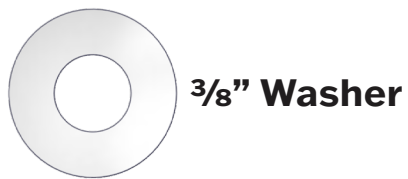
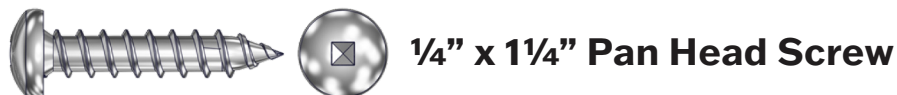
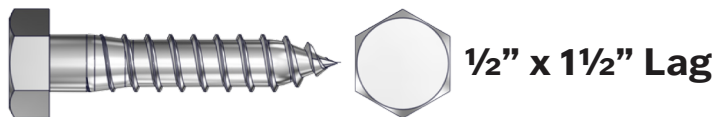
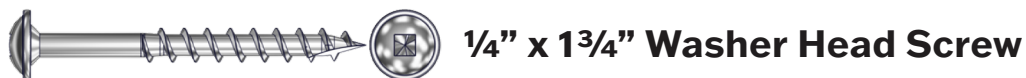
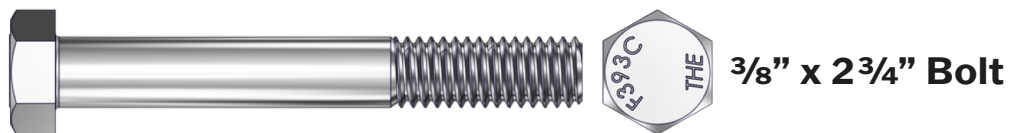
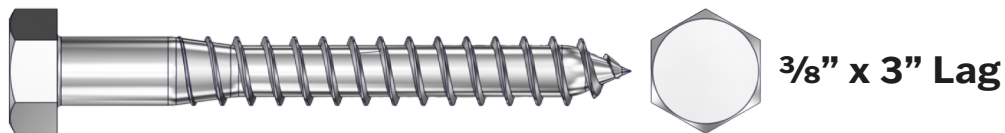
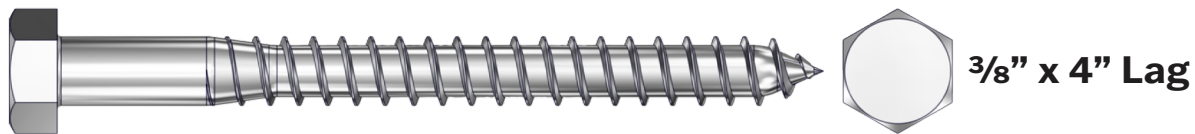

TOWER ASSEMBLY

STEP
01

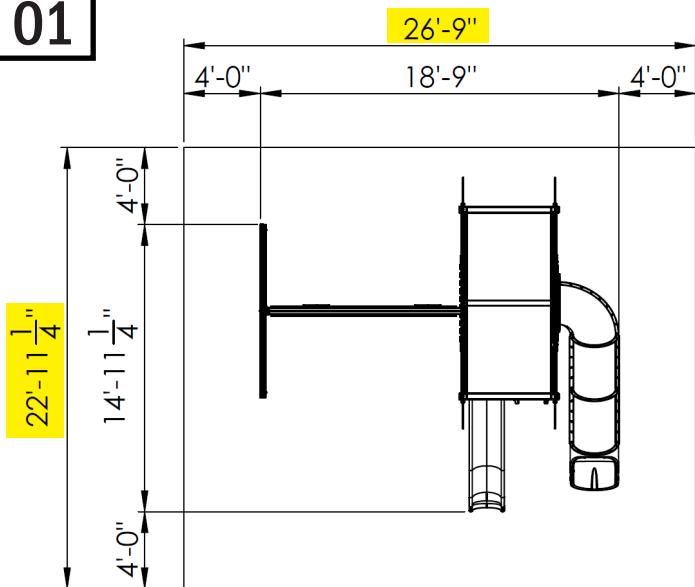

- Review the dimensions above (4ft is our recommended space around the playset. CPSC recommends 6ft. You may need to review your local laws or guidelines for more assistance.)
- Find a level surface. (You may need to dig out high areas or use treated lumber to block up low areas to make your surface level.)
- Determine where you want the front & back of the playset.
- Lay out each bundle. (Don't unwrap the bundles until you reach the appropriate step. Only cut in the creases to avoid damaging items.)

STEP
02

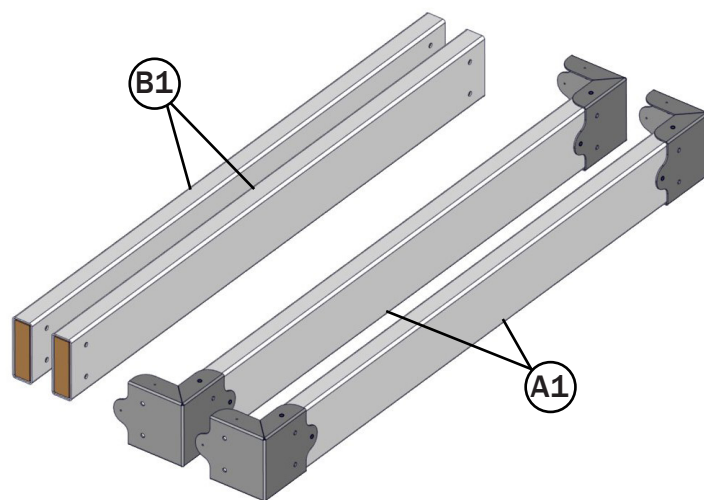

Locate and prepare the "Base Bundle" which includes...

- A1: (2) 60" 2x6 with Corner Brackets
- B1: (2) 56" 2x6

Also locate the "Tower Hardware" bag to be used until step 22.

STEP
03

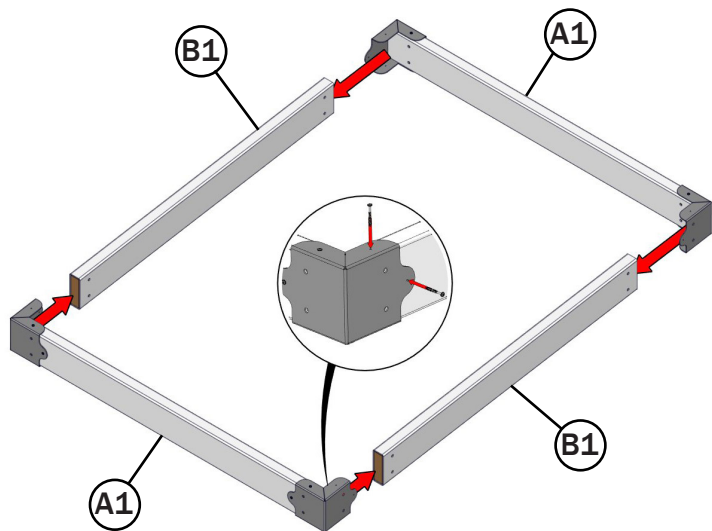

- Arrange the items so that all 2x6s fit inside the corner brackets.
- Push the 2x6s into the corner brackets. The large holes in the corner brackets should line up with the holes in the 2x6.
- Using the #2 Drive Bit, fasten the bracket to the 2x6 with (2) Washer Head Screws into the small screw holes in the bracket.
- Repeat the last 2 steps on the remaining 3 corners.

STEP
04

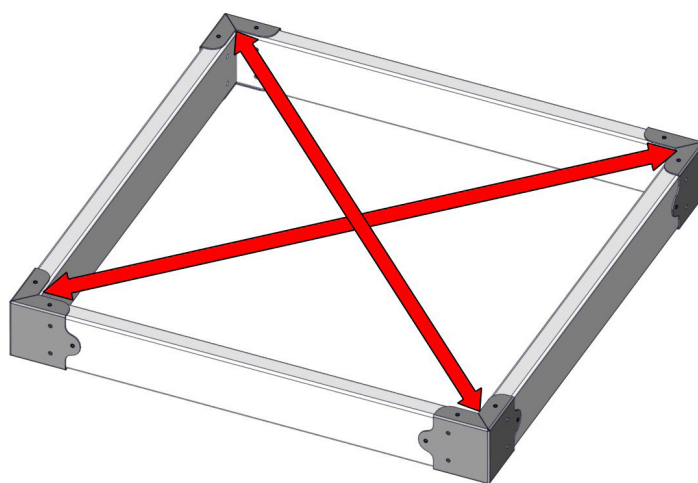

- To check if the base is square, measure from corner to corner, then measure the opposite corner to corner.
- If one corner measurement is larger than the other, then push in the corners with the larger measurement.
- Repeat until the base is as square as can be (The corner to corner measurements are equal.)

TOWER ASSEMBLY

STEP
05

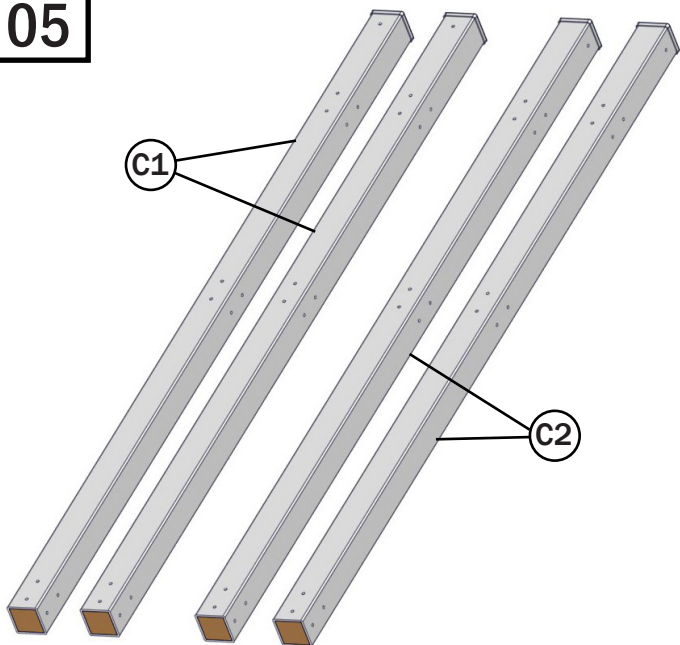

Locate the "Post Bundle 1 & 2" which includes...

- C1: (2) 105" 4x4 posts with the Roof Hole on the Left side
- C2: (2) 105" 4x4 posts with the Roof Hole on the Right side

Note the holes shown above for later reference.

STEP
06

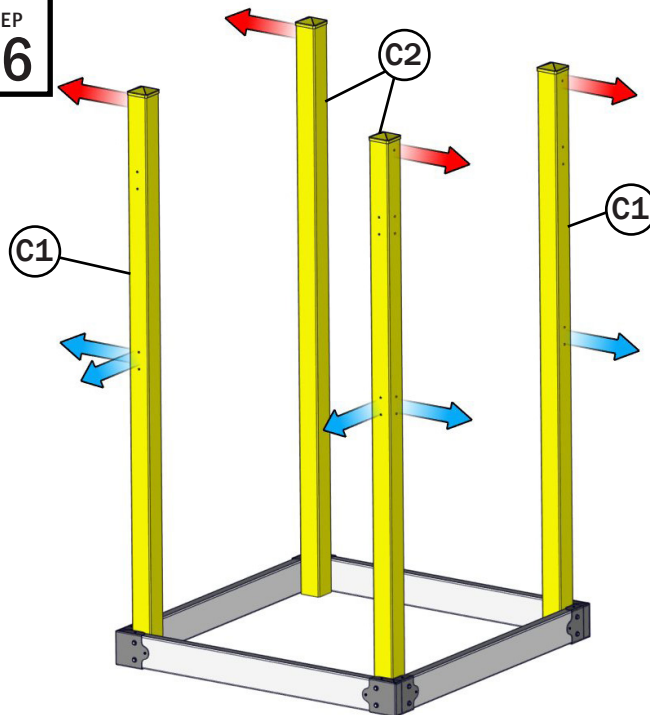

The 4x4 posts should be positioned with the following specifications.

- Each post will be oriented so the pre-drilled holes are facing outward.
- Note which side you want to be the front of the tower, the top holes should only be on the right and left sides of the tower facing outwards. (The same 4x4 post will be on opposite sides of the tower.)

You will need to place the posts 1 at a time.

STEP
07

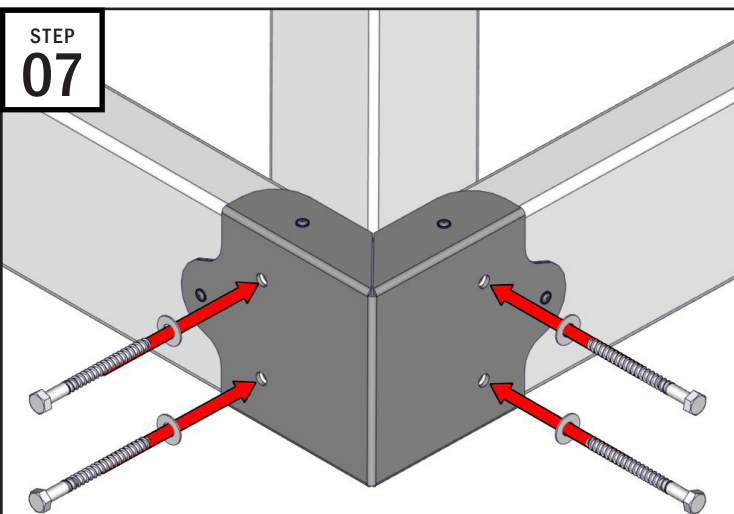

Note: DO NOT OVER-TIGHTEN. Fasten them enough so the parts touch. If the vinyl starts to dent or dimple, you know it is tight enough.

- Press the bottom of the 4x4 against the inside corner of the base.
- Fasten the 4x4 posts to the 2x6 using (4) 9/16" x 4" Lags & 3/8" Washers.
- Between fastening each Lag, use a level on the 4x4 post. You may need to push the post to get it level (It doesn't have to be perfect. The post will correct itself through future steps.)
- Repeat for the remaining 3 corners.

STEP
08

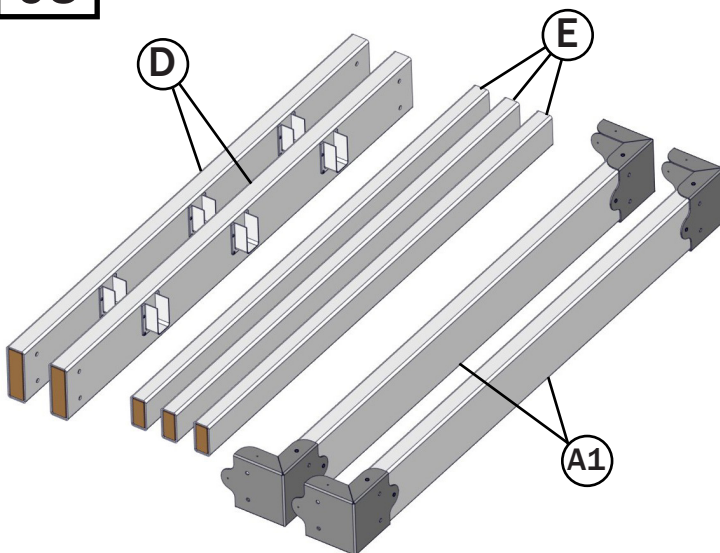

Locate and prepare the "Floor Bundle" which includes...

- A1: (2) 60" 2x6 with Corner Brackets
- D: (2) 56" 2x6 with Joist Hangers
- E: (2) 55 3/4" 2x4 Joists

TOWER ASSEMBLY

STEP
09

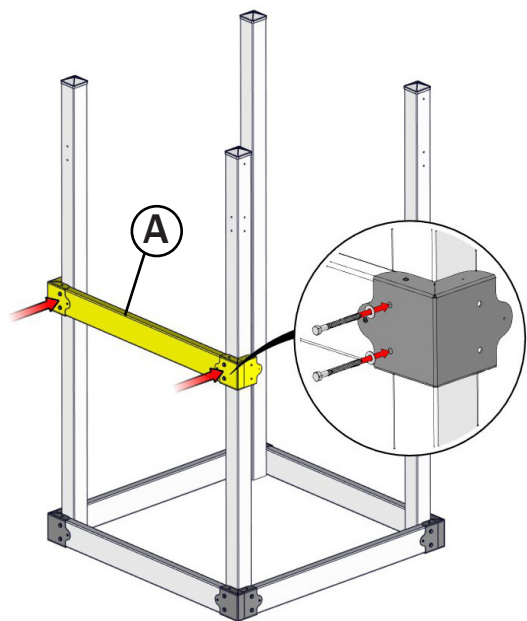

Note: DO NOT OVER-TIGHTEN. Fasten them enough so the parts touch. If the vinyl starts to dent or dimple, you know it is tight enough.

- Place one of the “A1” items on the tower.
- Using (4) 9/16” x 4” Lags & 3/8” Washers, drill into the large holes of the 2x6 so that the tip of the lags are showing on the other side.
- Use the tip of the lags to find the holes on the 4x4 post.
- Fasten the Lags into the 4x4 post.

Note: Do not fasten the side that doesn't have a 2x6 post in.

STEP
10

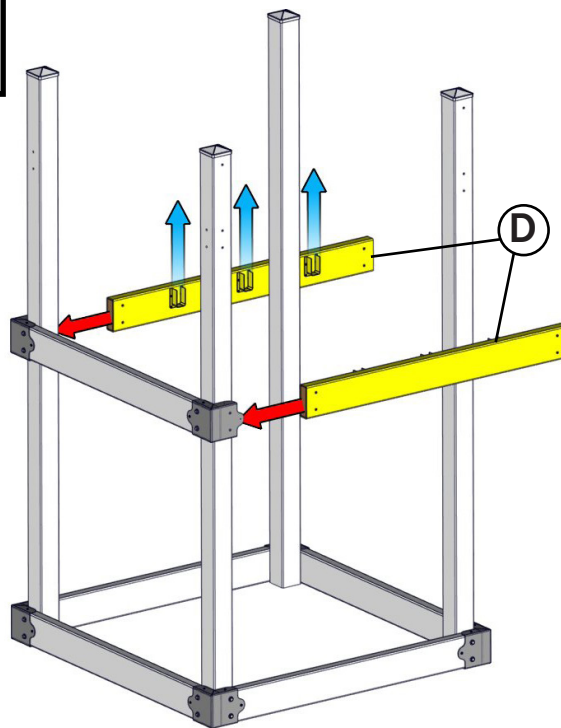

- Place both “D” items in the open ends of the corner brackets.
- Make sure the joist holders are on the inside of the tower with the joist openings are facing upwards.
- These should sit freely in the corner brackets, but you may need a 2nd person to hold them up until the next step.

STEP
11

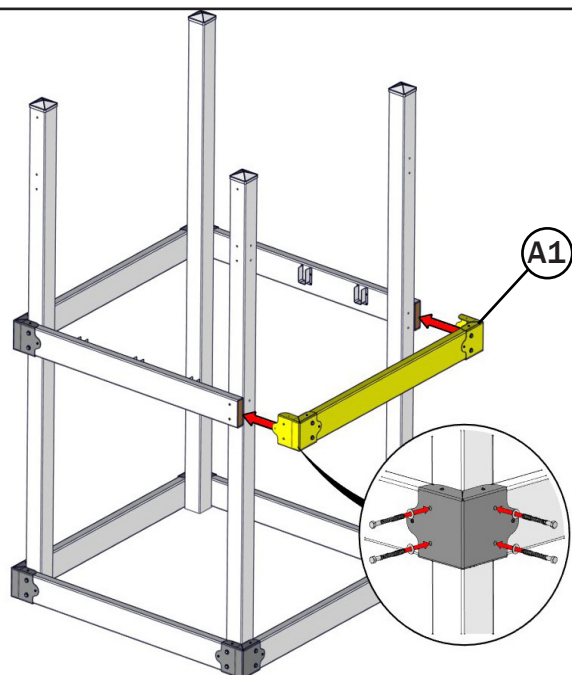

Note: DO NOT OVER-TIGHTEN. Fasten them enough so the parts touch. If the vinyl starts to dent or dimple, you know it is tight enough.

- Place the left over “A1” on the remaining side of the tower, fitting the corner brackets over the 2x6.
- Using (4) 9/16” x 4” Lags & 3/8” Washers, repeat the same fastening and alignment tips from step 9 to fasten A to the 4x4 posts.
- Finish fastening the remaining sides to the 4x4 posts.

STEP
12

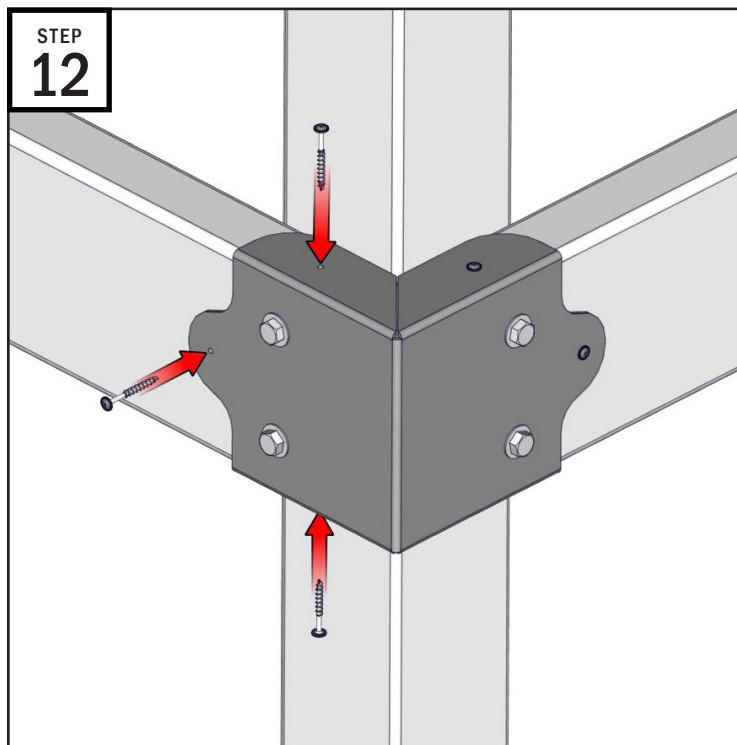

- Using the #2 Drive Bit, finish fastening the Brackets into the 2x6s with (3) Washer Head Screws (one side will already have screws).
- Repeat on the remaining 3 corners.

TOWER ASSEMBLY - FLOOR ASSEMBLY

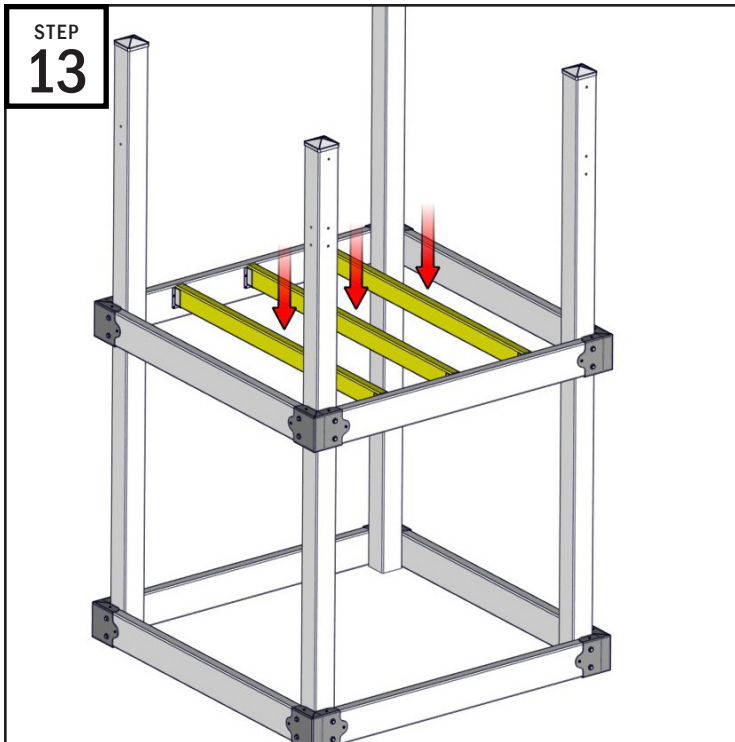

STEP
13

- You will have 3 joists remaining (E). Place these on the joist hangers.

You have now completed the main tower frame.

Continue to start the Floor Assembly

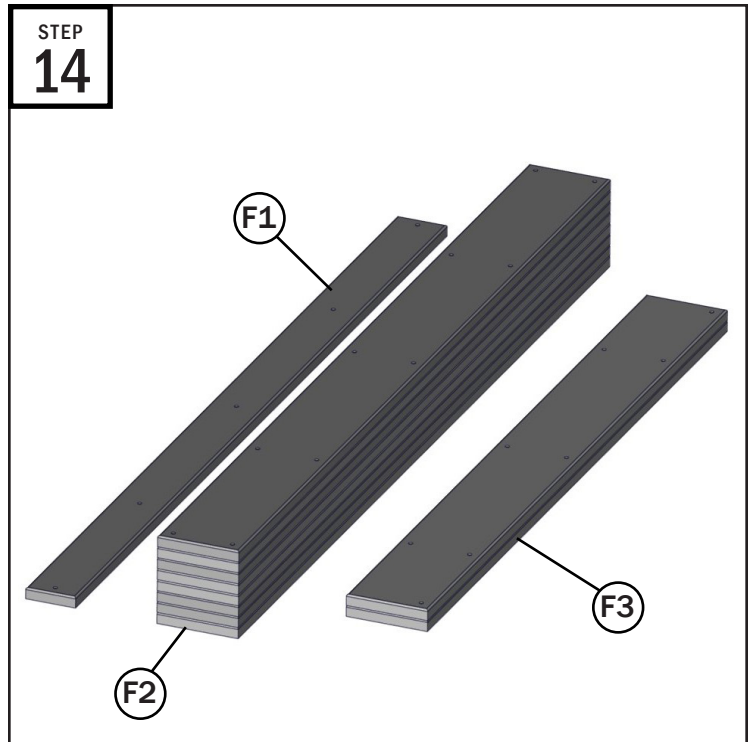

STEP
14

Locate and prepare the "Floorboard Bundle" which includes

- F1: (1) 3 3/8" x 59 1/2" Floorboard
- F2: (8) 5 1/2" x 59 1/2" Floorboard
- F3: (2) 5 1/2" x 48" Floorboard

Also locate the "Floor Hardware" bag.

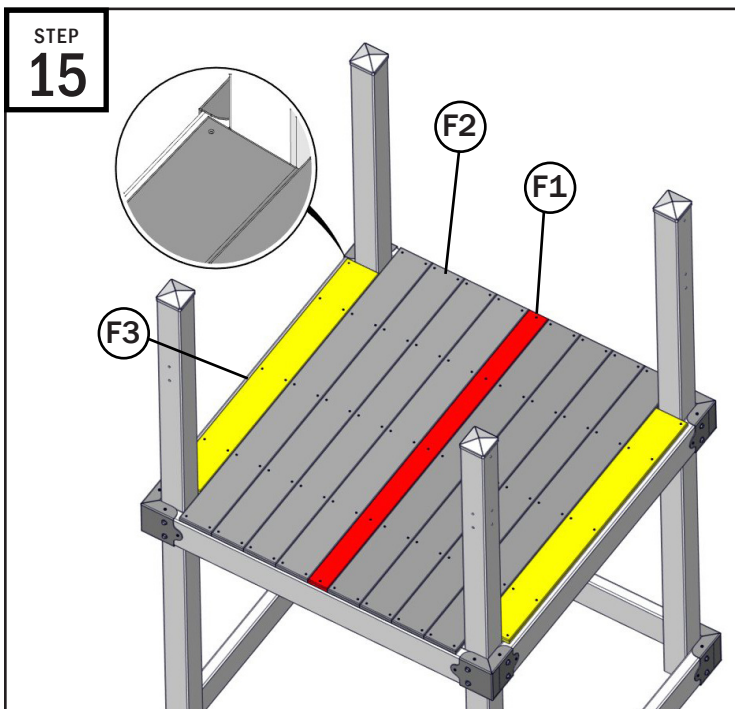

STEP
15

- Place the (8) "F2"s perpendicular from the joists below them.
- Place "F1" in the center of the tower.
- Place the (2) "F3"s on the sides. Make sure the corners with the pre-punched holes are facing outward.
- Center the floorboards. The boards are not 100% accurate. Run your fingers along both sides of the floorboards and adjust them one by one to make them as centered as possible.

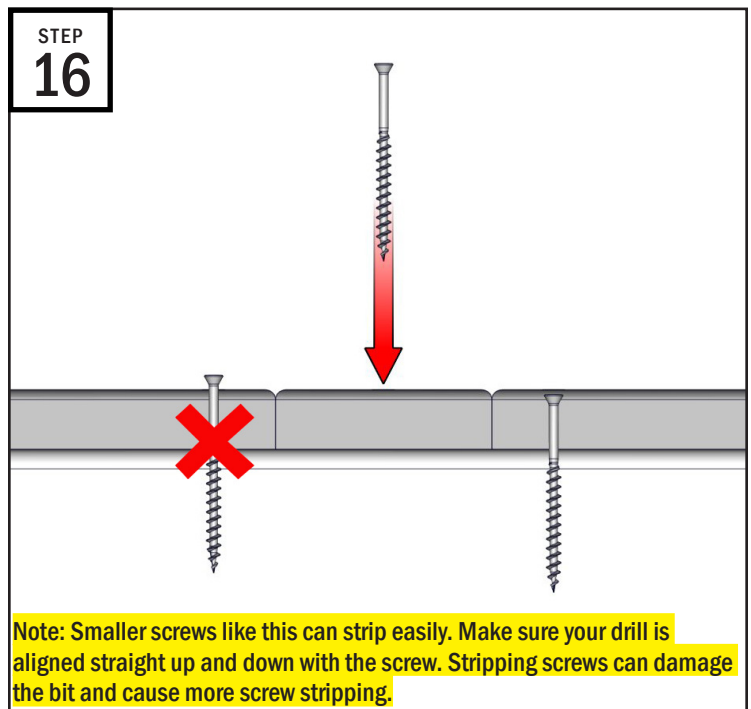

STEP
16

Note: Smaller screws like this can strip easily. Make sure your drill is aligned straight up and down with the screw. Stripping screws can damage the bit and cause more screw stripping.

- Center one of the corner "F2" boards and use the #2 Drive Bit to drill (1) Polybuster Screw into a pre-punched corner hole.
- Repeat with the neighboring "F2", adjusting to center all boards.
- Drill the remaining screws into the pre-punched holes. Each hole will line up with the joists and base boards underneath.

Note: Fasten the screws so the head of the screw is below the surface of the deck as shown above.

FLOOR ASSEMBLY - RAILING ASSEMBLY

STEP
17

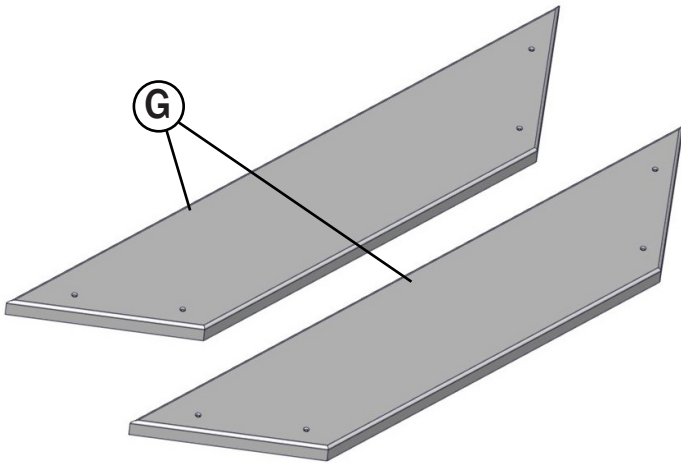

Locate the "Corner Seat Bundle". This bundle will include:

- G: (2) Poly Corner Seats

This section will also use hardware from the "Floor Hardware" bag.

STEP
18

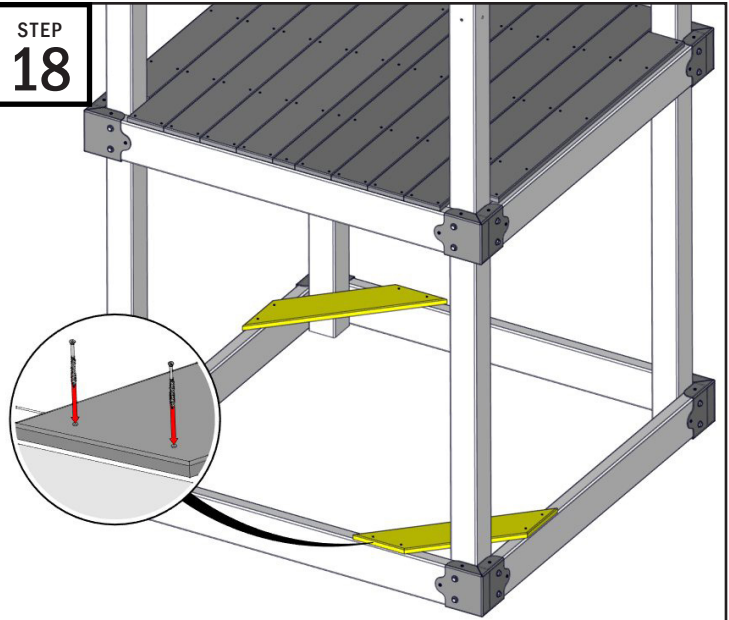

- Place "G" on the bottom 2x6s inside from the 4x4 posts. The edges of "G" will line up with the edges of the 2x6s
- Using the same method as the decking, fasten "G" to the 2x6s by drilling (4) Polybuster Screw into the pre-punched holes.
- Repeat on the other corner of the tower.

STEP
19

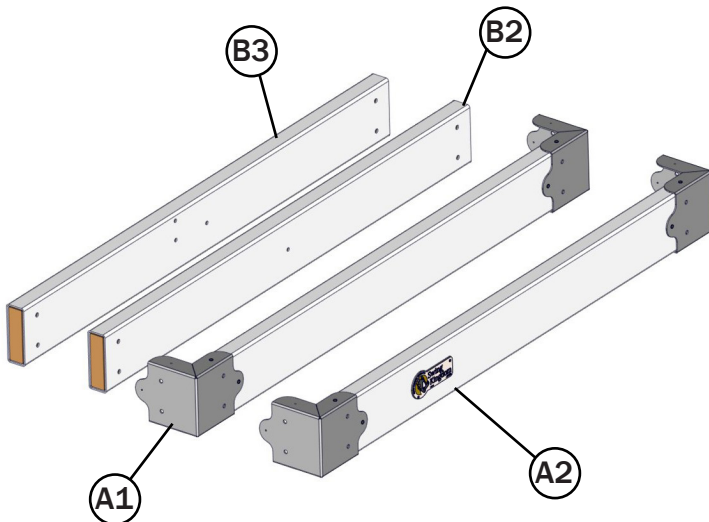

Locate the "Railing Bundle". This bundle will include:

- A1: (1) 60" 2x6 with Corner Brackets
- A2: (1) 60" 2x6 with Corner Brackets & Sequence Plaque
- B1: (1) 56" 2x6 with Roof Hole
- B2: (1) 56" 2x6 with Roof & Swing Beam Holes

STEP
20

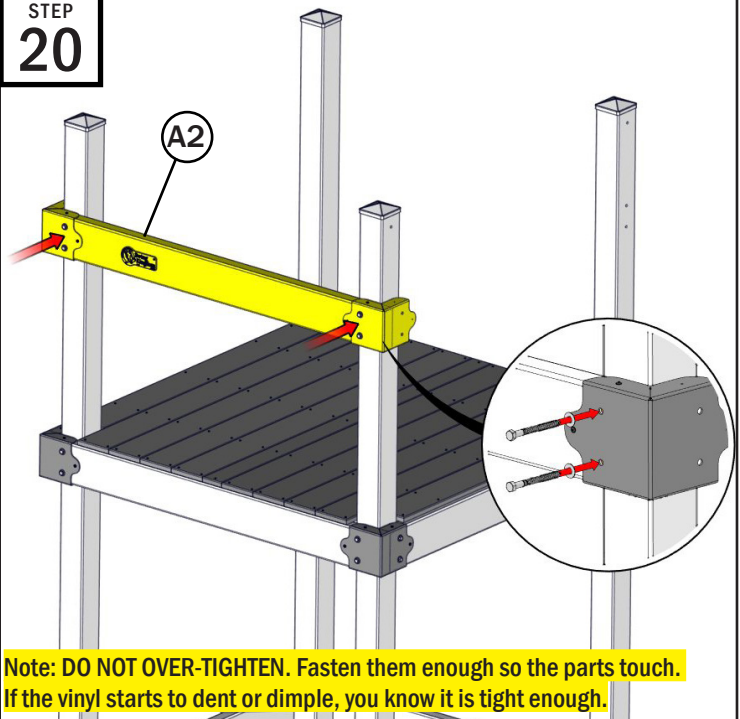

Note: DO NOT OVER-TIGHTEN. Fasten them enough so the parts touch. If the vinyl starts to dent or dimple, you know it is tight enough.

- Place "A2" on the front of the tower.
- Using (4) 9/16" x 4" Lags & 3/8" Washers, drill into the large holes of the 2x6 so that the tip of the lags are showing on the other side.
- Use the tip of the lags to find the holes on the 4x4 post.
- Fasten the Lags the into the 4x4 post.

Note: Do not fasten the side that doesn't have a 2x6 post in.

RAILING ASSEMBLY - POLY SLAT ASSEMBLY

STEP
21

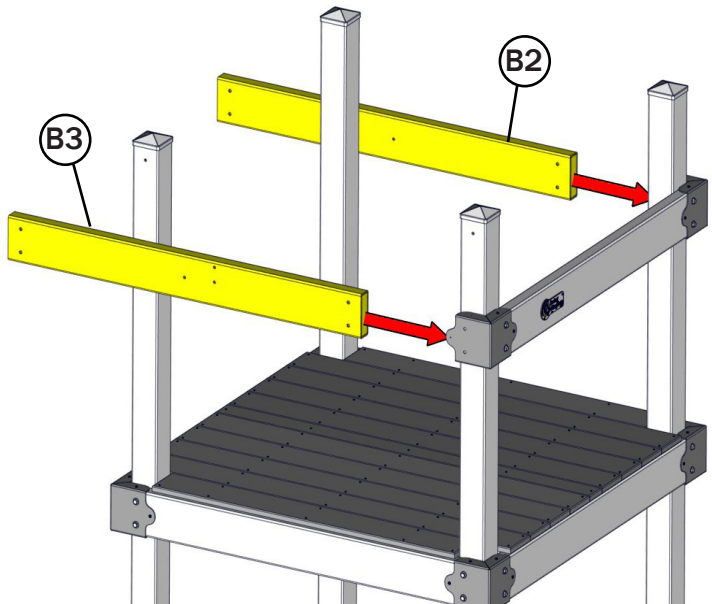

- Place both "B2" & "B3" in the open ends of the corner brackets.
- Make sure the Swing Beam holes on "B3" are towards the top & if you want to follow the diagram from step 1, place "B3" on the left side of the tower, but this is optional.
- Make sure the center hole on B2 is facing the inside of the tower.
- These should sit freely in the corner brackets, but you may need a 2nd person to hold them up until the next step.

STEP
22

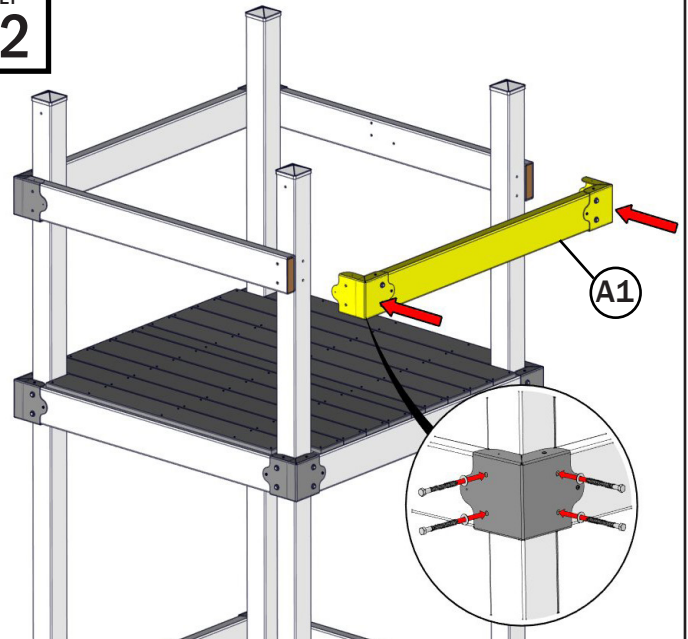

Note: DO NOT OVER-TIGHTEN. Fasten them enough so the parts touch. If the vinyl starts to dent or dimple, you know it is tight enough.

- Place the left over "A1" on the remaining side (should be the back side) of the tower, fitting the corner brackets over the 2x6.
- Using (4) 9/16" x 4" Lags & 3/8" Washers, repeat the same fastening and alignment tips from step 9 to fasten A to the 4x4 posts.
- Finish fastening the remaining sides to the 4x4 posts.

STEP
23

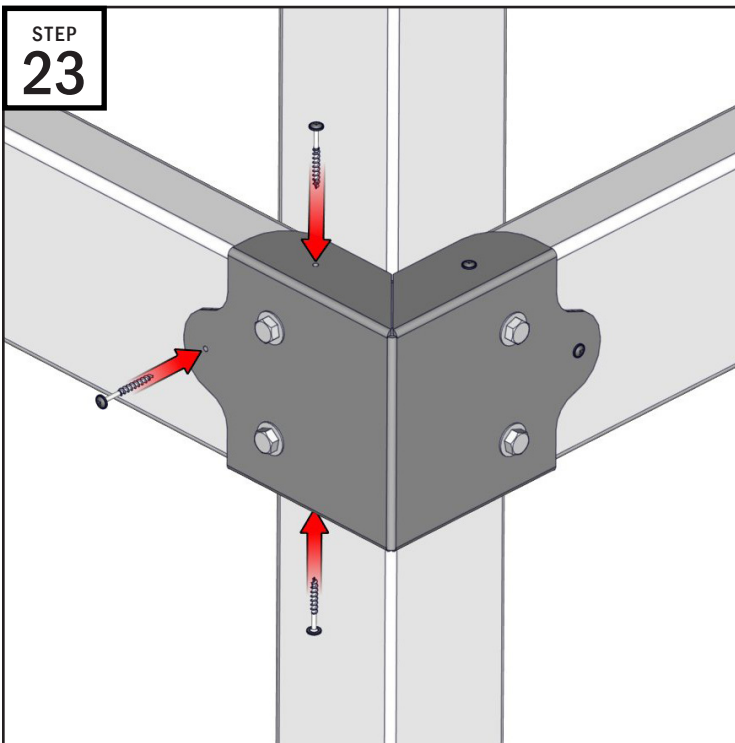

- Using the #2 Drive Bit, finish fastening the Brackets into the 2x6s with (3) Washer Head Screws (one side will already have screws).
- Repeat on the remaining 3 corners.

STEP
24

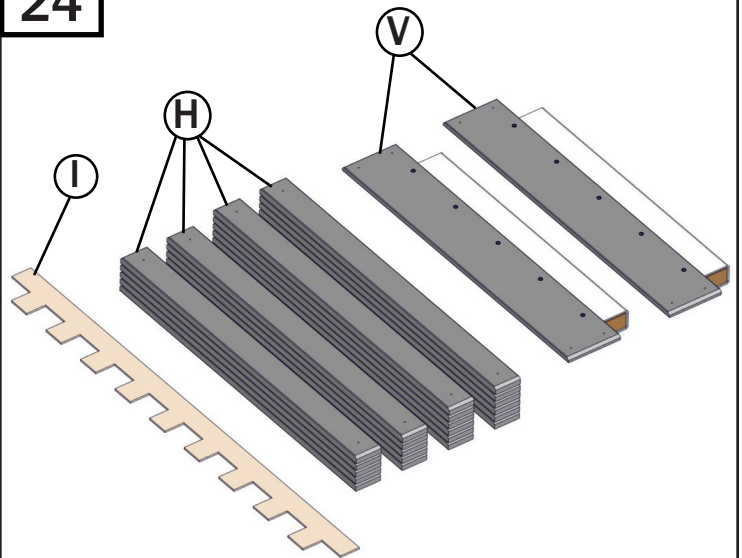

Locate the "Poly Slat Bundle". This bundle will include:

- H: (22) 3/4" x 2 5/8" x 33 3/8" Poly Slats
- I: (1) Poly Slat Template

Also locate the "Sidewinder Attachment Bundle" which includes:

- V: (2) 26 1/4" 2x6 with poly attached to it

Also locate the "Poly Slats Hardware" bag, which includes

POLY SLAT ASSEMBLY

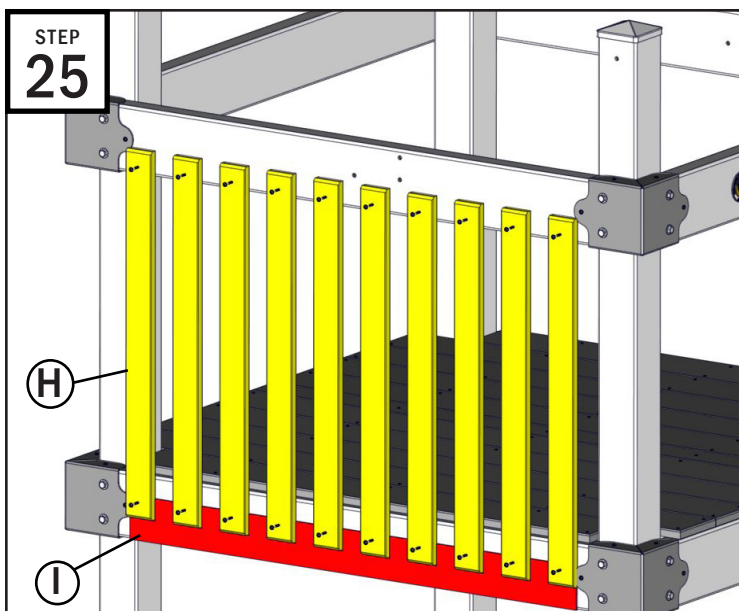

STEP
25

Note: The slats on the end will go over the corner bracket slightly. To center "I", you can measure to center or align the sides of "I" with the screws on the corner brackets.

- Use the #2 Square Drive Bit, drill 2" Washer Head Screws into "H" just enough so it is not or is barely protruding through the other side.
- On the side of the tower that has the swing holes, place "I", aligning the bottom flush with the bottom of the 2x6 board and center on the board (see note above). Have a 2nd person hold "I" or use a clamp.
- One at a time, place "H" in the groove of "I" and fasten the bottom screws into the 2x6.

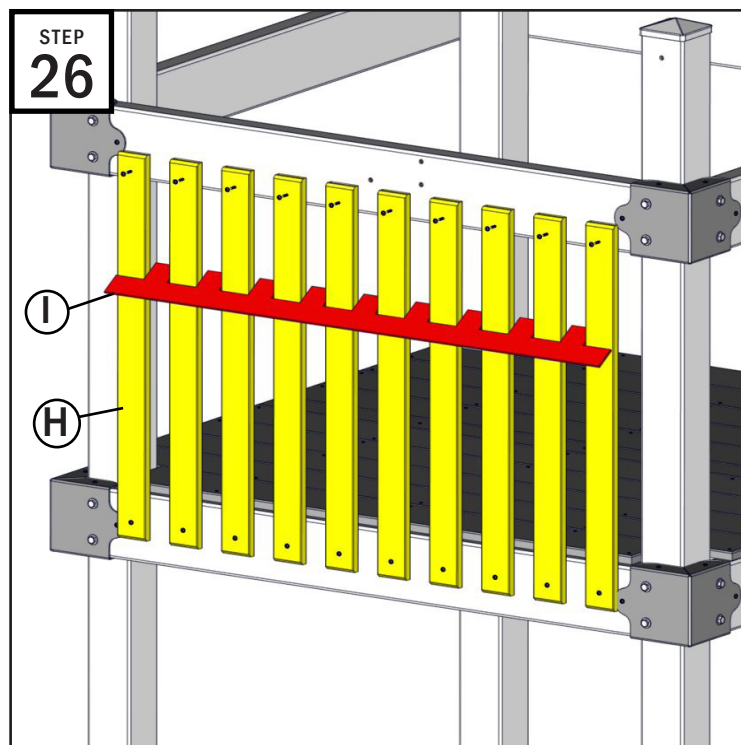

STEP
26

- Place "I" at the top of the slats holding them against the 2x6 railing.
- Use a level on the first slat to get it aligned correctly. "I" will align the rest of the slats.
- Fasten the top slats with the same hardware in the previous step.

Note: This side will 10 slats to fill up the side.

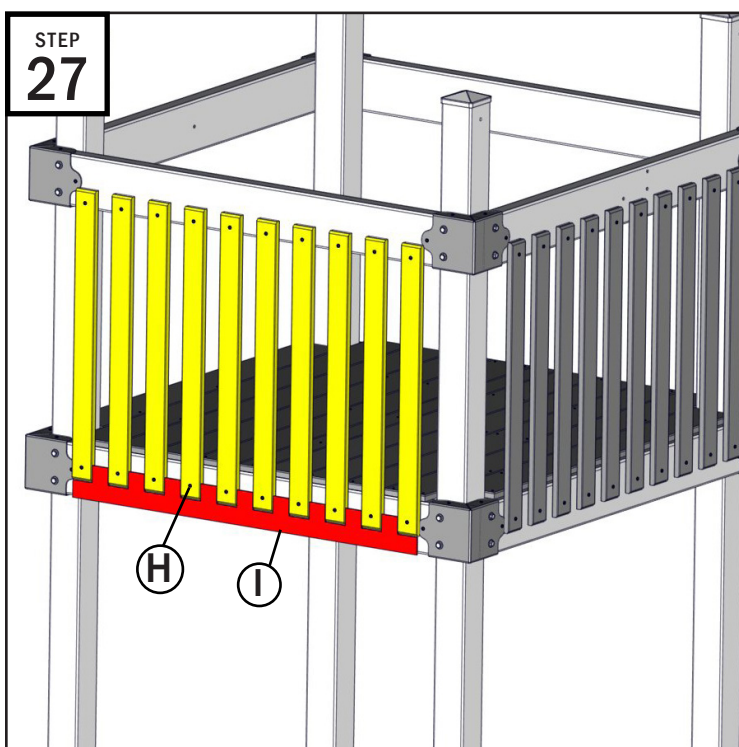

STEP
27

- Repeat the same slat and spacer process on the back of the tower with the same amount of slats.

Note: This side will have 10 slats.

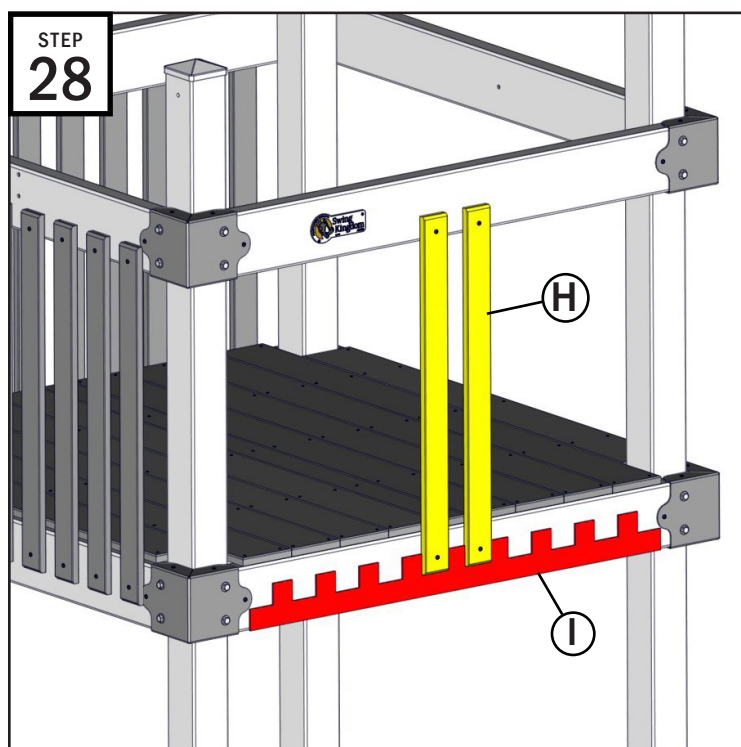

STEP
28

- Repeat the same slat and spacer process on the back of the tower.

Note: Only use 2 slats (in the center) on the front to leave access to the slide.

POLY SLAT ASSEMBLY - LADDER ASSEMBLY

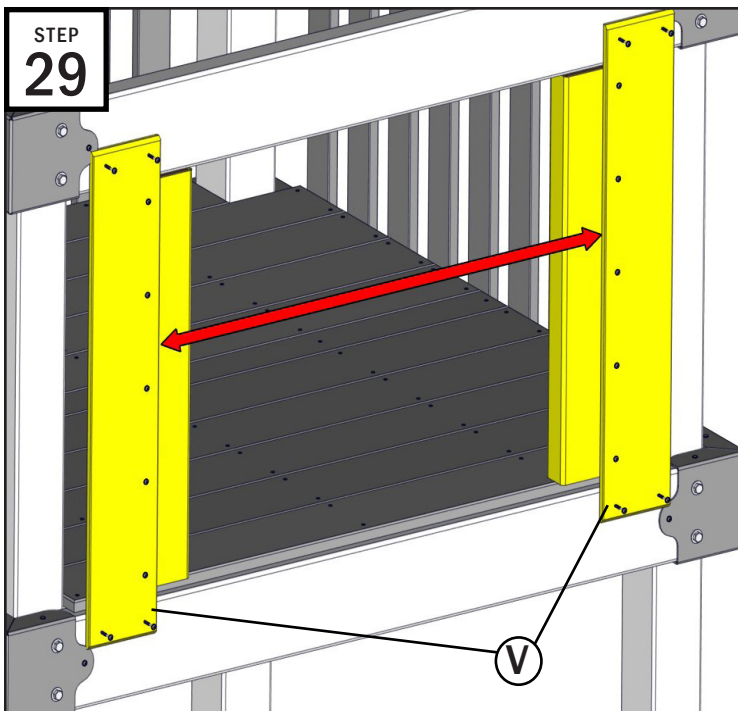

STEP
29

- Place "V" on the other remaining side (the side with a roof hole on the inside of the 2x6 railing). The 2x6 of "V" will sit between the railing & the floor with the poly on the outside of the tower.
- You will need at least 36" of space between the poly sections. You can measure 36 1/4" from edge to edge or you can open the Sidewinder slide box and get the entry plate to help measure the correct distance.
- Center these and use the same poly slat method to fasten these.



STEP
30

Locate the following items:

- Ladder
- Ladder Handrail (which includes handrail hardware)

Also locate the "Accessories Hardware" bag (this hardware bag will be used again later in the assembly).

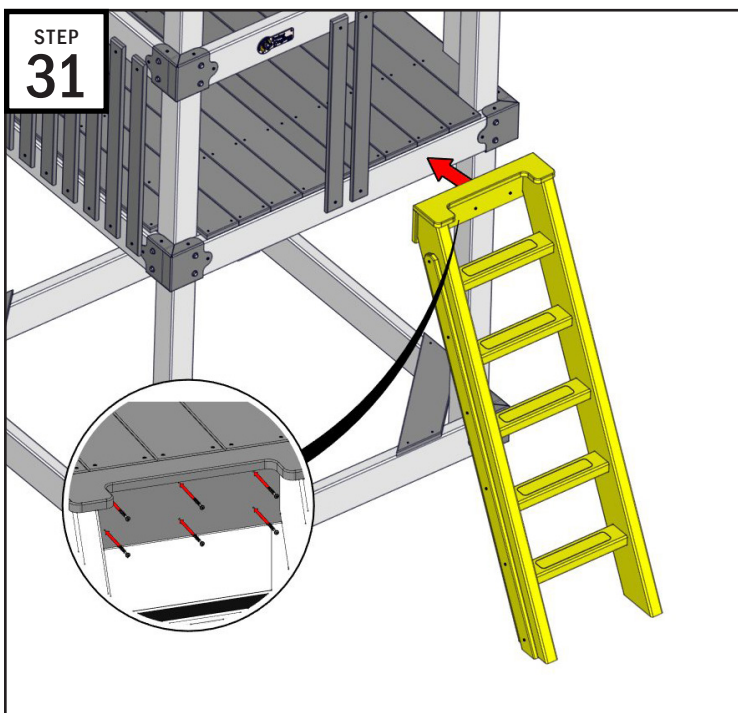

STEP
31

- Place the Ladder on the front right of the tower with the bottom of the Ladder touching on the ground and the top of the ladder aligned with the Tower Deck, between the poly slat and the 4x4 post.
- 1 person may need to support the ladder.
- Using the 2 Square Drive Bit, drill (6) 2" Washer Head Screws through the pre-punched holes on the ladder into the tower 2x6.

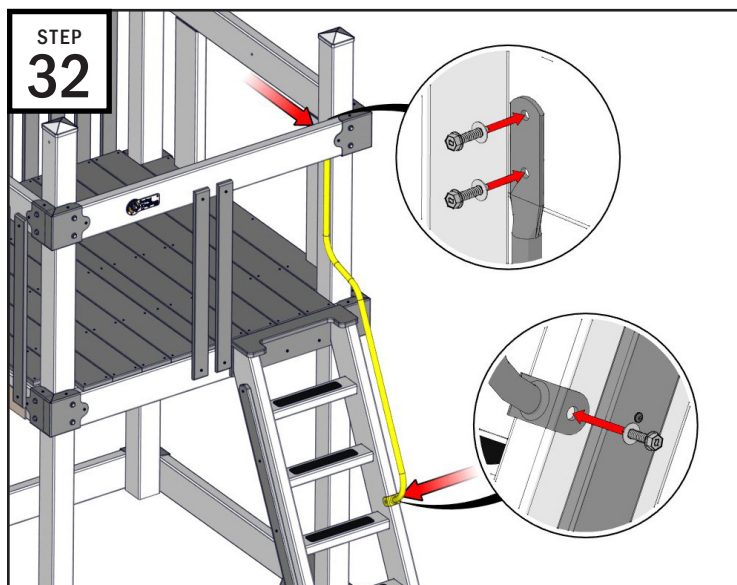

STEP
32

Note: DO NOT OVER-TIGHTEN. Fasten them enough so the parts touch. If the vinyl starts to dent or dimple, you know it is tight enough.

- Decide which side you want the handrail (right side in image).
- Place the channel of the handrail around the ladder side of your choosing with the top of the handrail on the inside of the tower railing.
- Using (2) 1/2" x 1 1/2" Lags & 5/16" Washers, fasten the top of the handrail into the tower railing. There are no pre-drilled holes, so you will need to carefully pierce the Vinyl with the 1 1/2" Lags. Use some force & keep the screw and drill aligned with each other.
- Using (1) 1/2" x 1 1/2" Lags and 5/16" Washer, fasten the handrail channel through the outer edge of the ladder.

SWING FRAME ASSEMBLY

STEP
33

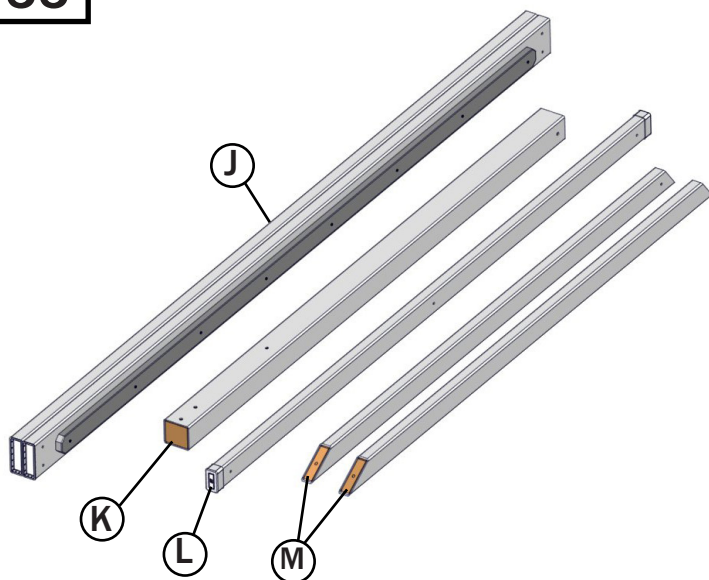

Locate the "Swing Beam" & "Swing Frame" Bundles, which will include:

- J: (1) 126" Swing Beam (The only item in the Swing Beam Bundle.)
- K: (1) 92" 4x4 Post
- L: (1) 106" 2x4 Ground Runner
- M: (2) 89" 2x4 Brace

Also locate the "Swing Frame" & "Swing Hook" Hardware bags.

STEP
34

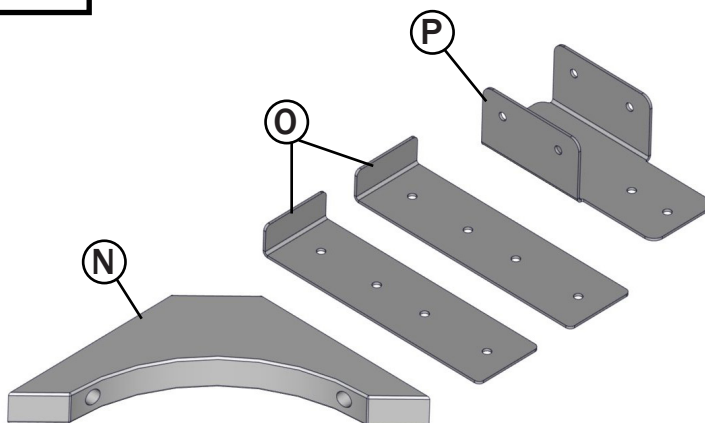

You will also want to locate the "Swing Support Bundle" which includes:

- N: (1) Poly Brace
- O: (2) Swing Beam Post Plate
- P: (1) Swing Beam Bracket

Note: these will be located in the hardware box.

STEP
35

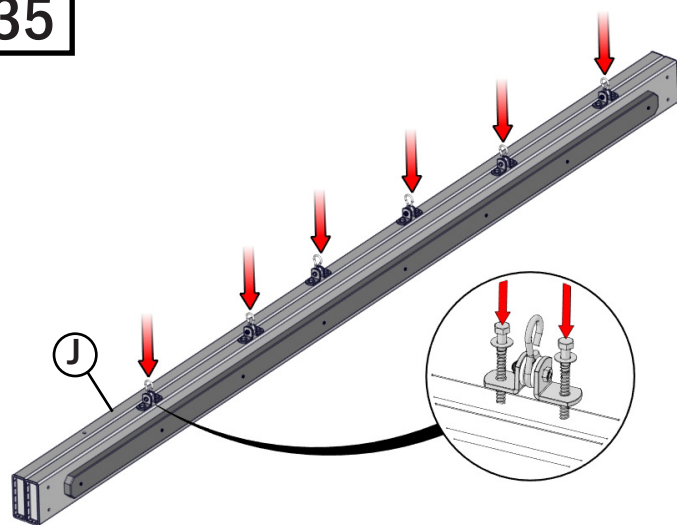

- Place "J" down on the ground with the holes facing upwards.
- Open the "Swing Hook Hardware" bag.
- Place the swing bearings aligning them with the pre-drilled double holes. Ignore the single hole towards one of the ends for now.
- Fasten the bearings using (12) 9/16" x 4" Lag (2 per bearing).

STEP
36

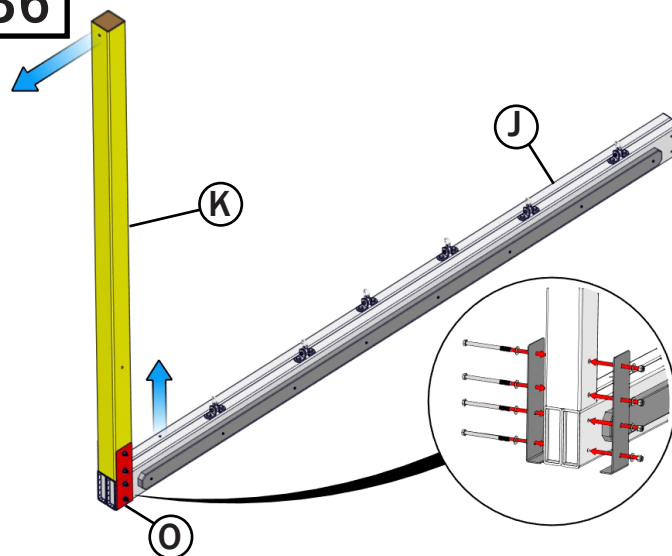

Note: DO NOT OVER-TIGHTEN. Fasten them enough so the parts touch. If the vinyl starts to dent or dimple, you know it is tight enough.

- Place "K" on top of "J" on the side of the single hole. "K" has a hole on one end that is centered. Make sure that hole is on the opposite and is facing away from "J"
- Place both "O"s on each side of "K" & "J" aligning the holes as shown with the short end of "O" going underneath "J".
- Fasten them together using (4) 9/16" x 5" Bolts, (8) 3/8" Washers and (4) 9/16" Locking Nuts.

SWING FRAME ASSEMBLY

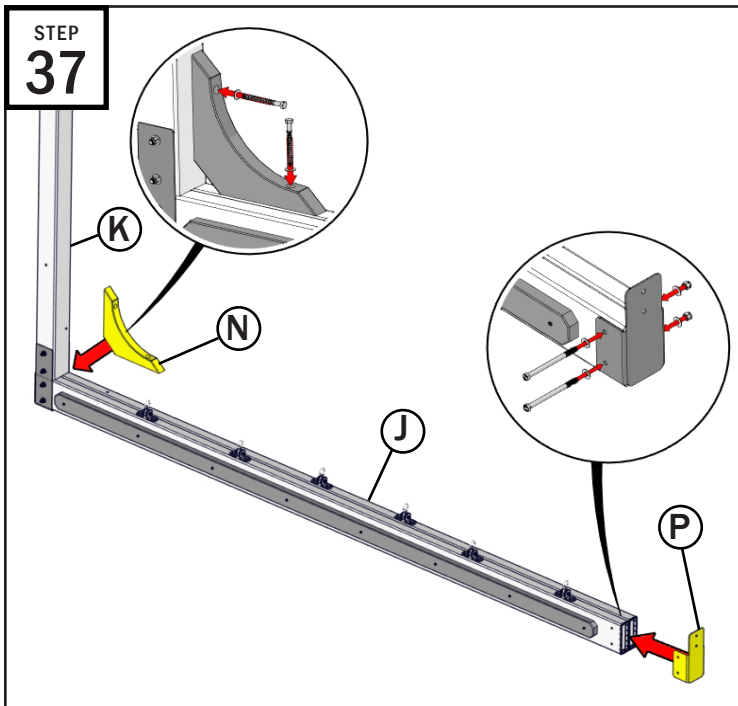

- Place "N" in the corner between "K" & "J" aligning the holes of "S" with the single holes on "K" & "J".
- Fasten "N" using (2) 9/16" x 4" Lags & 3/8" Washers.
- Slide "P" on the other side of "J" aligning the side holes on both. Make sure the straight section on "P" faces upwards.
- Fasten "P" to "J" using (2) 9/16" x 5" Bolts, (4) 3/8" Washers and (2) 9/16" Locking Nuts.

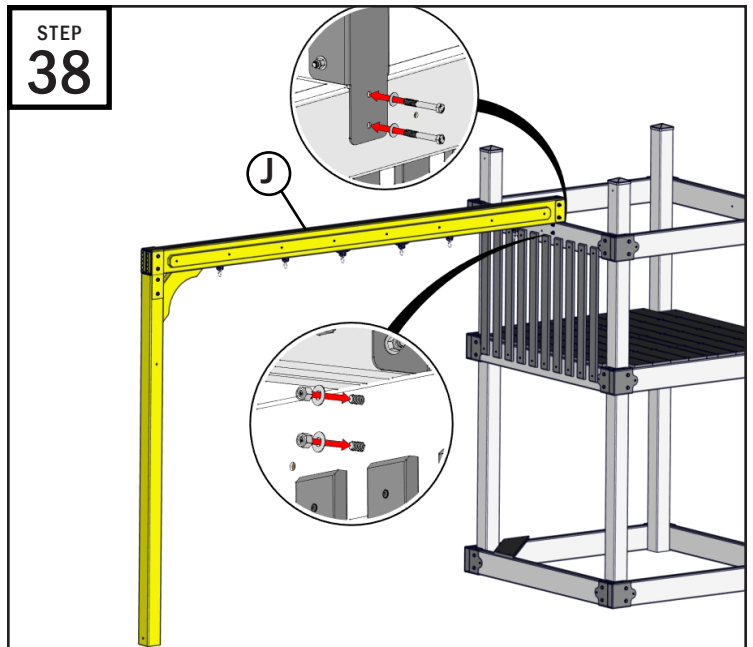

Note: DO NOT OVER-TIGHTEN. Fasten them enough so the parts touch. If the vinyl starts to dent or dimple, you know it is tight enough.

- Flip the Swing Frame upright and rest the unsupported end of "J" on the railing of the tower with the bracket on the inside of the tower.
- Align the holes on the bracket with the holes on the 2x6 Railing.
- Fasten them together using (2) 9/16" x 2 3/4" Bolts, (4) 3/8" Washers and (2) 9/16" Locking Nuts.

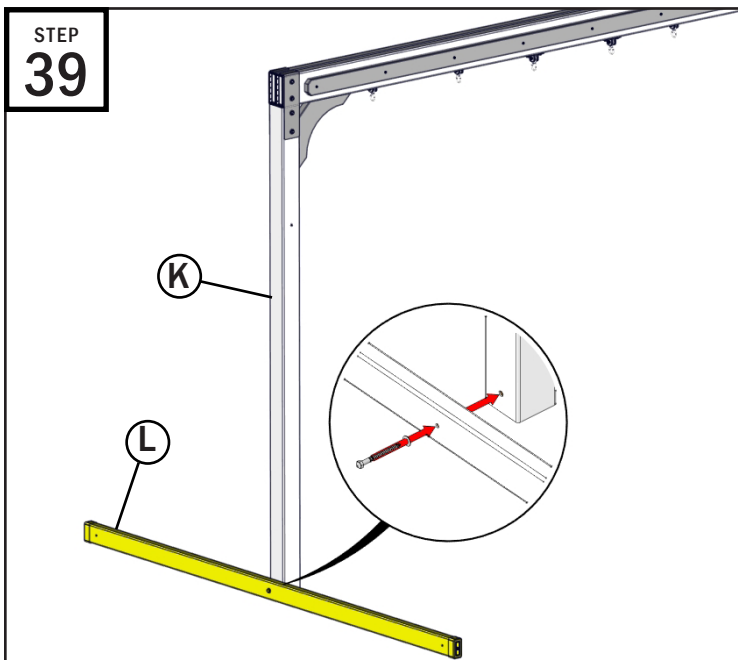

Note: DO NOT OVER-TIGHTEN. Fasten them enough so the parts touch. If the vinyl starts to dent or dimple, you know it is tight enough.

- Place "L" on the ground on the outside of "K".
- Align the center hole on "L" with the hole at the bottom of the "K".
- Fasten together using (1) 9/16" x 4" Lags & 3/8" Washers.

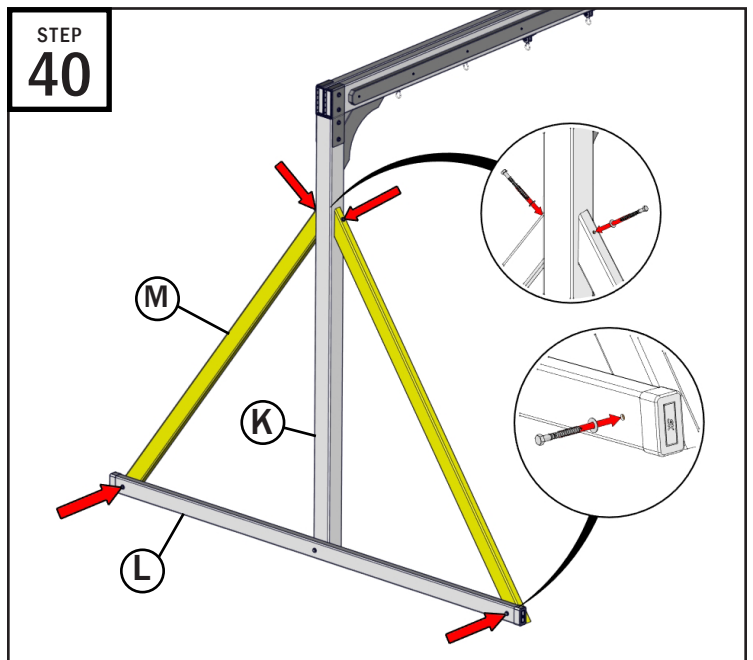

Note: DO NOT OVER-TIGHTEN. Fasten them enough so the parts touch. If the vinyl starts to dent or dimple, you know it is tight enough.

- Place the (2) "M" braces on both side of the "K". Align the pre-drilled holes. You may need to flip the ends if the holes don't line up.
- Fasten the top of "M" to the 4x4 Post using (2) 9/16" x 4" Lags & 3/8" Washers.
- Fasten the bottom of "M" ends to the "L" 2x4 using (2) 9/16" x 3" Lags & 3/8" Washers.

ROOF ASSEMBLY

STEP
41

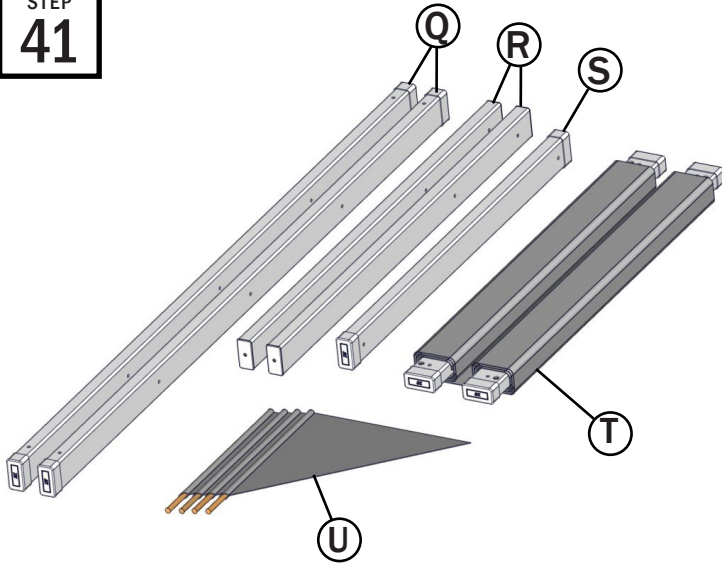

Locate the "Roof Bundle 1 & 2" witch includes:

- Q: (2) 120" Roof 2x4 Railing
- R: (2) 63 5/8" 2x4 Vertical
- S: (1) 59 1/2" 2x4 Horizontal
- T: (1) Canvas Roof with (2) 60 1/2" 2x4 Horizontal
- U: (4) Flags

Also locate the "Roof Hardware" bag.

STEP
42

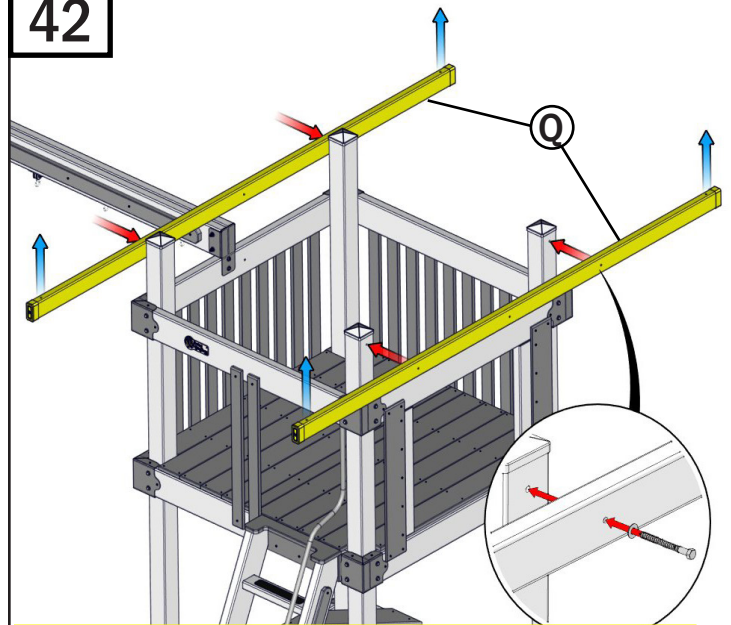

Note: DO NOT OVER-TIGHTEN. Fasten them enough so the parts touch. If the vinyl starts to dent or dimple, you know it is tight enough.

- Place the (2) "Q"s on either side of the playset and align the pre-drilled holes with the top holes on the 4x4 posts.
- "Q" have 4 extra holes on one side, these holes need to be facing up as shown by the blue arrows above.
- Fasten these using (4) 9/16" x 4" Lags & 3/8" Washers (2 each side).

STEP
43

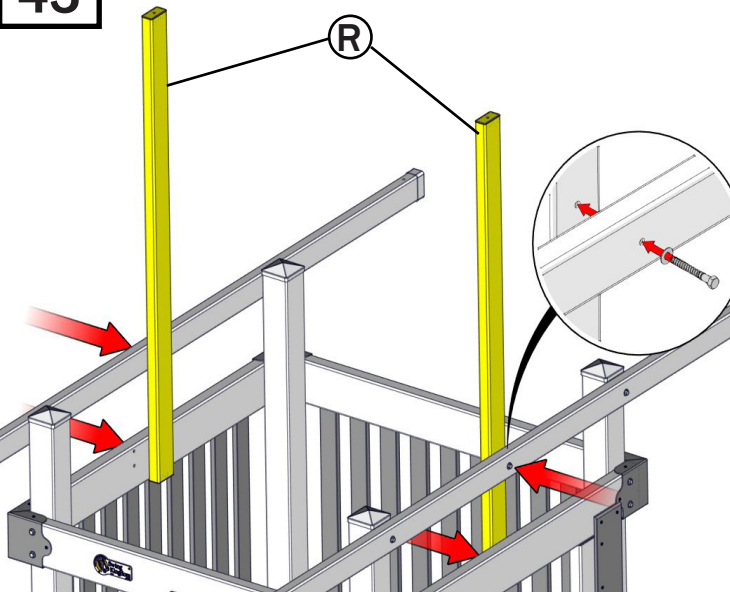

Note: You may want to assemble S & R on the ground, following step 44 if you don't think you will be able to reach the fastening section on step 44.

- Place "R" on the inside of the railings. "R" has 2 holes on the side towards the bottom and 1 hole on the very top of it. Make sure the top hole is facing upwards.
- Align the holes on "R" with the center holes on both railings.
- Fasten using (4) 9/16" x 3" Lags & 3/8" Washers (2 each side).

STEP
44

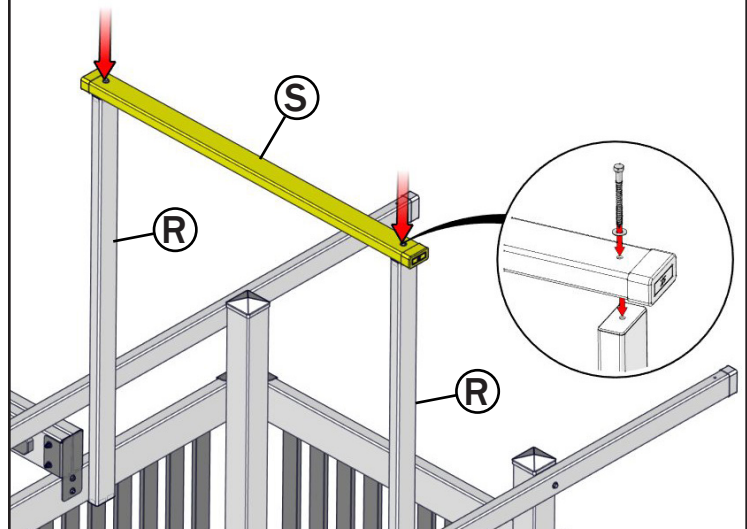

Note: DO NOT OVER-TIGHTEN. Fasten them enough so the parts touch. If the vinyl starts to dent or dimple, you know it is tight enough.

- Place "S" on top of the 2 "R"s.
- Align the holes towards the end of "S" with the holes on the top of "R".
- Fasten using (2) 9/16" x 4" Lags & 3/8" Washers.

ROOF ASSEMBLY - ACCESSORY INSTALL

STEP
45

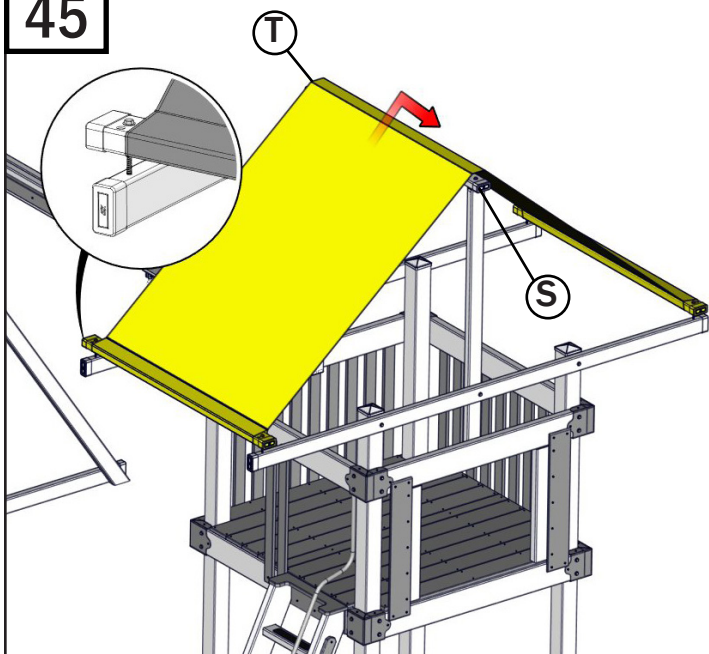

- Place one of the “T” boards on one of the ends of the long railings. Make sure larger holes on “T” are facing upwards.
- Using (2) 9/16” x 4” Lags & 3/8” Washers, drill into the smaller “T” holes and drill into the railing end holes enough so that “T” stays in place like the detail view above.
- Drape the “T” Canvas over “S”.
- Place the other “T” board on the other end of the long railings.

STEP
46

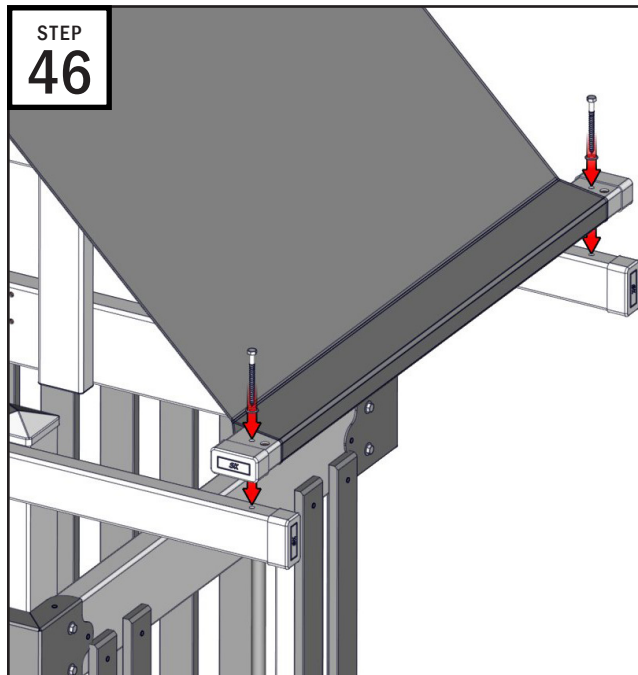

Note: DO NOT OVER-TIGHTEN. Fasten them enough so the parts touch. If the vinyl starts to dent or dimple, you know it is tight enough.

- Align the holes on the other side of the roof.
- Fasten using (2) 9/16” x 4” Lags & 3/8” Washers.
- Finish fastening the 2 Lags used to hold the original “T” board from the previous step.

Note: This step will help tighten the canvas, so keep an eye on the canvas during this step.

STEP
47

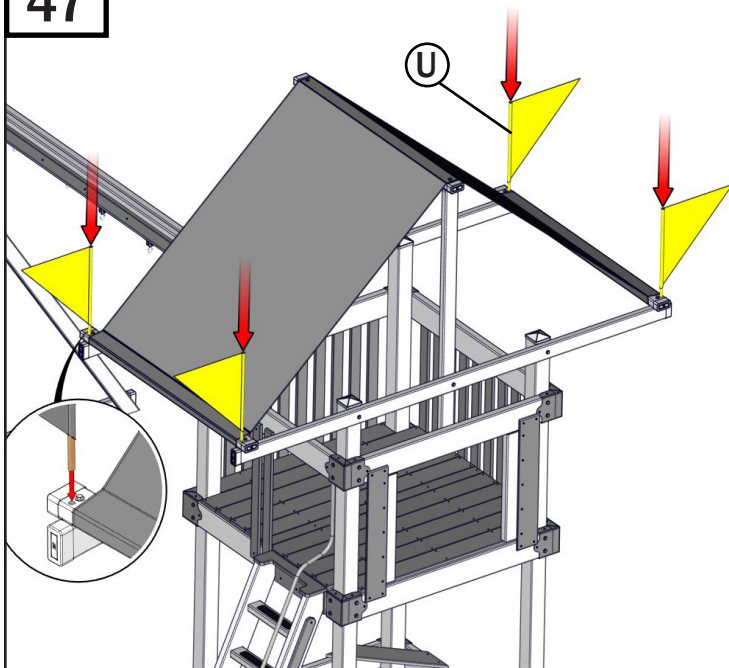

- The boards on the ends of the canvas will have larger holes.
- Place the (4) “U” Flags in each of them.

STEP
48

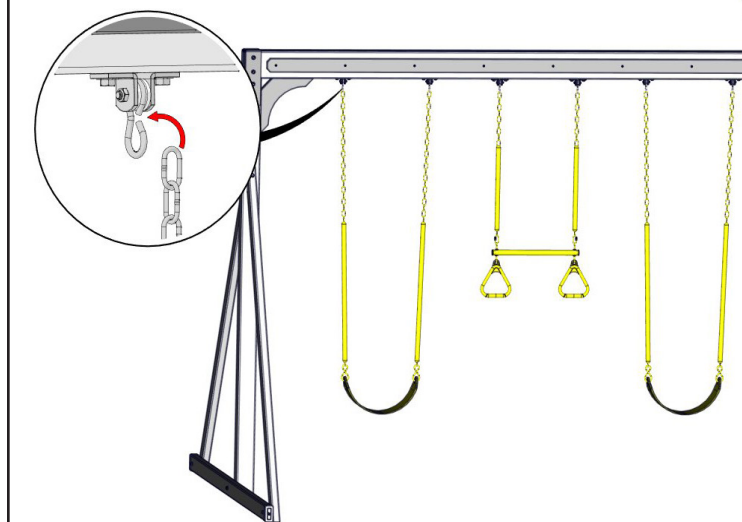

Locate the (2) Belt Swings and the Trapeze.

- Hang the Belt Swings from the Swing Hooks on the Swing Beam.
- There will be excess chain to adjust the height of the swing to the appropriate height.

ACCESSORY INSTALL - STAKE INSTALL

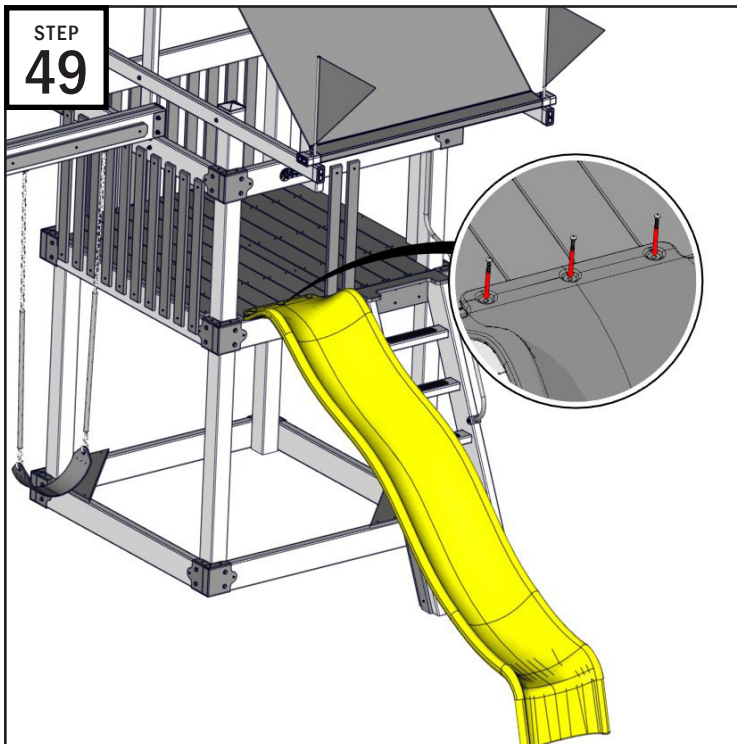

STEP
49

Locate the Waterfall Slide and the "Slide Hardware"

- Place the Waterfall Slide on the front left of the tower.
- Position the Waterfall Slide so the holes are directly above the 2x6.
- Fasten the Slide with (3) 1/4" x 1 1/4" Pan Head Screws and (3) 5/16" Washers. (Use the #2 Square Drive Bit to fasten these screws.)

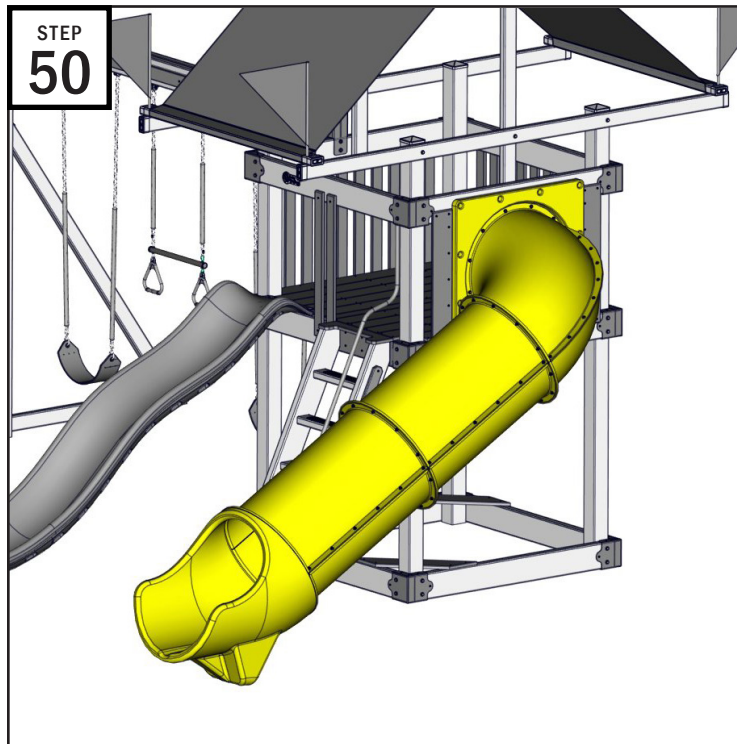

STEP
50

- Open the Sidewinder Slide box, which will include the hardware.
- There will be an instruction manual inside the box for the slide. Follow these instructions.

Note the orientation of the slide in the picture above. The Sidewinder Assembly Manual might show the slide facing the opposite direction.

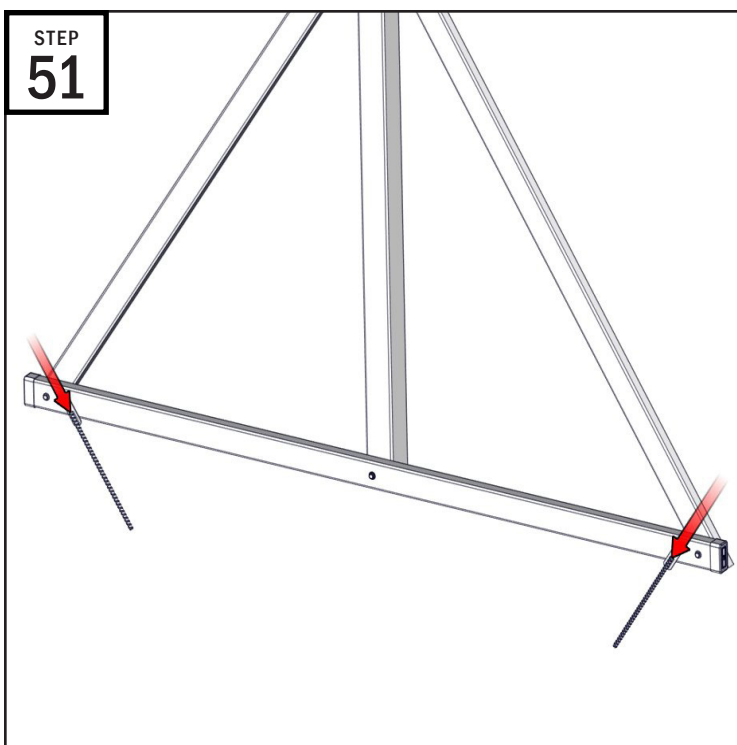

STEP
51

Locate the "Stake Bundle". This bundle will include:

- (2) Stakes
- (2) 1/2" x 1 1/2" Lags
- (2) 5/16" Washers

Using a hammer, drive a Stake into the ground at 45° (perpendicular to the braces) near the ends of the ground 2x4 of the Swing Frame.

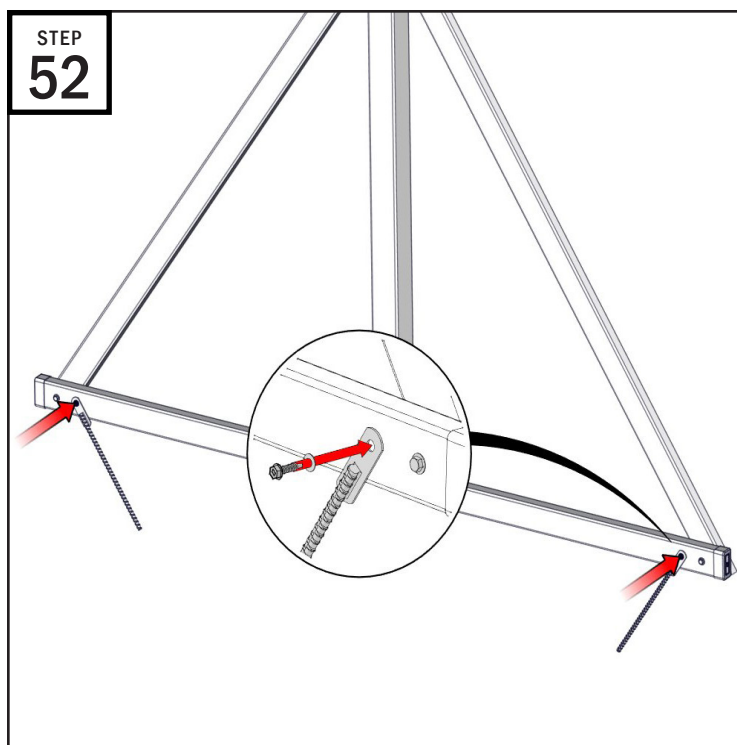

STEP
52

- Fasten the stakes to the Swing Beam using (2) 1/2" x 1 1/2" Lags and (2) 5/16" Washers.

The playset is now complete. Sometimes the vinyl will rub against itself in shipping. If you notice any marks, use Windex and a rag or steel wool to clean. Do not overuse steel wool as it can permanently scratch the playset.

COMPLETED PLAYSETS

Basecamp 55 shown in Almond & Green



Basecamp 55 shown in White & Gray

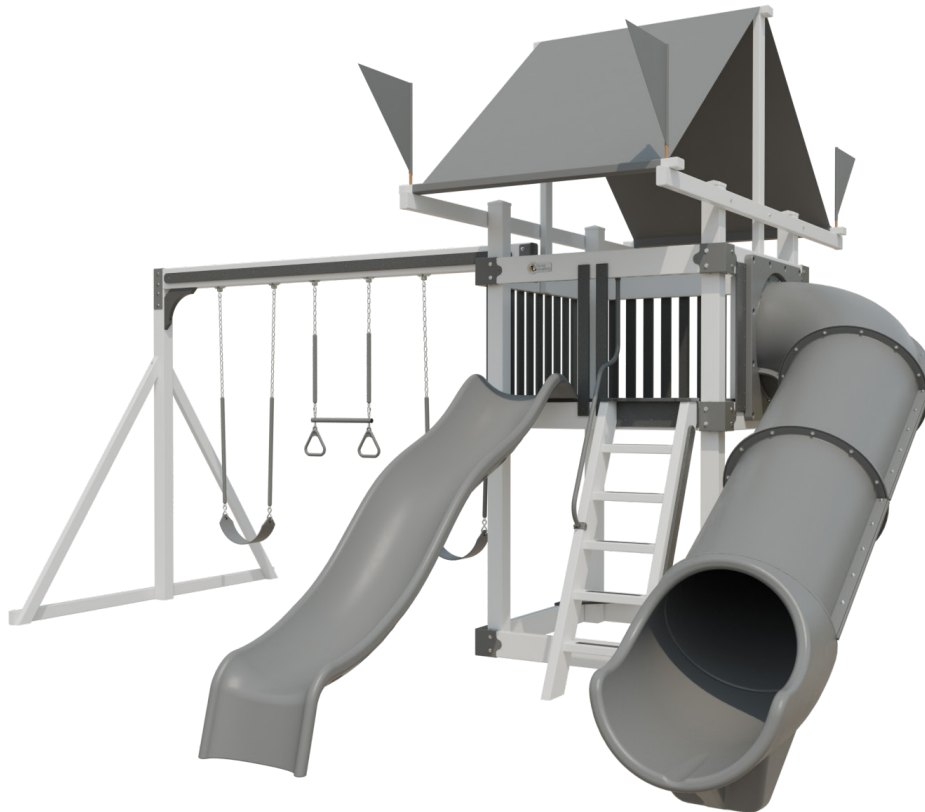



Swing Kingdom

MIGHTY PLAYSETS. SERIOUS FUN.

Technical Issues?

Contact us at:

Support@swingkingdom.com

717-656-4449