

**MOUNTAINEER SERIES**

# MEGA CLIMBER 55

MC 55RTG0

Assembly Manual



Recommended People: 3

Assembly Time: 4-5 hours



**Swing Kingdom**

[www.swingkingdom.com](http://www.swingkingdom.com)

# CONTENTS

Safety Info .....	4
Parts List .....	5
Part Drawings .....	6
Hardware .....	9
Leg Assembly .....	10
Tower Assembly.....	11
Floor Assembly .....	18
Handrail Install .....	18
Rock Wall Assembly.....	19
Cargo Net Assembly.....	21
Extension Tower Assembly.....	23
Swing Frame Assembly .....	26
Roof Assembly (1).....	28
Poly Slat Assembly .....	30
Roof Assembly (2).....	32
Accessory Install .....	34
Stake Install.....	36

## TOOLS INCLUDED FOR ASSEMBLY

- #2 Square Drive Bit
- Slat Spacer

## TOOLS REQUIRED FOR ASSEMBLY

- Impact Drill
- Socket Attachment
- 1/2" Socket
- 9/16" Socket
- Step Ladder
- Tape Measure
- Safety Glasses
- Level (Recommended)
- 9/16" Wrench
- Hammer
- Knife or Box Cutter

# ABOUT US

For loads of fun and family time, count on Swing Kingdom. A family operated manufacturer of premier vinyl playsets, we strive to design and build fine quality, affordable playsets perfect for children of all ages.

From the 500 square foot building where we started our business in 2000, to our current 43,000 square foot facility, Swing Kingdom has expanded to meet the growing demand for high quality, virtually maintenance-free playsets. We were the first manufacturer to combine vinyl PVC and structural wood, along with stainless steel hardware for superior strength. Today, we continue to use only the finest quality materials to ensure safe, durable playsets built to offer years of enjoyment.

Our playsets are loaded with activities that will spark every child's imagination and encourage daily physical activity and never-ending fun!

# SUPPORT

[Support@SwingKingdom.com](mailto:Support@SwingKingdom.com)

717-656-4449

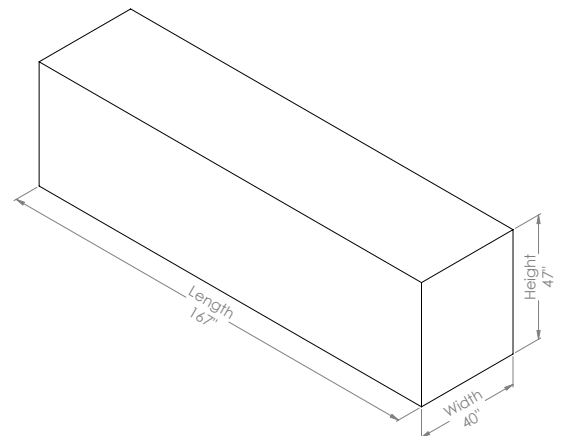

Skid Dimensions:

Package: 167" Length x 40" Width x 47" Height

Package Weight: 2,010 lbs

Version: 1.1

Last Updated: April 15, 2025

# INTRODUCTION

Swing Kingdom's playsets are engineered from a safety first perspective. Our slip resistant vinyl-clad construction materials are always splinter free and no wood means no harsh chemical treatments. Stainless steel hardware brings added stability, while preventing rust and corrosion.

Our premium vinyl playsets are five times stronger than traditional wooden playsets. Each playset is manufactured with a high standard of durability and quality along with a 5-year warranty to stand behind our product.

We hope that the information on these pages will help you with assembling your Swing Kingdom playset. If you are unable to find the answers to your questions here when building, please contact your local authorized Swing Kingdom dealer, or call us direct at 717-656-4449.

## WARRANTY

Subject to ordinary residential use and proper installation.

Swing Kingdom warrants to the original purchaser at the original installation address, that the structural components of the playset, such as the PVC vinyl and wood components are covered by a 5-year warranty. In addition, all canopies, slides, metal components, swings and accessories are warranted for 5 years from date of original purchase.

Swing Kingdom's products are not warranted as being suitable for a particular purpose. The suitability of the product is for the purchaser to determine. This warranty does not cover normal wear and tear, failure to properly maintain the product, or damage resulting from misuse or abuse of the product, additionally any acts of nature such as lightning, storms, hurricanes, tornadoes, earthquakes or any extreme weather conditions. Also any alteration, additions or relocation of the product will void this warranty.

Swing Kingdom reserves the right to examine photographs and/or physical evidence of the product claimed to be defective, and to recover product prior to any warranty claims. All products returned for inspection must be sent freight prepaid. In the event of a defect covered by these warranties, Swing Kingdom will remedy the defect within a reasonable time. The remedy will consist of repair or replacement of the defective piece unless it is not practical. Then Swing Kingdom will reimburse the original purchaser for the value of the defective piece.

All freight cost of replacement parts are not covered under warranty and will be the purchaser's responsibility to cover.

Adult supervision is recommended while enjoying your play system.



## WARNING

- This instruction manual contains important information necessary for the proper assembly and safe use of the playset.
- Read and follow all warnings and instructions before assembling.
- Follow all warnings and instructions.
- Keep this manual for future reference.

# SAFETY WARNING

Failure to follow these instructions could result in faulty equipment, which could cause property damage, personal injury or death! **Remember: Think Safety and Use Common Sense!**

## Prevent Serious Injury or Death and Equipment Damage When Installing

- Work on dry sunny days to minimize the risk of slipping.
- Move items close to your body and use your legs when lifting an item from a low location.
- Avoid twisting, especially when bending forward while lifting. Turn by moving the feet rather than twisting the torso.
- Keep your elbows close to your body and keep the load as close to your body as possible.
- Limit weight you lift to no more than 50 pounds. When lifting product heavier than 50 pounds, use two or more people to lift the product up.
- Use personal protective equipment and clothing such as safety helmets, gloves, safety goggles, ear protection, and safety footwear.

## Maintenance

It is of particular importance that these guidelines be followed at the beginning of each season as well as at regular intervals during the usage season:

- Check all nuts and bolts for tightness and tighten when required.
- Check all coverings for bolts and sharp edges and replace when required.
- Check swing seats, chains, ropes and other means of attachments for evidence of deterioration.
- Replace defective parts in accordance with the manufacturer's instructions.

## General Safety Precautions

Users who use hand and power tools and who are exposed to the hazards of falling, flying, abrasive and splashing objects, or exposed to harmful dusts, fumes, mists, vapors, or gases must be provided with the particular personal equipment necessary to protect them from the hazard.

All hazards involved in the use of power tools can be prevented by following five basic safety rules:

- Keep all tools in good condition with regular maintenance.
- Use the right tool for the job.
- Examine each tool for damage before use.
- Operate according to the manufacturer's instructions.
- Provide and use the proper protective equipment.

## Fasteners

When using power tools to apply fasteners, there are some precautions to consider:

- Fasteners must not be fired into material that would let them pass through to the other side.
- The fastener must not be driven into materials like brick or concrete any closer than 3 inches to an edge or corner.
- In steel, the fastener must not come any closer than one-half inch from a corner or edge.
- Fasteners must not be driven into very hard or brittle materials which might chip, splatter, or make the fastener ricochet.



## Parts

Tower	Qty	Parts
	4	84" 4x4
	2	72" 4x4
	7	22" 2x6 Steps
	2	60" 2x6
	2	56" 2x4
	2	78½" 2x6
	8	56" 2x6
	8	55¾" 2x4
	2	52" 4x4 Post
	2	74" 4x4 Post
	2	3⅜" x 59½" Floorboard
	16	5½" x 59½" Floorboard
	2	5½" x 48" Floorboard
	2	5½" x 53¾" Floorboard
	10	28½" Poly
	1	28½" Poly w/ Angle Cut
	1	22" Poly
	2	127" 4x4 Post
	4	64" 2x6
	2	28" 2x4 Brace
	2	19" 2x4 Brace
	25	¾" x 2⅝" x 33⅜" Poly Slat
	4	¾" x 2⅝" x 24" Poly Slat
	1	Poly Slat Assembly
	2	Poly Slat Template
Swing Frame	1	168" Swing Beam
	1	92" Swing 4x4
	1	106" 2x4 Ground Board
	1	89" 2x4 Swing Brace
	1	Poly Brace
	2	Swing Beam Post Plate
	1	Swing Beam Bracket
Roof	2	120" 2x4
	1	61⅝" 2x4
	3	35¾" 2x4
	1	24" 2x4 Brace
	4	Roof 2x4 Vertical
	2	59½" Roof Horizontal 2x4
	2	(1) Canvas w/ (2) 62½" 2x4s
	4	Roof Flags
	2	26¼" 2x6 w/ poly attached

## Accessory Parts

1	Climber Handrail
1	10' Avalanche Slide
1	14' Avalanche Slide
2	⅝" Diameter Rope
1	1" Diameter Rope
2	Belt Swing
1	Trapeze
1	Web Swing
1	Tire Swing
1	Hammock Swing
1	Tic-Tac-Toe Board
1	Bubble Panel

## Hardware Packs

Tower	94	⅞" x 4" Lag
	4	⅞" x 3" Lag
	98	⅜" Washer
Floor	202	2" Polybuster Screw
Poly Slats	89	1¾" Washer Head Screw
Swing Frame	6	⅞" x 5" Bolt
	2	⅞" x 2.75" Bolt
	8	⅞" Locking Nut
	3	⅞" x 4" Lag
	2	⅞" x 3" Lag
	21	⅜" Washer
Swing Hook	8	Swing Hook
	1	Tire Swivel
	18	⅞" x 4" Lag
Roof	18	⅜" Washer
	22	⅞" x 4" Lag
	8	⅞" x 3" Lag
Climber Handrail	30	⅜" Washer
	4	½" x 1½" Lag
	4	⅝" Washer
Accessories	41	2" Polybuster Screw
	10	1¾" Washer Head Screw
	26	¼" x 1¼" Pan Head Screw
Stake	26	⅝" Washer
	2	Stake
	2	½" x 1½" Lag
	2	⅜" Washer

## Leg Parts

**A1: 84" 4x4 with Stair Slats (x1)**

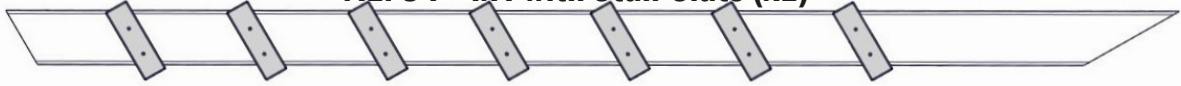

**A2: 84" 4x4 (x2)**



**A3: 84" 4x4 with Eye Bolts (x1)**



**B1: 72" 4x4 with Stair Slats (x1)**

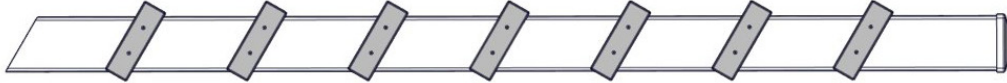

**B2: 72" 4x4 with Eye Bolts (x1)**



**C: 22" 2x6 Step (x7)**



**D1 - 60" 2x6 (x1)**



**D2 - 60" 2x6 with Rope Holes (x1)**



**E1 - 56" 2x4 (x1)**



**E2 - 56" 2x4 with Rope Holes (x1)**

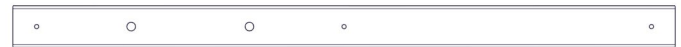

**F: 78 1/2" 2x6 (x2)**



## Tower Parts

**G - 56" 2x6 with Joist Hangers (x2)**



**H - 55 3/4" 2x4 Joist (x6)**



**I1 & I2 - 52" 4x4 Post (x2)**



**J1 & J2 - 74" 4x4 Post (x1)**



**K1 & K5 - 56" 2x6 Railing with Roof Hole(x2)**



**K3 - 56" 2x6 with End Caps (x1)**



**K2 - 56" 2x6 Railing w/ Roof & Swing Holes (x1)**



**K4 - 56" 2x6 (x2)**



# Tower

## 01 & 02 - 127" 4x4 Post (x2)



### L1 - 55 3/4" 2x4 with Sequence Plaque (x1)



### L2 - 55 3/4" 2x4 (x1)



### R - 19" 2x4 Brace (x2)



### Q - 28" 2x4 Brace (x2)



### P1 & P2 - 64" 2x6 with Corner Bracket, End Cap, & Brace Holes (x2)

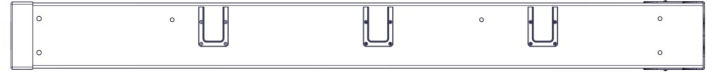

### P3 - 64" 2x6 with Corner Bracket & End Cap (x2)



## Tower Poly Items

### M1 - 3 3/8" x 59 1/2" Floorboard (x2)



### M2 - 5 1/2" x 59 1/2" Floorboard (x16)



### M3 - 5 1/2" x 48" Floorboard (x2)



### M3 - 5 1/2" x 53 3/4" Floorboard (x2)



### S1 - 2 5/8" x 33 3/8" Poly Slat (x20)

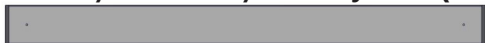

### S2 - 3/4" x 2 5/8" x 24" Poly Slat (x4)



### T1 - 5x5 Poly Slat Template (x1)

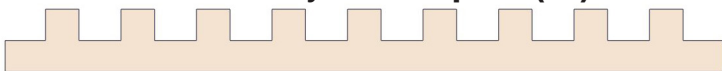

### T2 - Extension Slat Template (x1)

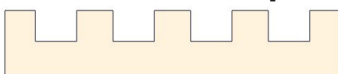

### N1: 28 1/2" Poly with Groove & Center Hole (x1)



### N2: 28 1/2" Poly with Groove (x9)

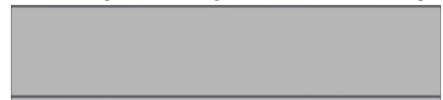

### N3: 28 1/2" Poly with Angle Cut (x1)

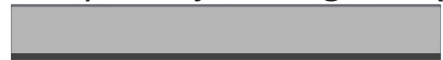

### N2: 22" Poly (x1)

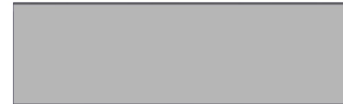

### S3: Poly Slat Assembly (x1)

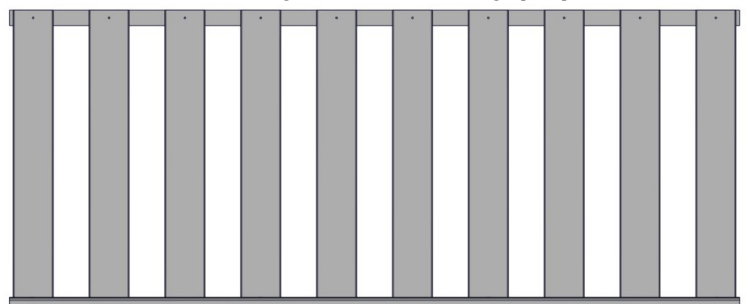

### AM -26 1/4" 2x6 w/ poly attached (x2)



## Swing Frame Parts

**U - 168" 2x6 Swing Beam (x1)**



**W - 106" 2x4 Ground Board (x1)**



**V - 92" 4x4 Post (x1)**



**X - 89" 2x4 Brace (x2)**



**Y - Poly Brace (x1)**



**Z - Post Plate (x2)**



**AA - Bracket (x1)**



## Roof Parts

**AB1 (2) & AB2 (1) - 120" 2x4 Roof Railing (x3)**



**AF, AG, AH, & AI - Roof Vertical 2x4 (x4)**



**AE - Roof Brace 2x4 (x1)**



**AC - 61 5/8" 2x4 (x1)**



**AD - 35 3/4" 2x4 (x1)**



**AJ - 50 1/2" 2x4 (x2)**



**AL - Flag (x6)**

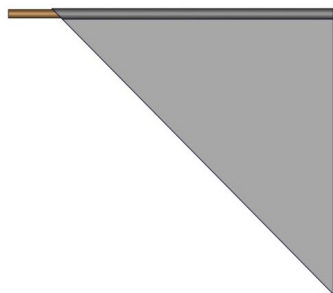

**AK - (1) Canvas with (2) 62 1/2" 2x4 (x2)**



# Accessories

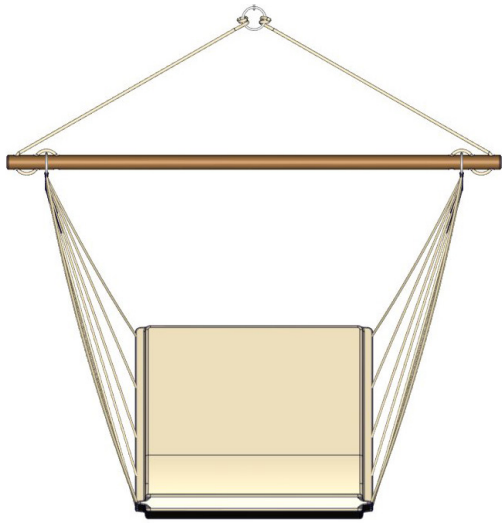

**Hammock Swing (x1)**

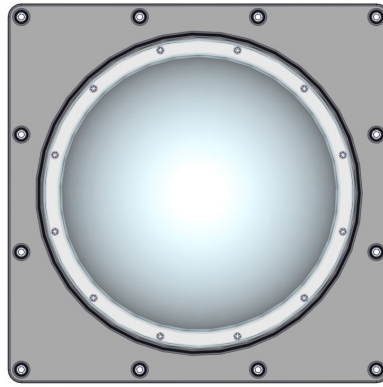

**Bubble Panel (x1)**

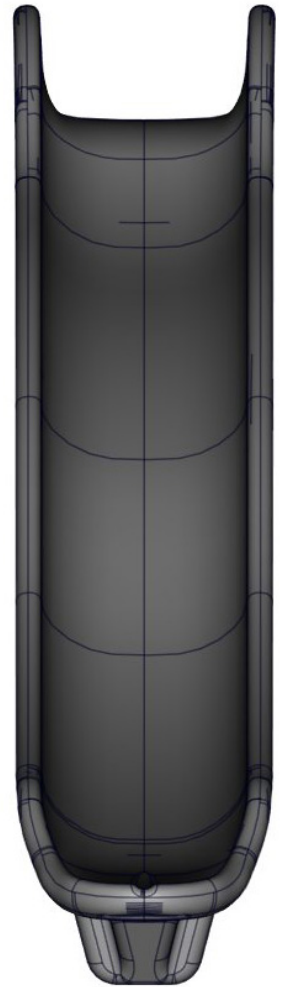

**14' Waterfall Slide (x1)**

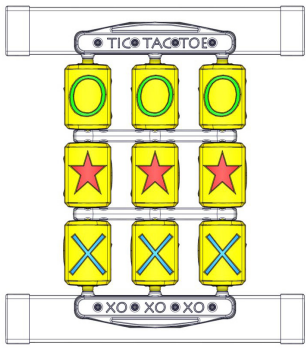

**Tic-Tac-Toe Panel (x1)**



**Tire Swing (x1)**

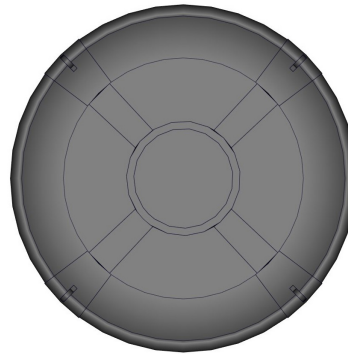

**Web Swing (x1)**

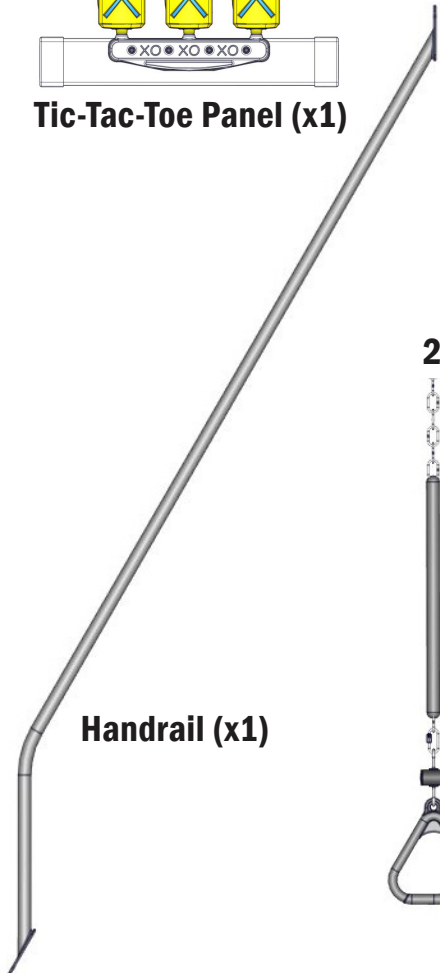

**Handrail (x1)**

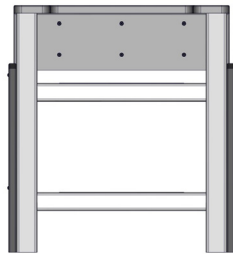

**2' Access Ladder (x1)**



**Trapeze (x1)**



**Belt Swing (x2)**

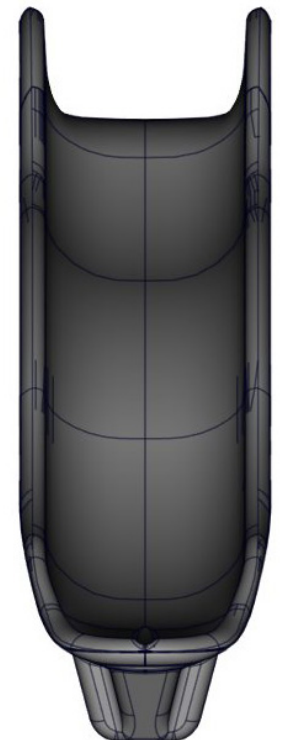

**10' Waterfall Slide (x1)**

HARDWARE

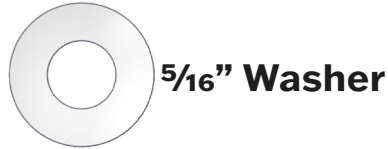
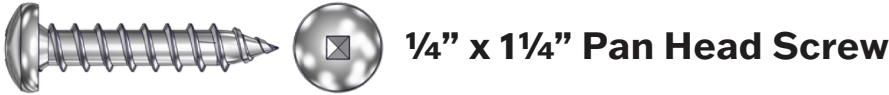
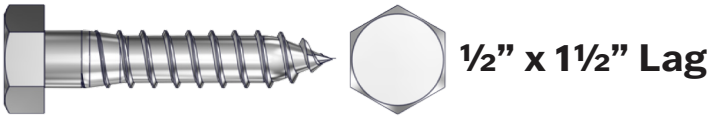
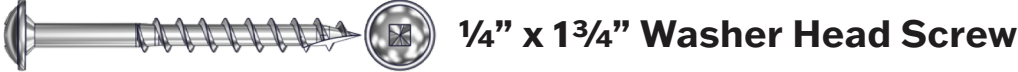
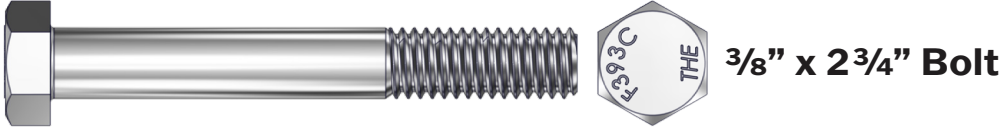
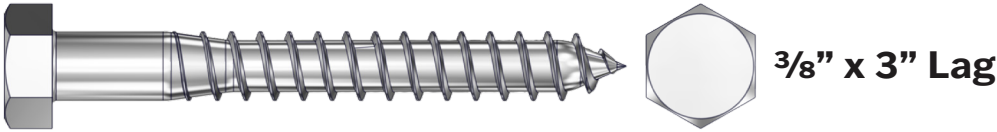
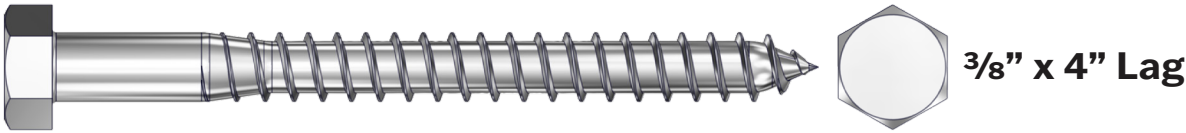

**#2 Square Drive Bit**





# LEG ASSEMBLY

STEP  
**01**

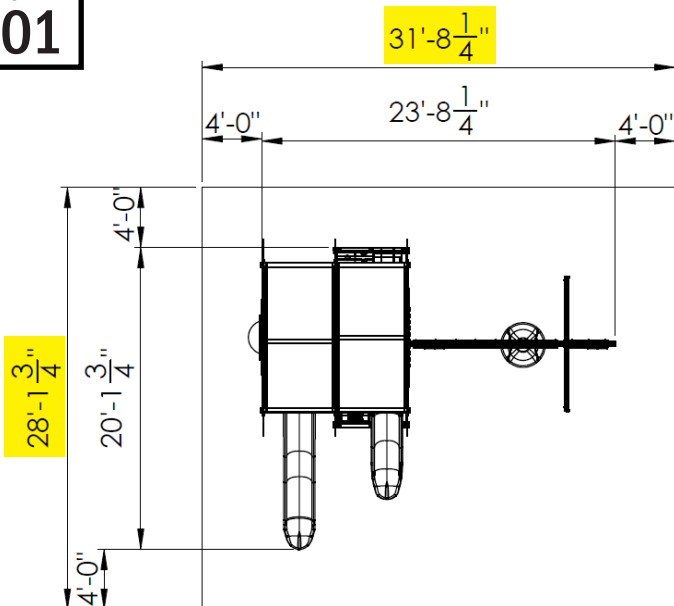

- **Review the dimensions above** (4ft is our recommended space around the playset. CPSC recommends 6ft. You may need to review your local laws or guidelines for more assistance.)
- **Find a level surface.** (You may need to dig out high areas or use treated lumber to block up low areas to make your surface level.)
- **Determine where you want the front & back of the playset.**
- **Lay out each bundle.** (Don't unwrap the bundles until you reach the appropriate step. Only cut in the creases to avoid damaging items.)

STEP  
**02**

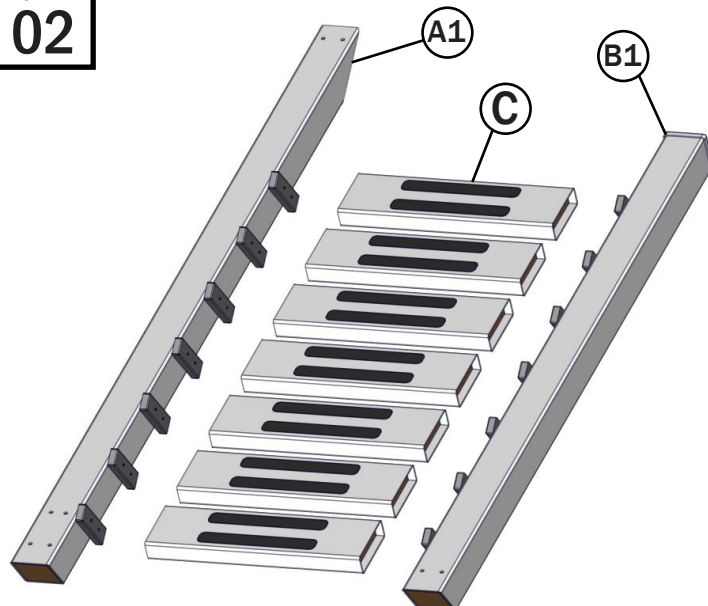

Locate and prepare the "Leg 1" & "Step" Bundles which includes...

- A1: (1) 84" 4x4 with Stair Slats
- B1: (1) 72" 4x4 with Stair Slats
- C: (7) 22" 2x6 Step

Also locate the "Tower" & "Accessory" (for the steps) Hardware bags.

STEP  
**03**

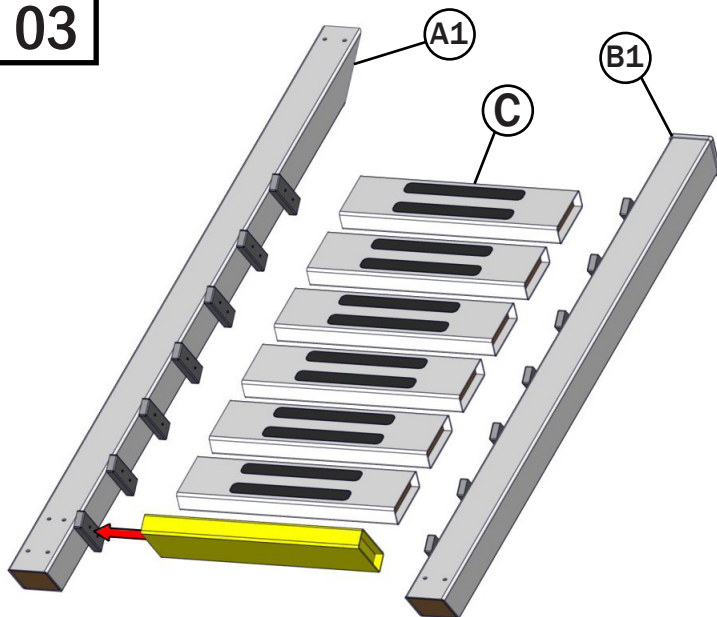

- Arrange "A1" & "B1" so the slats are facing each other. "B1" will be on the right with an end cap on the top end & "A1" will be on the left with the sharper angle on the top end. Place "C" between the two.
- "C" will slide onto the stair slat of "B1". Make sure the side with the black grips are facing the top end.

STEP  
**04**

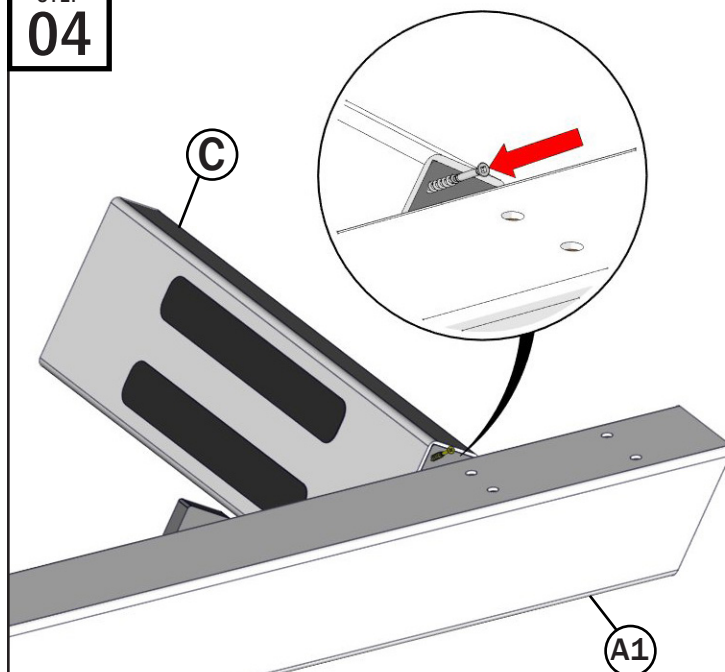

- Push "C" against "A1"
- Using (1) 2" Polybuster Screw, tilt the screw at a 45 degree angle and drill it into the corner of the stair slat. This will fasten the "C" to "A1".
- Repeat on the rest of the steps.

# LEG ASSEMBLY

STEP  
05

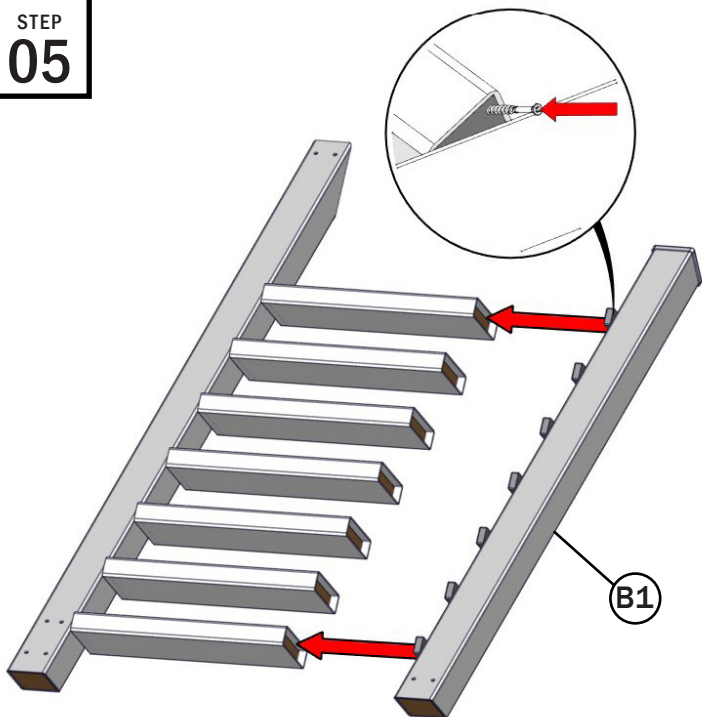

- You may want to tilt the step assembly on end, but it is not necessary.
- Place the stair slats from "B1" onto the other end of the steps. This will take some adjusting to get all steps on the slat.
- Using (7) 2" Polybuster Screw, tilt the screw at a 45 degree angle and drill it into the corner of the stair slat.

STEP  
06

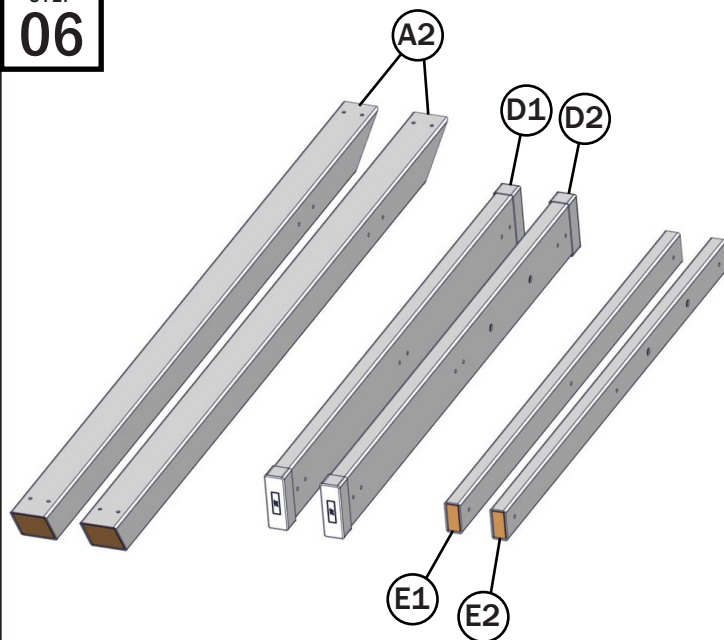

Locate and prepare the "Leg 2", "Base 1", & "Base 2" Bundles which include...

- A2: (2) 84" 4x4
- D1: (1) 60" 2x6
- D2: (1) 60" 2x6 with Rope Holes
- D3: (1) 56" 2x4
- D4: (1) 56" 2x4 with Rope Holes

STEP  
07

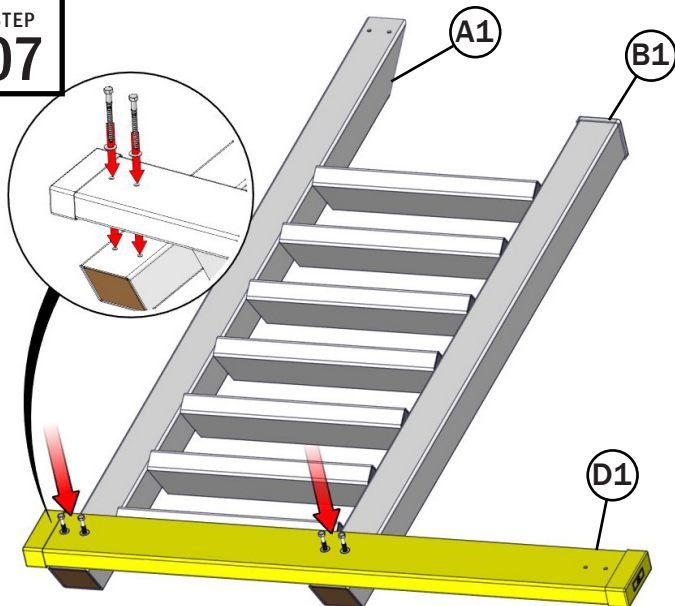

**Note: DO NOT OVER-TIGHTEN.** Fasten them enough so the parts touch. If the vinyl starts to dent or dimple, you know it is tight enough.

- Place "D1" on top of the stair assembly with the left and center holes of "D1" aligning with the bottom holes of "A1" & "B1".
- Using (4) 9/16" x 4" Lags & 3/8" Washers, drill into the holes of "D1" so that the tip of the lags are showing on the other side.
- Use the tip of the lags to find the holes on "A1" & "B1".
- Fasten the Lags into the "A1" & "B1".

STEP  
08

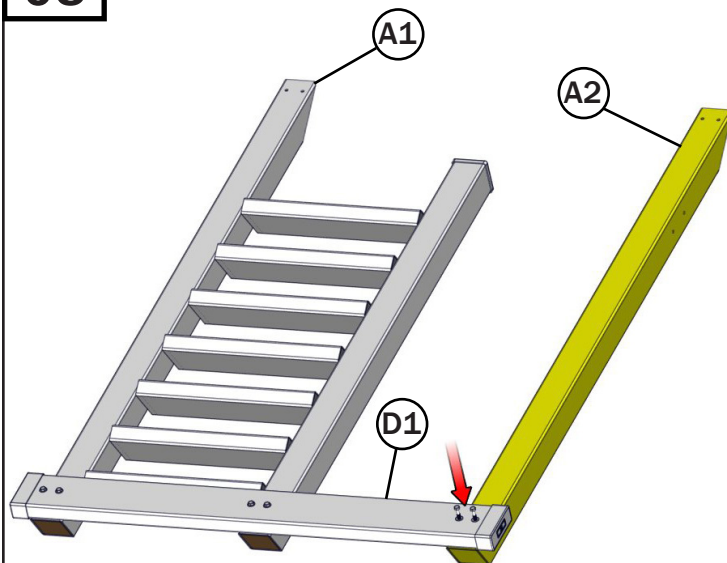

**Note: DO NOT OVER-TIGHTEN.** Fasten them enough so the parts touch. If the vinyl starts to dent or dimple, you know it is tight enough.

- Place "A2" underneath the open end of "D1" with the sharper angled end at the top matching "A1". Line up the holes on "A2" & "D1".
- Using (2) 9/16" x 4" Lags & 3/8" Washers, drill into the holes of "D1" so that the tip of the lags are showing on the other side.
- Use the tip of the lags to find the holes on "A2".
- Finish fastening the items together.

## LEG ASSEMBLY

STEP  
09

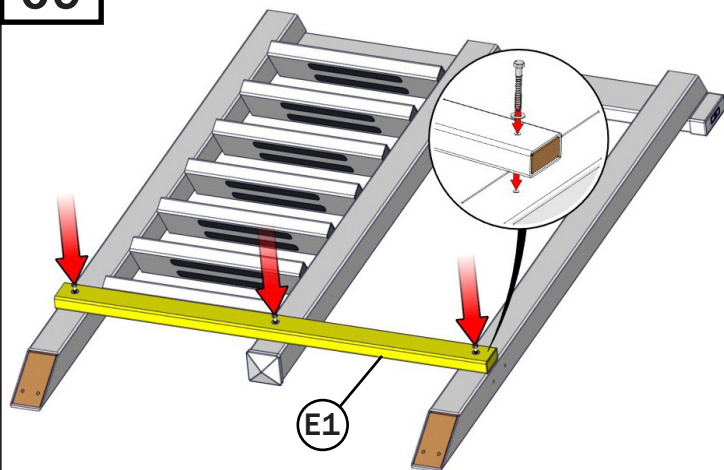

- Carefully flip the entire assembly over.
- Place "E1" by the top of the stair assembly lining up the holes on "E1" with each holes on the 4x4 legs.
- Using (2) 9/16" x 4" Lags & 3/8" Washers, drill into the holes of "E1" so that the tip of the lags are showing on the other side.
- Use the tip of the lags to find the holes on the 4x4 legs.
- Finish fastening the items together.

STEP  
10

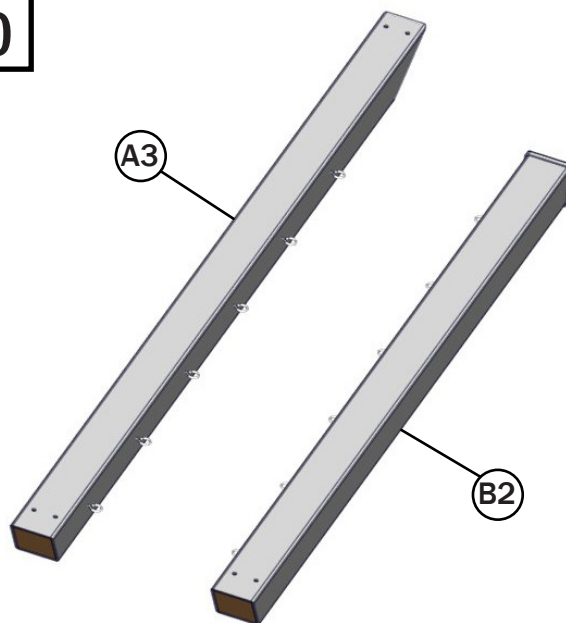

Locate and prepare the "Leg Bundle 3" which include...

- A3: (1) 84" 4x4 with Eye Bolts
- B2: (1) 72" 4x4 with Eye Bolts

Just like the stairs, place "A3" & "B2" with the eye bolts facing each other. You will need the items opened previously ("A2", "D2", & "E2")

STEP  
11

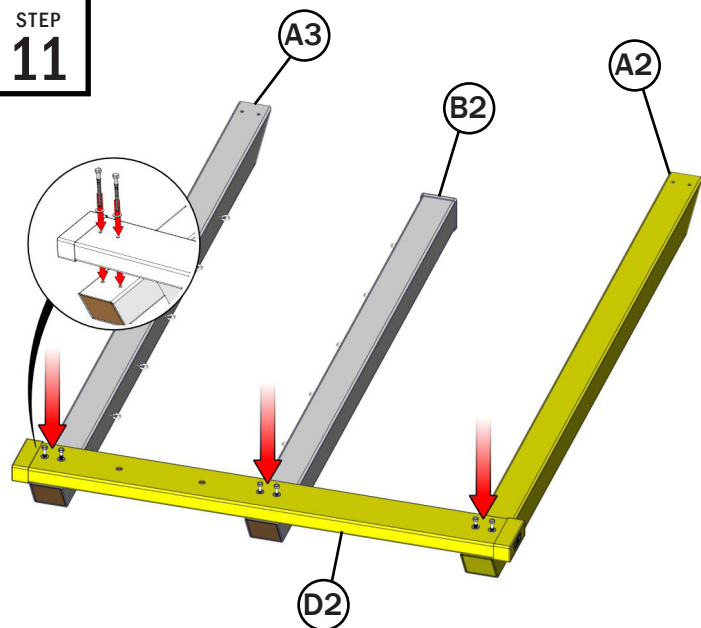

**Note: DO NOT OVER-TIGHTEN.** Fasten them enough so the parts touch. If the vinyl starts to dent or dimple, you know it is tight enough.

- Just like the stair assembly, you will place "D2" on top of "A3" & "B2", then put "A2" on the right side of "D2". Make sure the rope holes on "D2" are between the eye bolts.
- Using (6) 9/16" x 4" Lags & 3/8" Washers, drill into "D1" and use the lag tips as a guide to line up the bottom holes on "A3", "B2", & "A2".
- Fasten everything together.

STEP  
12

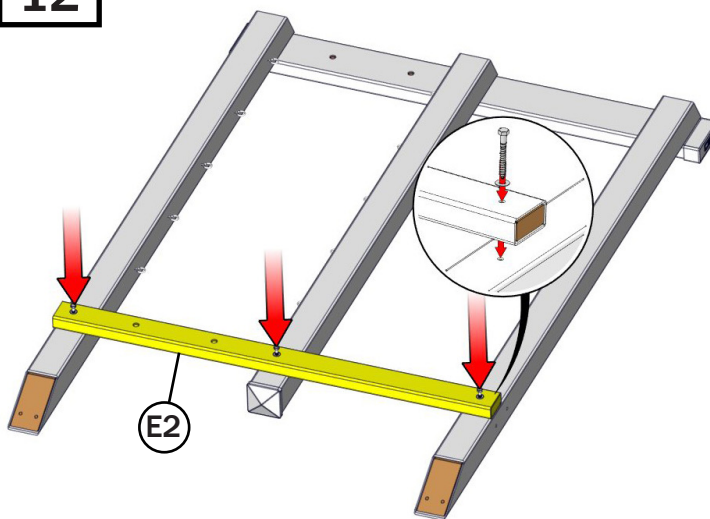

**Note: DO NOT OVER-TIGHTEN.** Fasten them enough so the parts touch. If the vinyl starts to dent or dimple, you know it is tight enough.

- Flip the assembly over and place "E2" on the back side towards the top of the assembly. Make sure the rope holes are between the eye bolts.
- Using (3) 9/16" x 4" Lags & 3/8" Washers, drill into "D1" and use the lag tips as a guide to line up the bottom holes on "A3", "B2", & "A2".
- Fasten everything together.



## LEG ASSEMBLY

### STEP 13

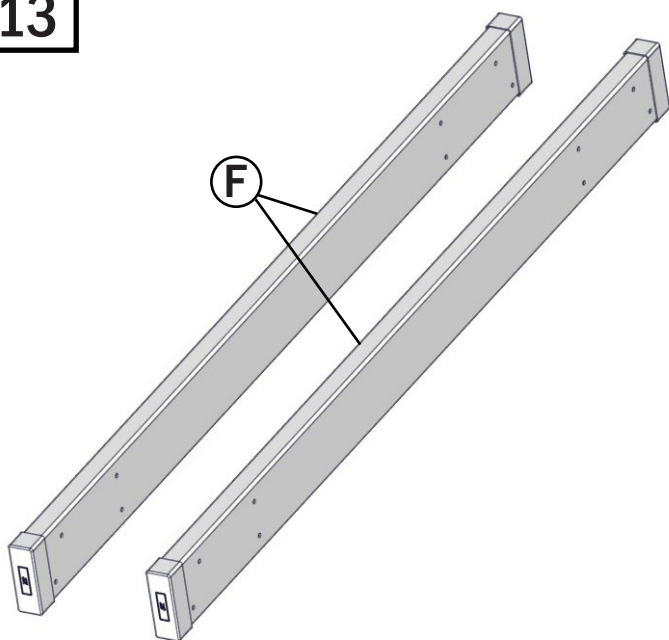

Locate and prepare the "Floor Bundle 1" which include...

- F: (2) 84" 4x4

### STEP 14

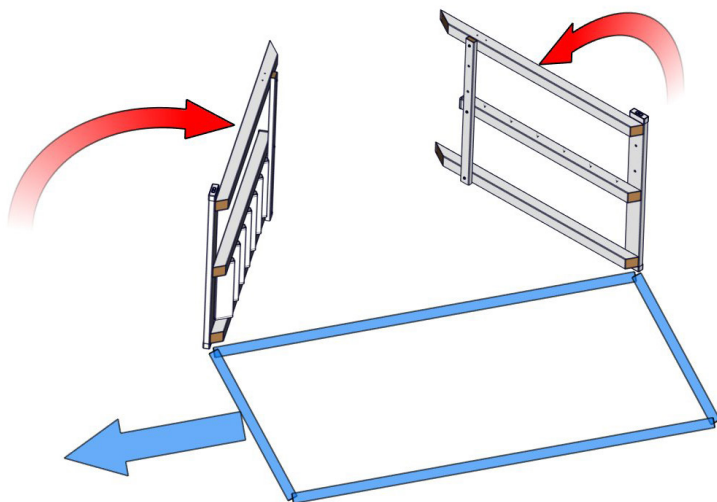

- Locate where you would like the tower & the front of the tower to be.
- Place the assemblies you just built as shown above with the stair assembly by the front & lift them on their sides.
- You will need 1 person per assembly to hold them up while the 3rd person connects them by following step 15.

### STEP 15

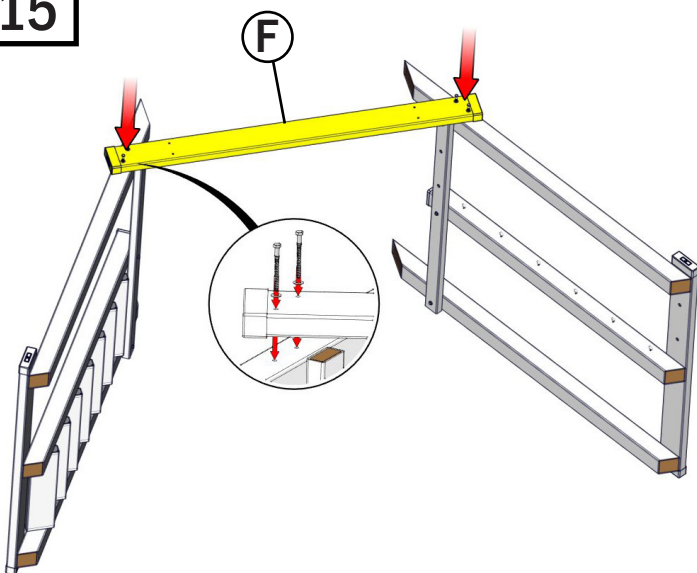

**Note: DO NOT OVER-TIGHTEN.** Fasten them enough so the parts touch. If the vinyl starts to dent or dimple, you know it is tight enough.

- Place "F" on top of the assemblies with the far angled holes lining up with the side holes on the legs.
- Using (4) 9/16" x 4" Lags & 3/8" Washers, drill into the holes of "F" so that the tip of the lags are showing on the other side.
- Use the tip of the lags to find the holes on the legs.
- Finish fastening the parts together.

### STEP 16

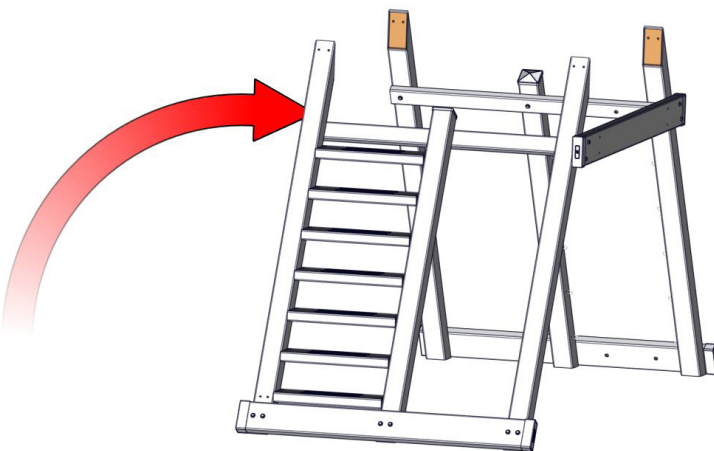

- With all 3 people, lift and flip the tower upright.
- The tower should sit freely, but 1 person can stabilize the tower until the next step.

# TOWER ASSEMBLY

STEP  
17

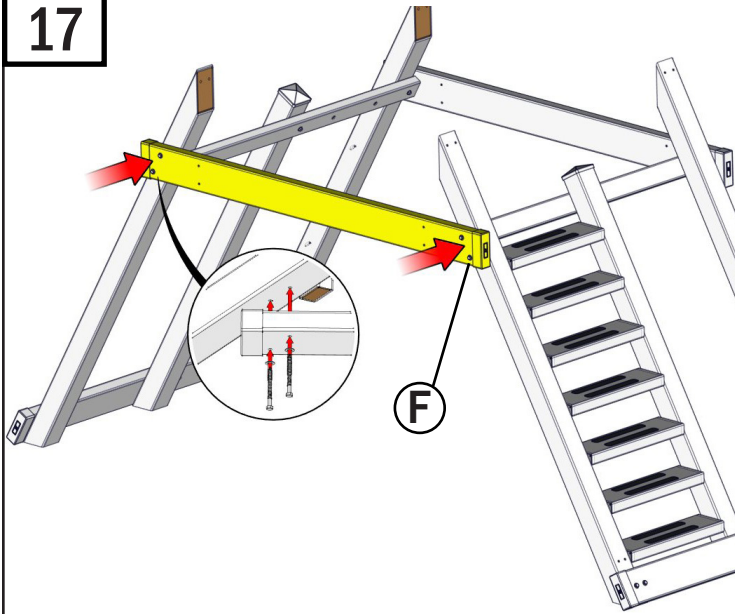

**Note: DO NOT OVER-TIGHTEN.** Fasten them enough so the parts touch. If the vinyl starts to dent or dimple, you know it is tight enough.

- Place "F" on the other side with the angled holes lining up with the holes on the assemblies.
- Using (4) 9/16" x 4" Lags & 3/8" Washers, drill into the holes of "F" so that the tip of the lags are showing on the other side.
- Use the tip of the lags to find the holes on the legs.
- Finish fastening the parts together.

STEP  
18

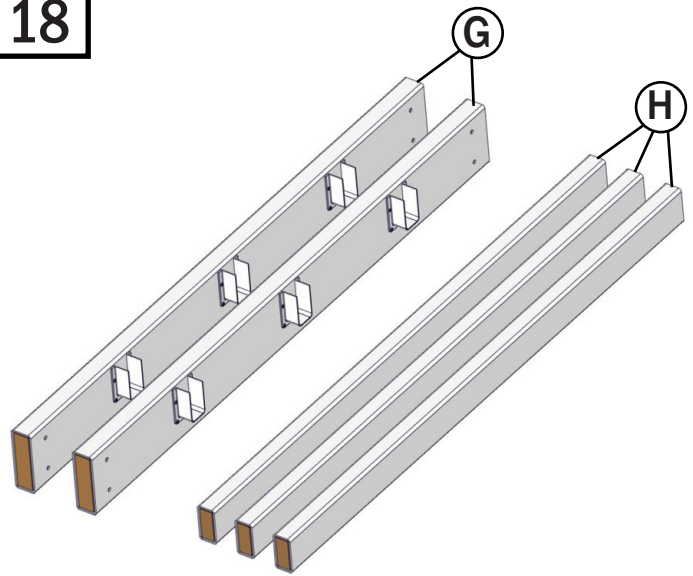

Locate and prepare the "Floor Bundle 2" which include...

- G: (2) 56" 2x6 w/ Joist Hangers
- H: (3) 55 3/4" 2x4 Joist

STEP  
19

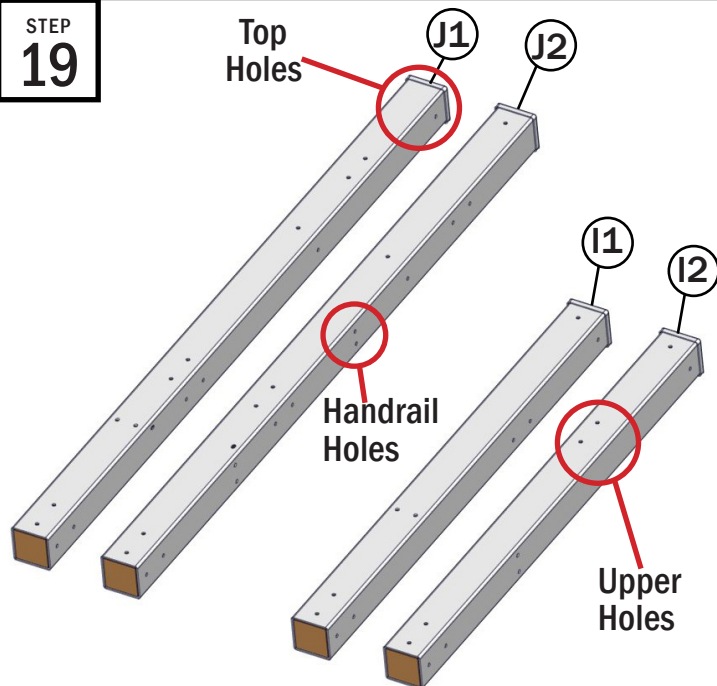

Locate and prepare the "Post Bundles 1 & 2" which include...

- I1: (2) 52" 4x4 Post with Upper Right Holes
- I2: (1) 52" 4x4 Post with Upper Left Holes
- J1: (1) 74" 4x4 Post with Top Right Hole
- J2: (1) 74" 4x4 Post with Top Left Hole & Handrail holes

STEP  
20

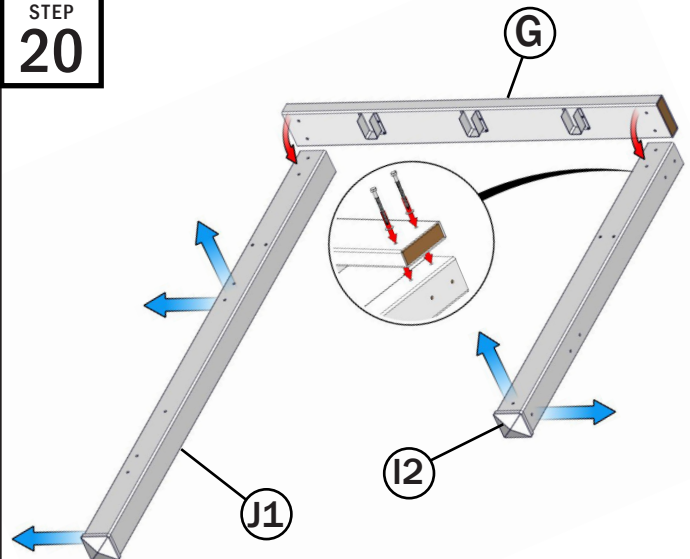

**Note: DO NOT OVER-TIGHTEN.** Fasten them enough so the parts touch. If the vinyl starts to dent or dimple, you know it is tight enough.

- Place "I2" & "J1" next to each other with the top most holes facing up & away from the other post. The Upper Holes will be facing away from the other post as well.
- Place "G" at the bottom of the posts with the joist hangers on the same side as the posts facing towards the top of the posts.
- Use (4) 9/16" x 4" Lags & 3/8" Washers to fasten "G" to the posts.

# TOWER ASSEMBLY

STEP  
21

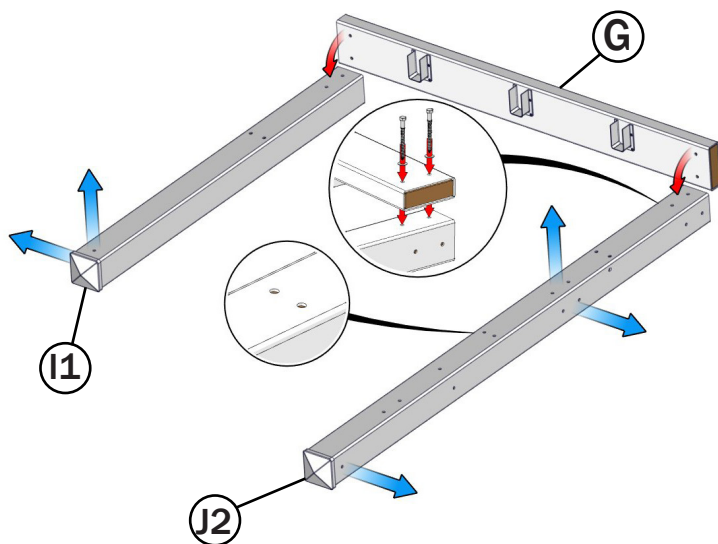

- Repeat the same process with "I1" & "J2". "J2" will have extra holes for the handrail. Make sure "J2" is on the correct side shown.
- Repeat placing "G" on top with the joist hangers facing the correct directions
- Use (4) 9/16" x 4" Lags & 3/8" Washers to fasten "G" to the posts.

STEP  
22

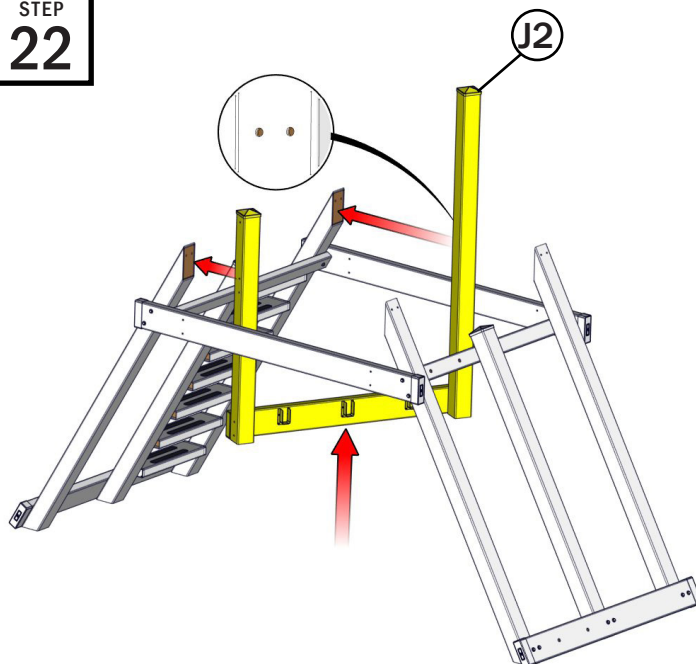

- Have 2 people grab the assembly that has "J2" (has the 2 extra holes) & carefully angle the assembly so it fits easily in the tower.
- Make sure the joist hangers are facing the inside of the tower and the posts are facing upwards.
- You will need to wedge the assembly to the front (side with the stairs) of the tower so that the posts are against the 4x4 legs.

STEP  
23

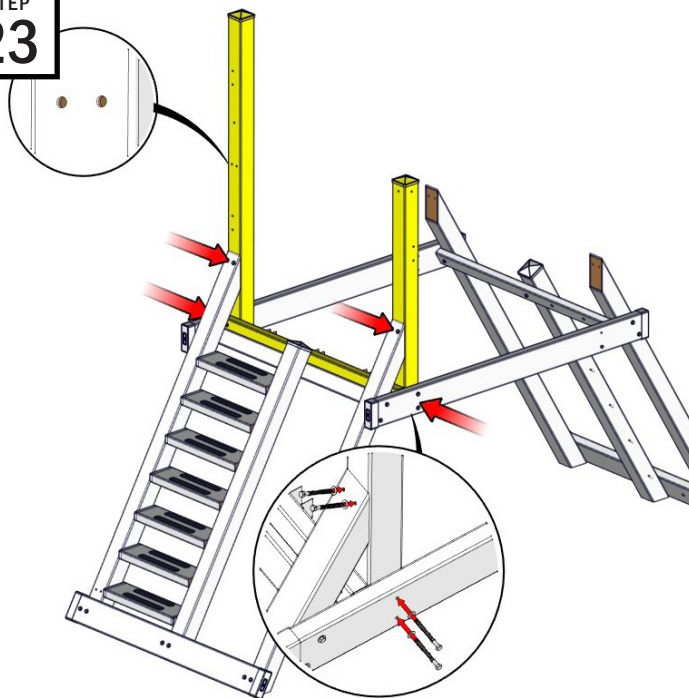

- The 3rd person will use (8) 9/16" x 4" Lags & 3/8" Washers to fasten the assembly to the tower.

Note: The 2 people holding the assembly will have to adjust this a bit to get the Lags into the holes.

STEP  
24

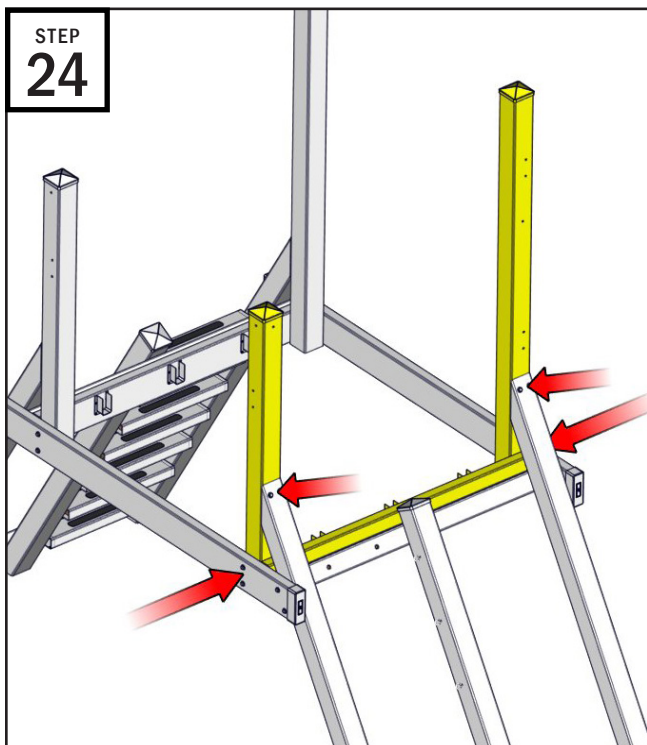

- Repeat the same steps on the other assembly, placing it on the back side of the tower.
- Make sure the joist hangers are facing the inside of the tower.



# TOWER ASSEMBLY

STEP  
25

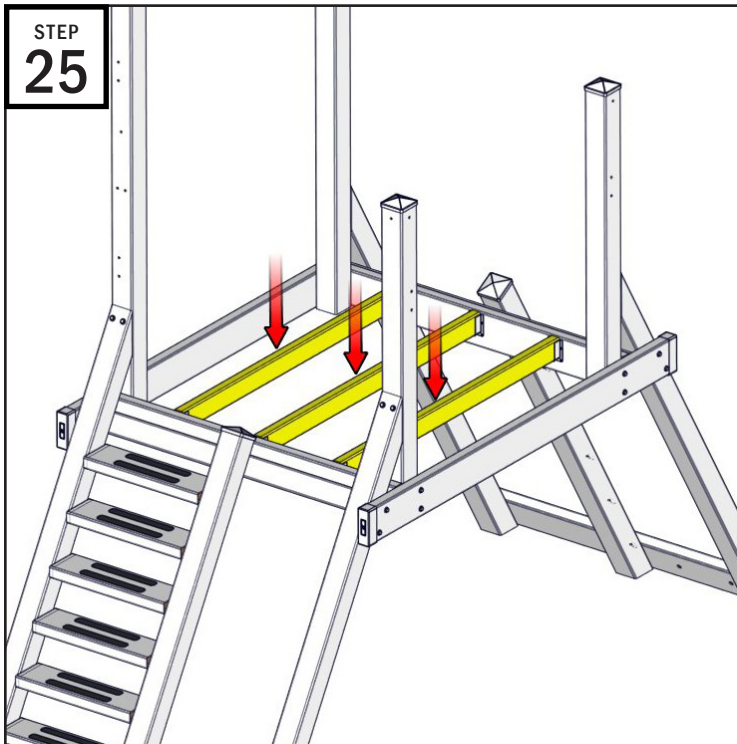

- You will have 3 joists remaining (H).
- Place these on the joist hangers.

STEP  
26

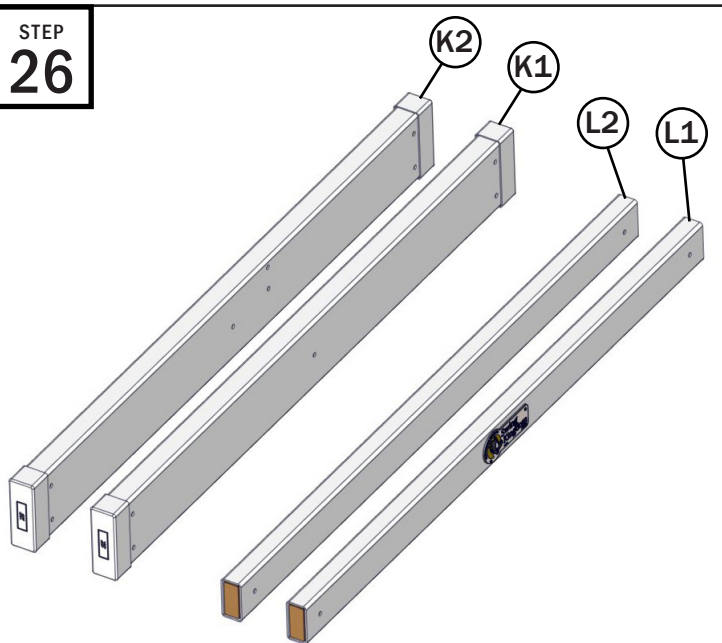

Locate the "Railing Bundle" which includes...

- K1: (1) 56" 2x6 Railing with Roof Holes
- K2: (1) 56" 2x6 Railing with Roof & Swing Beam Holes
- L1: (1) 55 3/4" 2x4 Railing with Sequence Plaque
- L2: (1) 55 3/4" 2x4 Railing

STEP  
27

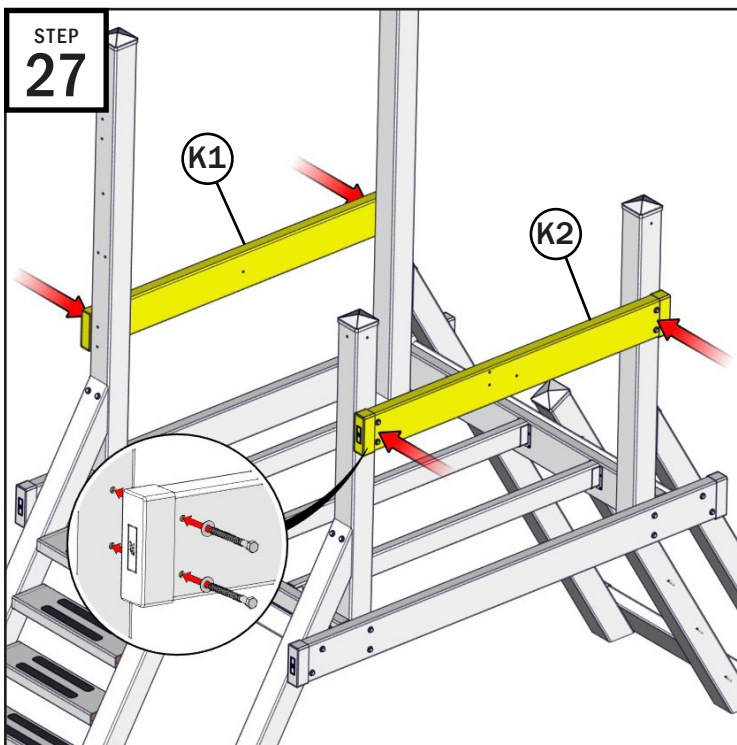

- Place "K1" & "K2" on the sides of the tower. "K2" will be on the same side as the swings (image shows on right side)
- Using (4) 9/16" x 4" Lags & 3/8" Washers, drill into the large holes of the 2x6 so that the tip of the lags are showing on the other side.
- Use the tip of the lags to find the holes on the 4x4 post.
- Fasten the Lags the into the 4x4 post.

STEP  
28

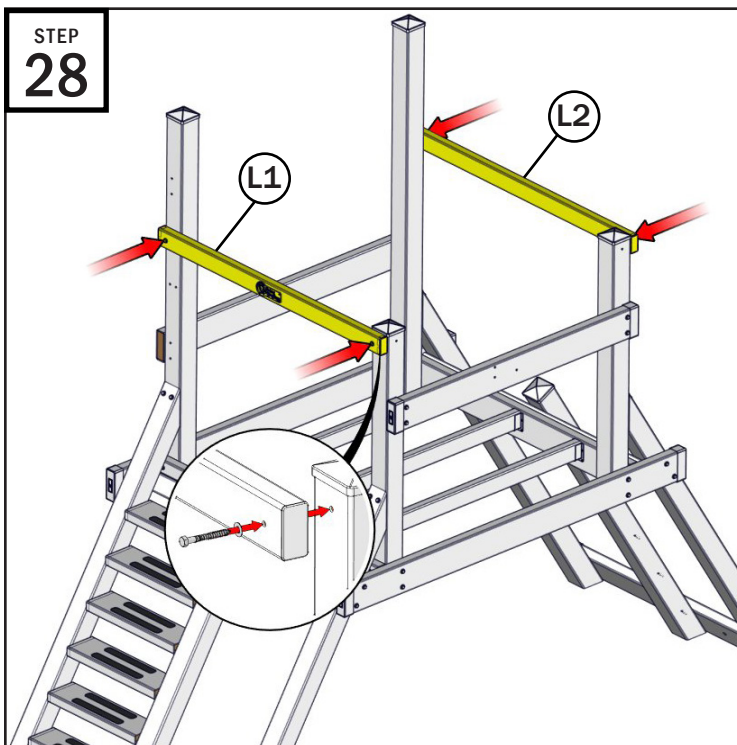

- Place "L1" on the front & "L2" on the back of the tower.
- Using (4) 9/16" x 4" Lags & 3/8" Washers, drill into the large holes of the 2x6 so that the tip of the lags are showing on the other side.
- Use the tip of the lags to find the holes on the 4x4 post.
- Fasten the Lags the into the 4x4 post.

# FLOOR ASSEMBLY - HANDRAIL INSTALL

STEP  
29

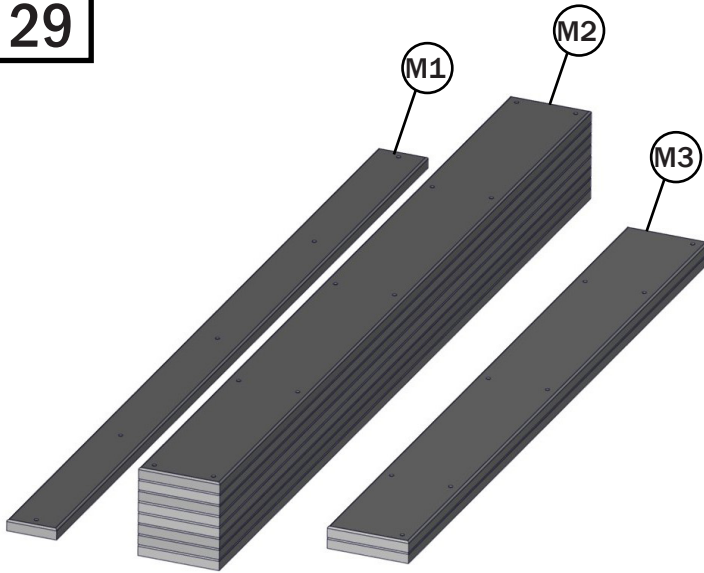

Locate and prepare the "Floorboard Bundle" which includes...

- M1: (1) 3 3/8" x 59 1/2" Floorboard
- M2: (8) 5 1/2" x 59 1/2" Floorboard
- M3: (2) 5 1/2" x 48" Floorboard

Also locate the "Floor Hardware" bag.

STEP  
30

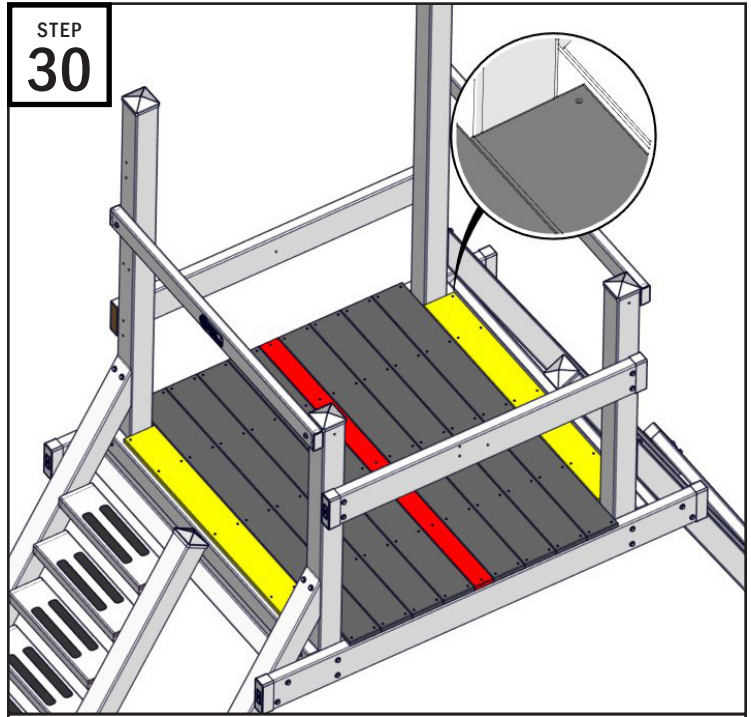

- Place the (8) "M2"s perpendicular from the joists below them.
- Place "M1" in the center of the tower.
- Place the (2) "M3"s on the sides. Make sure the corners with the pre-punched holes are facing outward.
- Center the floorboards. The boards are not 100% accurate. Run your fingers along both sides of the floorboards and adjust them one by one to make them as centered as possible.

STEP  
31

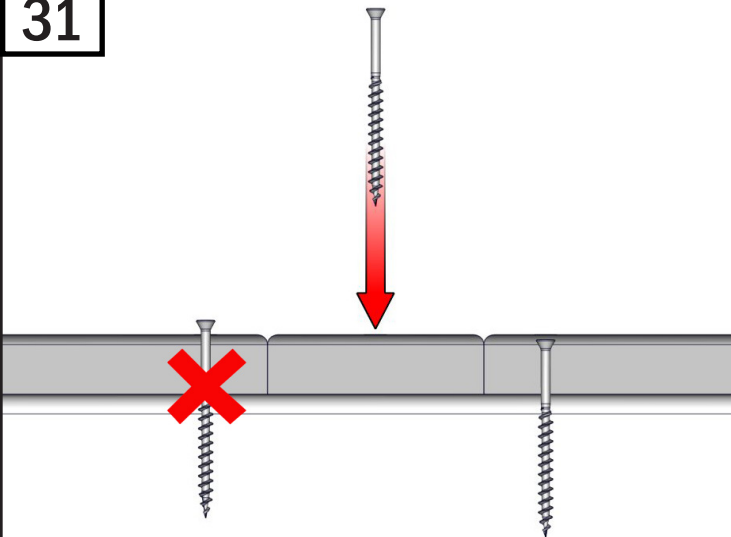

**Note:** Smaller screws like this can strip easily. Make sure your drill is aligned straight up and down with the screw. Stripping screws can damage the bit and cause more screw stripping.

- Center one of the corner "M2" boards and use the #2 Drive Bit to drill (1) 2" Polybuster Screw into a pre-punched corner hole.
- Repeat with the neighboring "M2", adjusting to center all boards.
- Drill the remaining screws into the pre-punched holes. Each hole will line up with the joists and base boards underneath.

**Note:** Fasten the screws so the head of the screw is below the surface of the deck as shown above.

STEP  
32

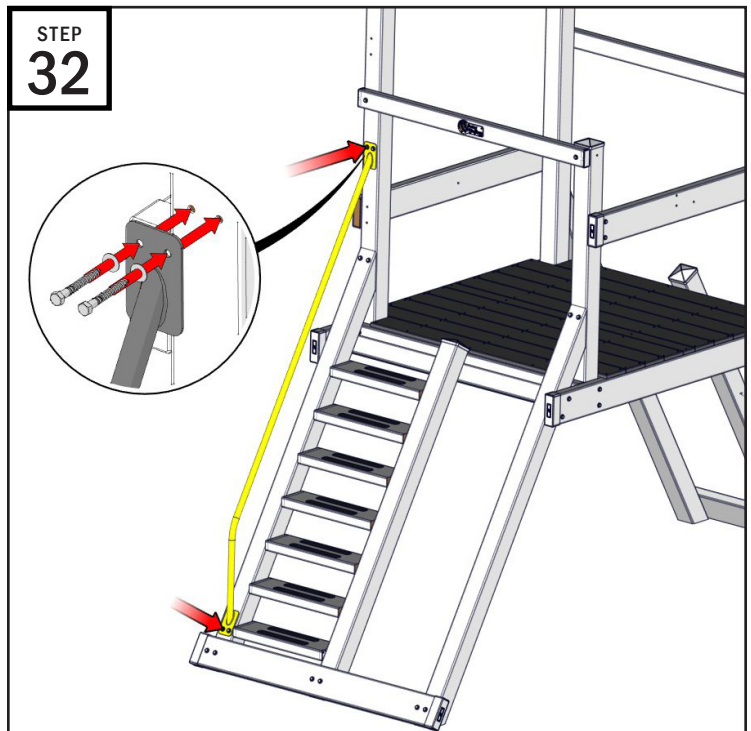

- Locate the Climber Handrail. The hardware for this will be wrapped up with the handrail.
- Place the Handrail next to the stairs with the bent end of the handrail at the bottom. Align the holes with the 4x4 post and leg.
- Use (4) 1/2" x 1 1/2" Lags & 5/16" Washers to fasten the handrail to the tower.



# ROCK WALL ASSEMBLY

STEP  
33

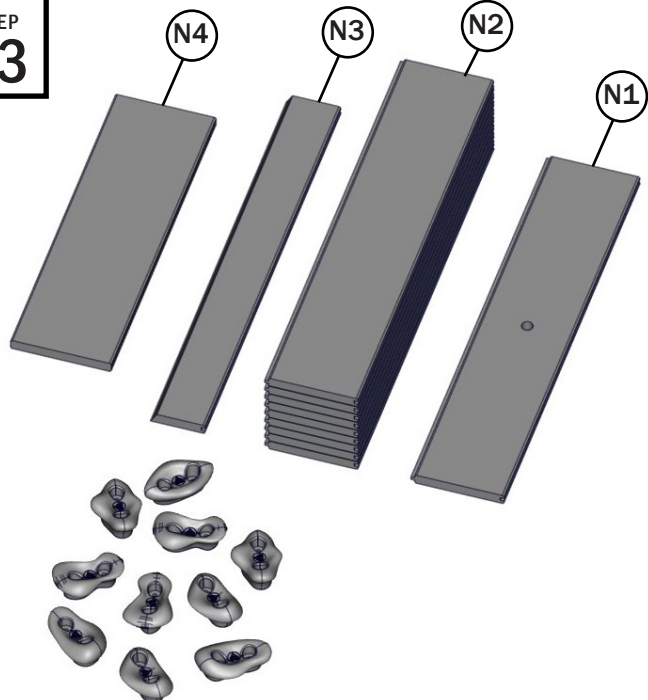

Locate and prepare the "Rock Wall Bundle" which includes...

- N1: (1) 28 1/2" Poly with End Grooves & a Center Hole
- N2: (10) 28 1/2" Poly with End Grooves
- N3: (1) 28 1/2" Poly w/ Angle Cut
- N4: (1) 22" Poly

Also locate the rock wall rocks. Continue to use the "Accessory Hardware".

STEP  
34

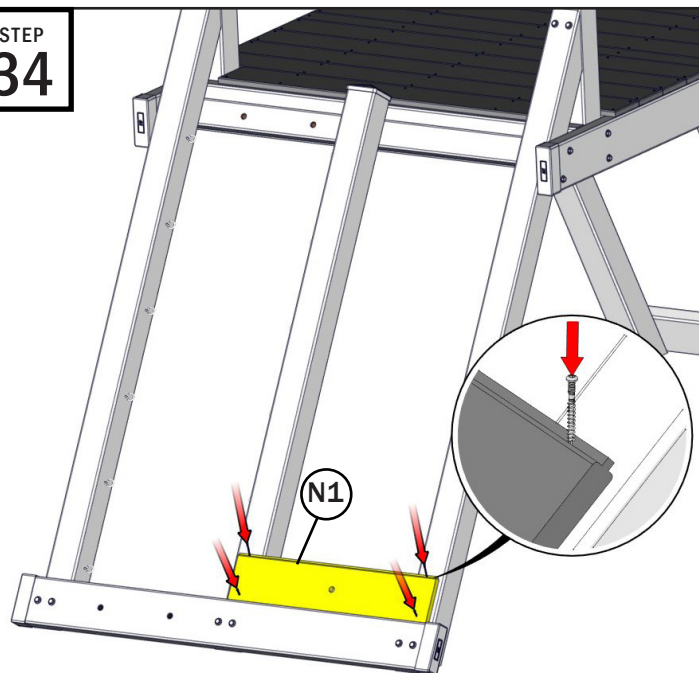

- On the back right side of the tower legs, place "N1" which has the center hole down with the male groove facing up.
- Center "N1" on the two 4x4 legs.
- Use (2) 2" Polybaster Screws at the bottom of "N1" to fasten to the 4x4 leg posts.
- To minimize the amount of visible hardware, drill (2) 2" Polybaster Screws into the top groove of "N1" at an angle.

STEP  
35

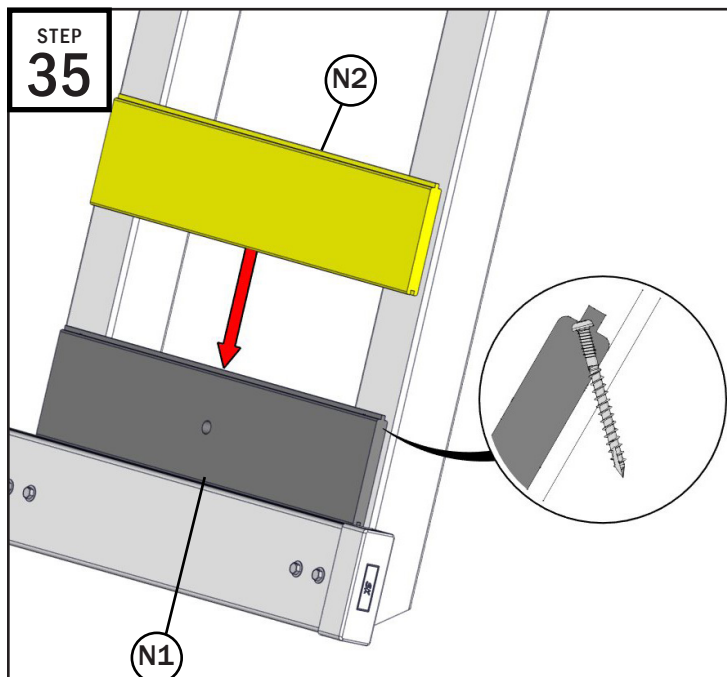

- To give enough space for the next slat, you need to drill the screw far enough so that the screw head is underneath the poly surface.
- Place "N2" on top of "N1" so that the female groove of "N2" fits over the male groove of "N1".
- Repeat the same fastening method by using (2) 2" Polybaster Screws to fasten "N2" down.

STEP  
36

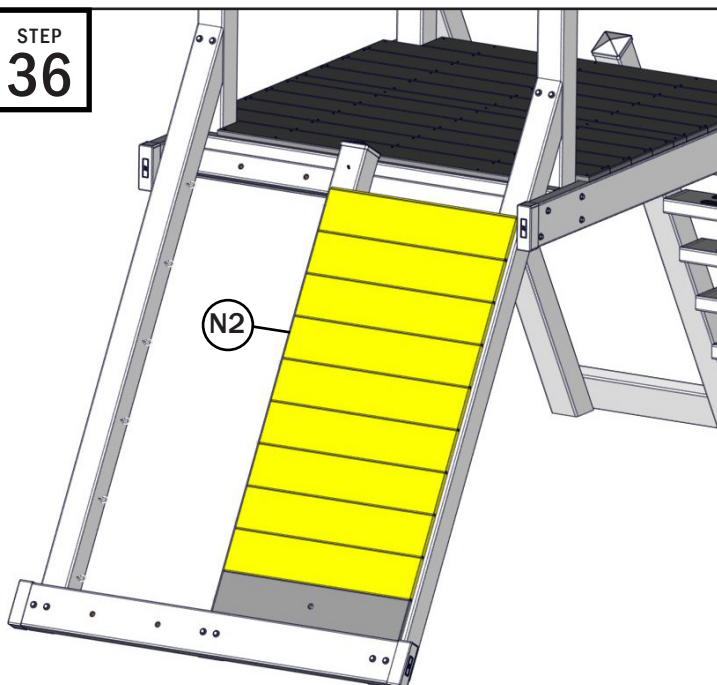

- Repeat the same process for the other (8) "N2" parts fastening them 1 by 1 as you go.

## ROCK WALL ASSEMBLY

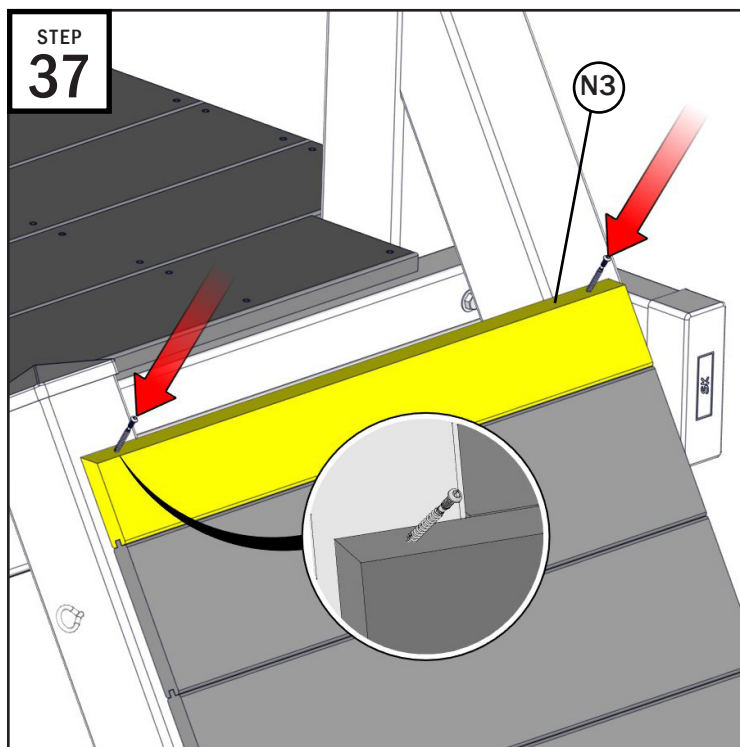

- Place "N3" on top of the top most "N2" piece.
- "N3" will have a flat end on top. You will need to angle (2) 2" Polybuster Screws to fasten "N3" to the 4x4 legs. The screw heads might be over the surface of the poly slightly.

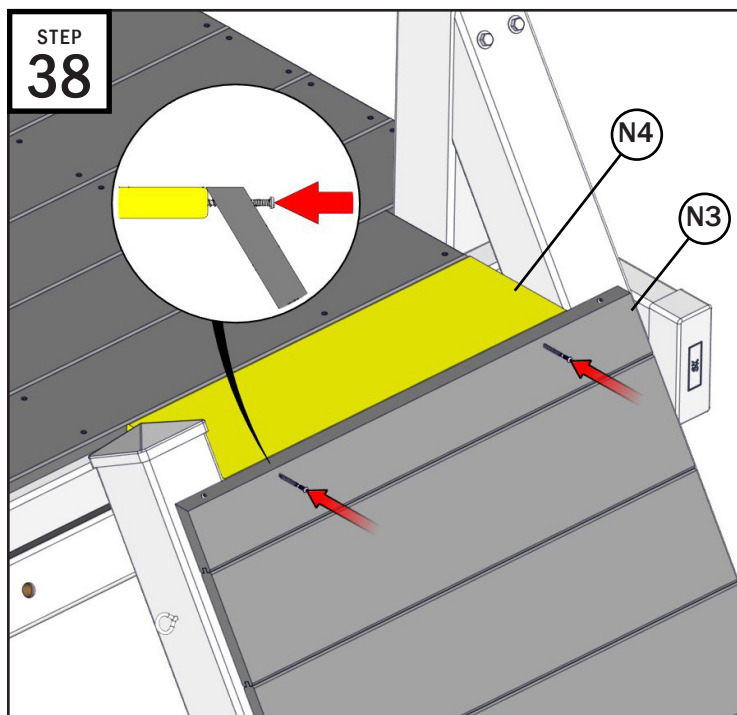

- Place "N4" between the "N3" and the floorboard decking.
- 1 person will have to fasten this board down while a 2nd will hold the board in place.
- Use (2) 2" Polybuster Screws to fasten through the front of "N3". Make sure the screws are horizontal to hit "N4" correctly.

Note: You may want to use a 3rd screw in the center for extra durability.

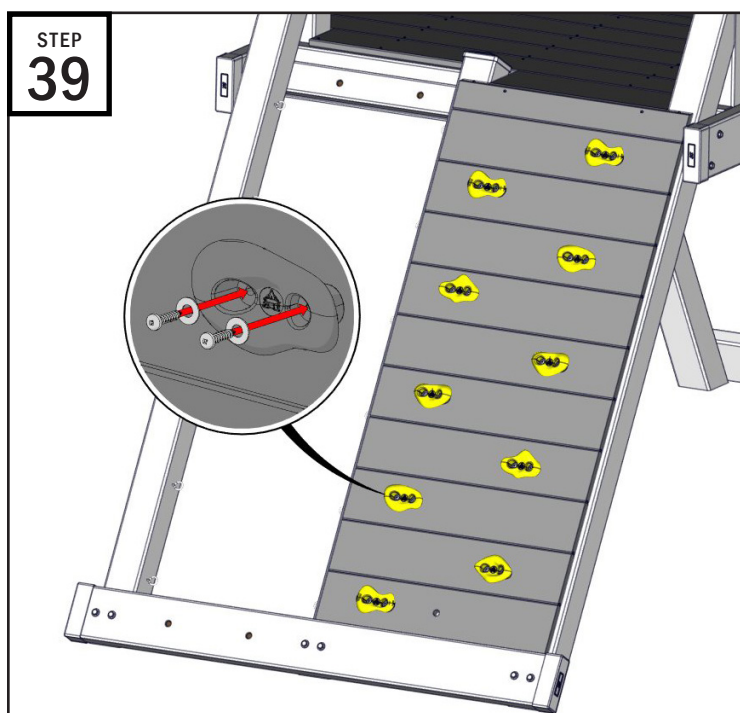

- You will have 10 thicker boards & 10 rocks. You can spread these out evenly as shown above or you can place them wherever you would like.
- One at a time, place a rock, use (1) 1/4" x 1 1/4" Pan Head Screw & 5/16" Washer, but don't fasten tightly.
- Orientate the rock to your liking (horizontal in image) & use another screw to fasten the rock the rest of the way.
- Don't forget to tighten the other side.

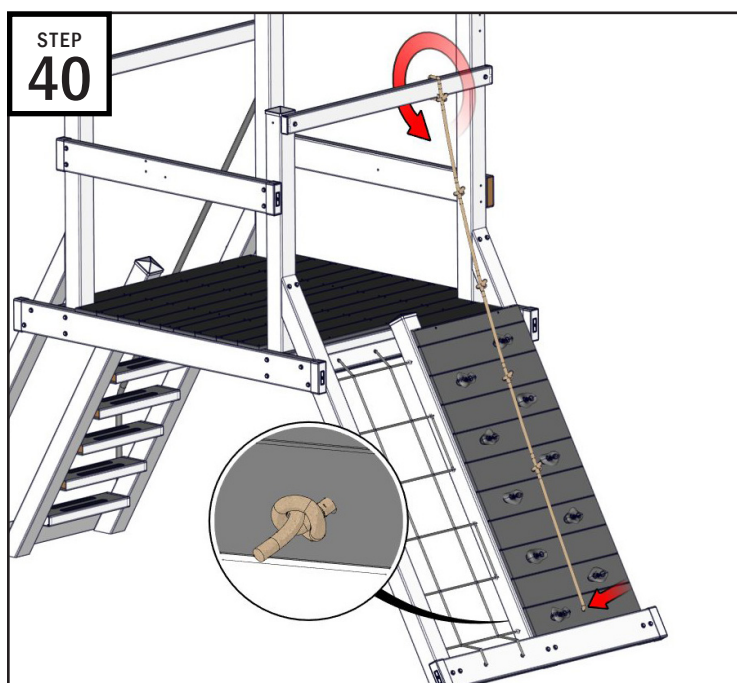

Note: Locate the 3 ropes. 2 ropes will have a 5/8" diameter when the other has 1" diameter. For this step, you will need the thicker 1" rope.

- Loop one end of the rope around the tower 2x6 railing above the rock wall and tie it to itself to fasten the rope to the tower.
- Add a few knots in the middle of the rope spaced evenly apart.
- There is a hole at by the bottom of the rock wall. Place the other end of the rope through there, leave some slack, and tie the rope in a knot on the underside of the rock wall.

## CARGO NET ASSEMBLY

STEP  
41

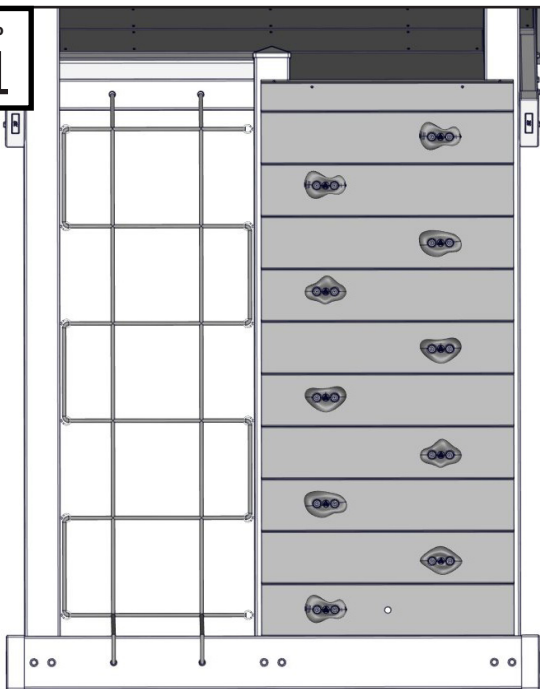

For the Cargo Net, you will utilize both of the thinner ropes (5/8" diameter).

- For the next few steps, you will need to carefully follow the steps.
- We want to have the cargo net as tight as possible, so you will want to pull the rope tight for every loop you make in the following steps.

STEP  
42

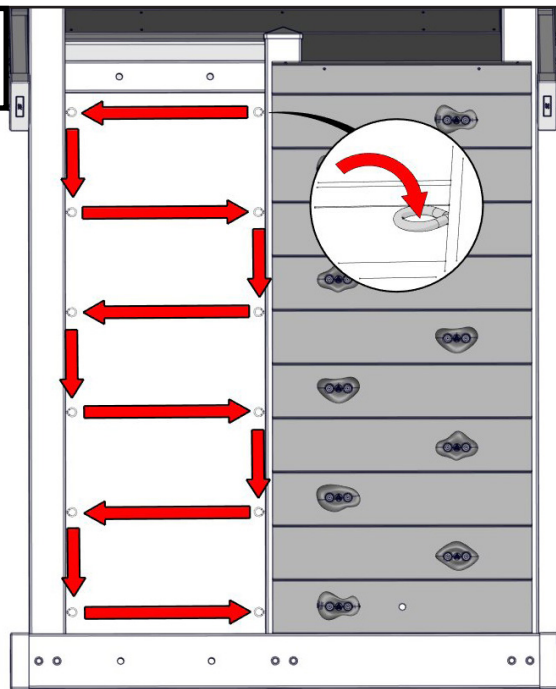

- Start at the top right eye bolt. Loop one rope through the bolt.
- Tie the end of the rope in a knot so it won't slip through the bolt.
- Following the above pattern, looping the rope through each bolt. (Go across, down, across, down, and continue until you reach the bottom.)
- The last eye bolt will be on the same side you started on. Loop the end of the rope through the bolt and knot the end of the rope pulling tight.
- Tuck any excess rope under the leg so it's out of the way.

STEP  
43

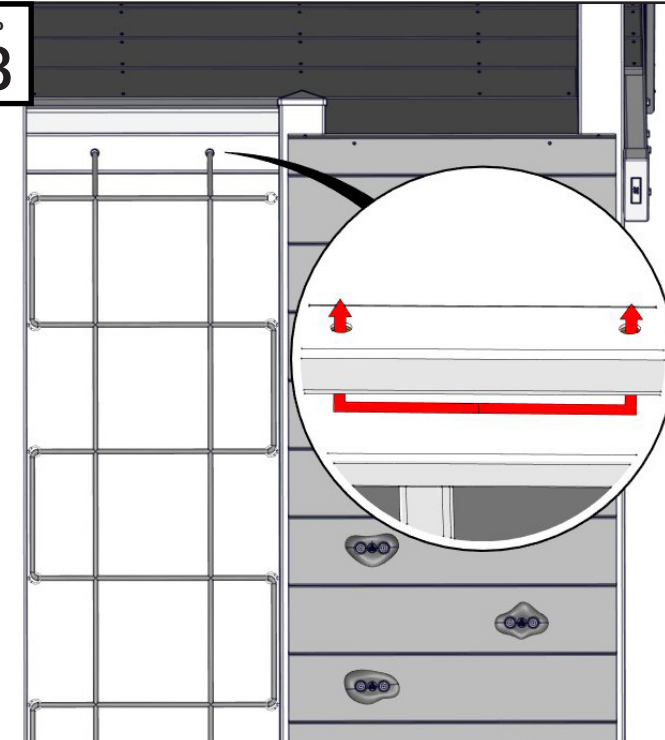

- Grab the 2nd 5/8" diameter rope.
- Go under the tower and loop the rope through the holes so that the ends of the rope will be facing away from the playset.
- Pull both ends of the rope evenly. The center of the rope will be hidden behind that top 2x4.
- Let the rope ends hang behind the eye bolt rope.

STEP  
44

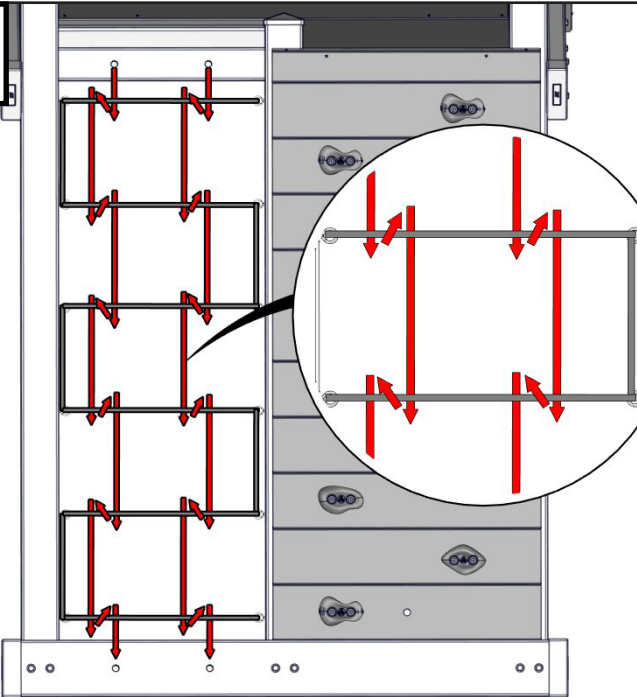

- Loop the rope around the horizontal rope. All loops will go under the horizontal rope. Alternate left and right sides for each loop.
- Both rope ends/sides will go to the same direction (right-right or left-left).
- Continue the pattern, pulling tight as you go.



## CARGO NET ASSEMBLY

STEP  
45

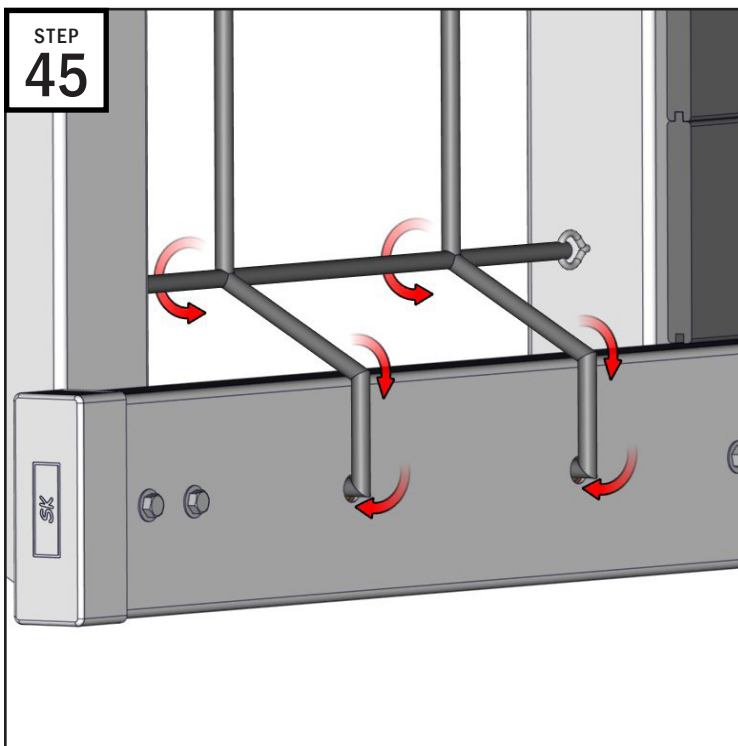

- After you finish the last loop, bring the rope over the 2x6 base.
- Run the rope ends through the holes.
- Behind the 2x6, pull the rope tight & tie a knot into both ends just like the rock wall rope.
- Tuck any excess rope under the leg so it's out of the way.

STEP  
46

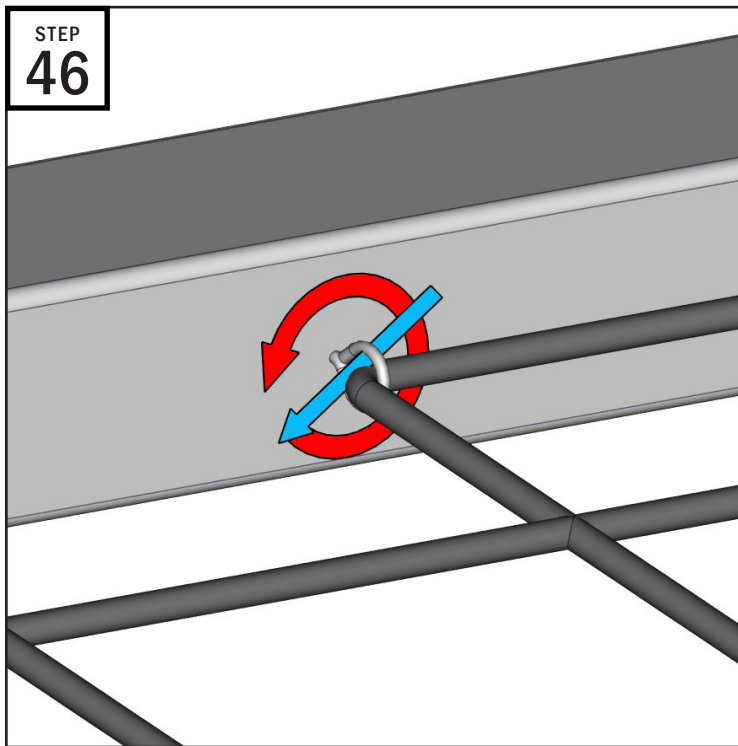

If the rope on the cargo net is loose, here is a tip to help tighten everything.

- Insert a screwdriver end through the eye bolt.
- Twist the eye bolt (It is not recommended to rotate more than 1 1/2 rotations). This will twist the rope around the eye bolts making the cargo netting tighter.
- Continue on the other eye bolts as needed.

STEP  
47

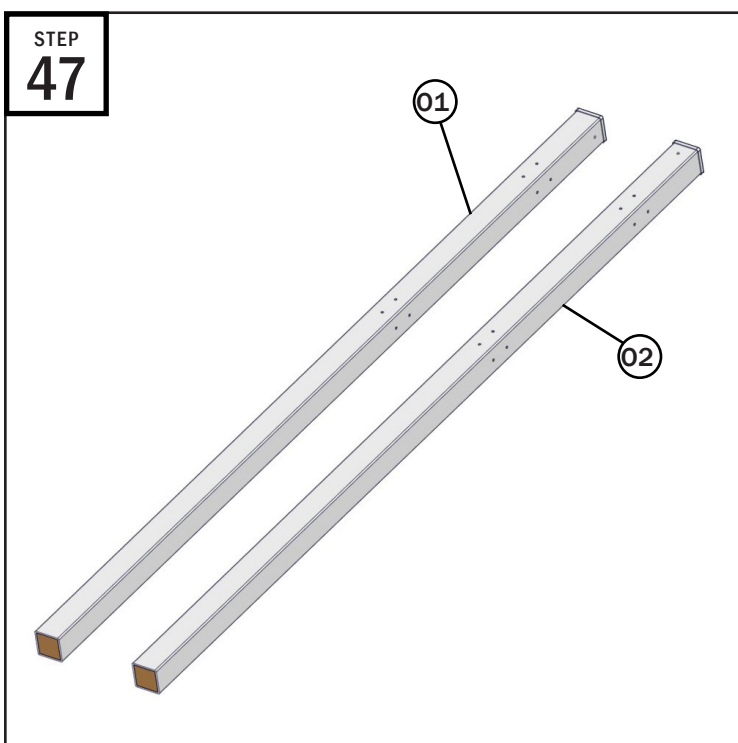

Locate the "Extension Post Bundle" which will include...

- O1: (1) 127" 4x4 Post with Top Right Hole
- O2: (1) 127" 4x4 Post with Top Left Hole

You will continue to use the tower hardware.

STEP  
48

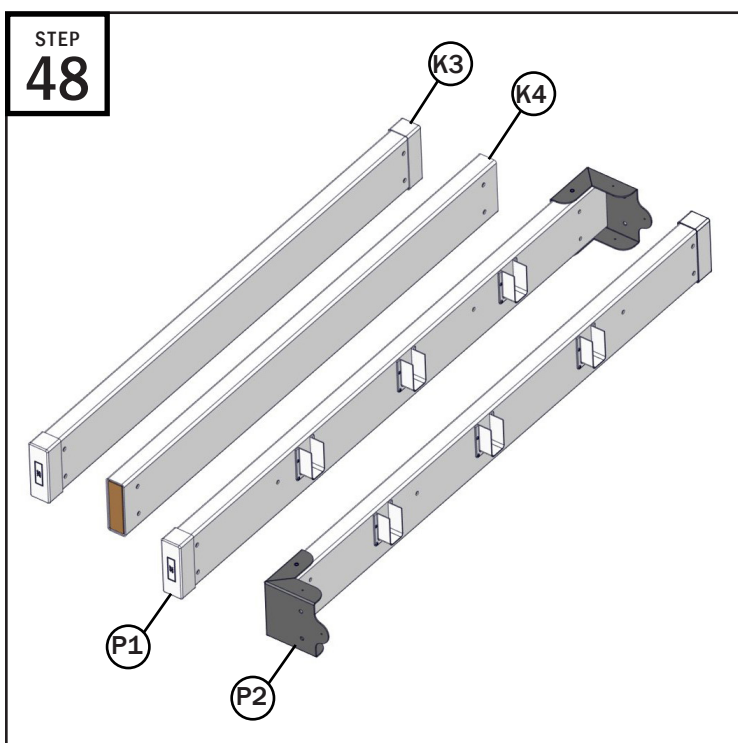

Locate the "Extension Floor Bundle" which will include...

- K3: (1) 56" 2x6 w/ End Caps
- K4: (1) 56" 2x6
- P1: (1) 64" 2x6 w/ Corner Bracket (right), End Cap, & Brace Holes
- P2: (1) 64" 2x6 w/ Corner Bracket (left), End Cap, & Brace Holes



## EXTENSION TOWER ASSEMBLY

STEP  
49

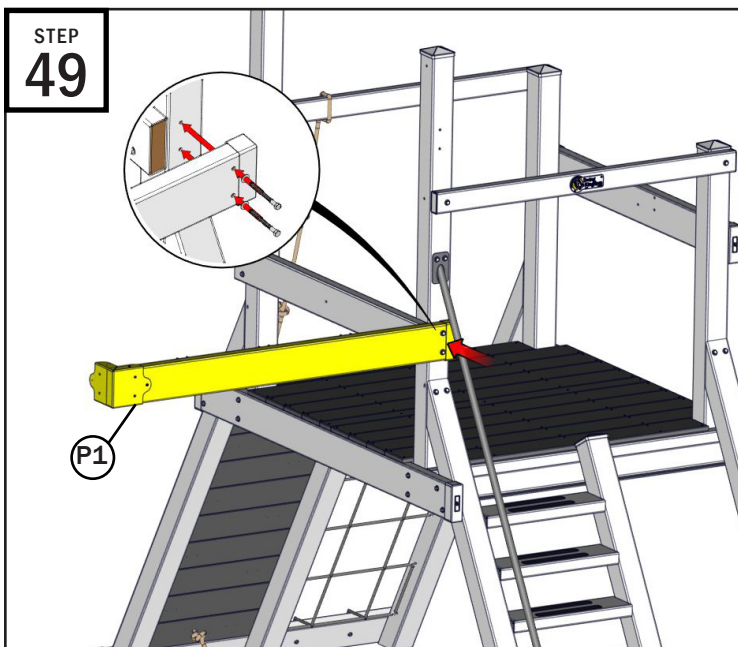

**Note: DO NOT OVER-TIGHTEN.** Fasten them enough so the parts touch.  
If the vinyl starts to dent or dimple, you know it is tight enough.

- Place "P1" on the front of the tower under the handrail with the corner bracket side facing away from the tower & the joist hangers are on the inside with the openings facing upwards.
- Use (2) 9/16" x 4" Lags & 3/8" Washers to help align & fasten "P1" to the 4x4 post on the existing tower.
- You can start fastening the other side to help find the holes for the next step if you wish.

STEP  
50

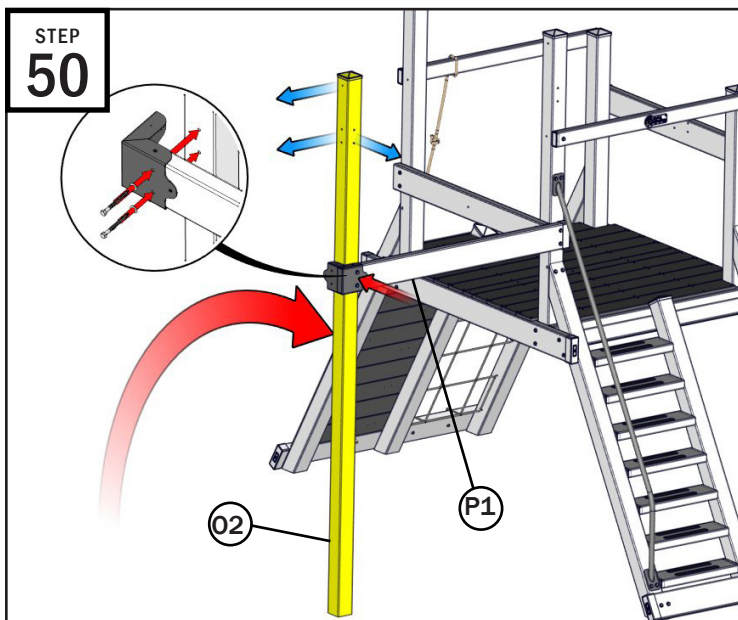

**Note: DO NOT OVER-TIGHTEN.** Fasten them enough so the parts touch.  
If the vinyl starts to dent or dimple, you know it is tight enough.

- Place "O2" on the ground and flip it up to the corner bracket side of the free hanging "P1".
- Make sure the top hole is facing away from the climber tower and there are 4 holes that line up with both sides of the corner bracket.
- Use (2) 9/16" x 4" Lags & 3/8" Washers to help align & fasten "O2" to "P1"

**Note:** Do not fasten the corner bracket side that doesn't have a 2x6 post in.

STEP  
51

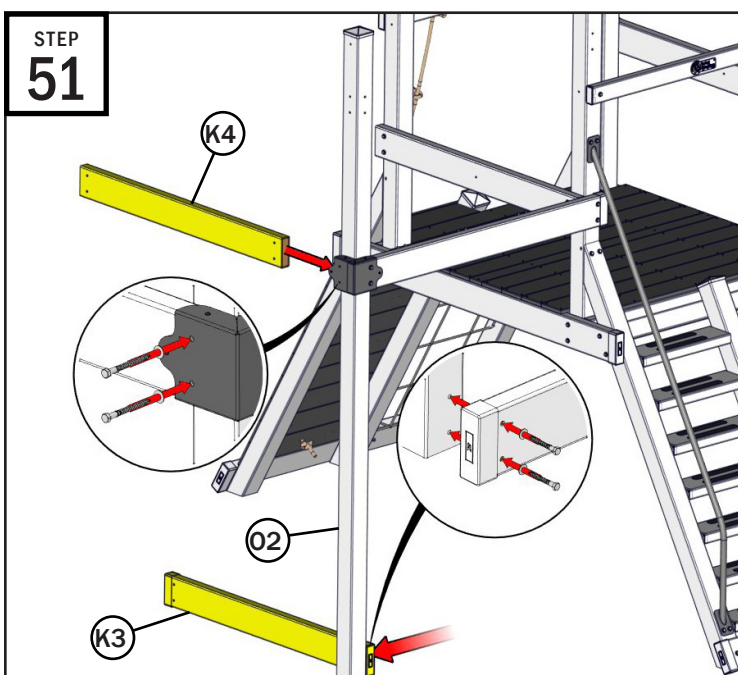

**Note: DO NOT OVER-TIGHTEN.** Fasten them enough so the parts touch.  
If the vinyl starts to dent or dimple, you know it is tight enough.

- Place "K3" at the base of "O2".
- Place "K4" inside the corner bracket opening.
- Line up the holes on each & fasten them together using (4) 9/16" x 4" Lags & 3/8" Washers.

STEP  
52

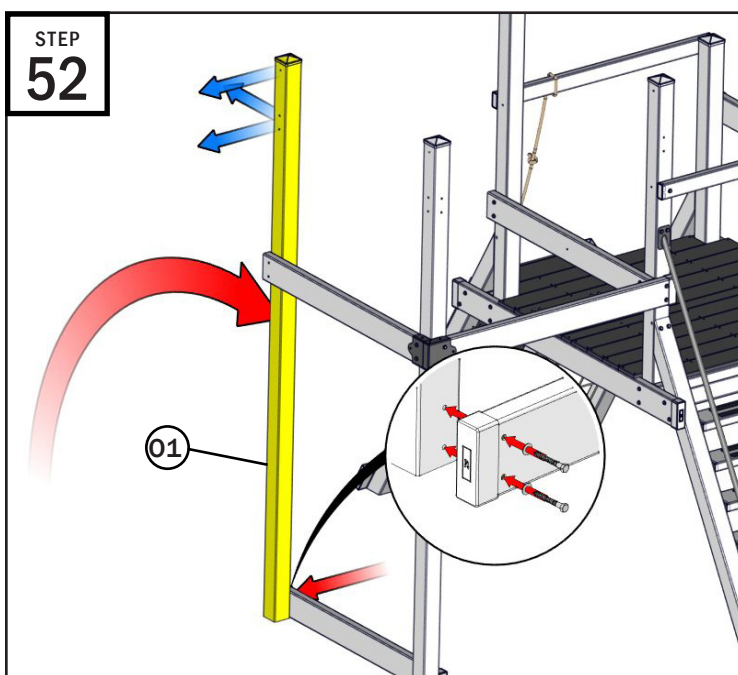

**Note: DO NOT OVER-TIGHTEN.** Fasten them enough so the parts touch.  
If the vinyl starts to dent or dimple, you know it is tight enough.

- Place the base of "O1" outside the other end of the 2x6 base.
- Flip "O1" up with the top hole facing away from the tower & the side holes are facing away from the tower & backwards.
- There will be 2 bottom holes that line up with the 2x6 base.
- Use (2) 9/16" x 4" Lags & 3/8" Washers to fasten the base.

## EXTENSION TOWER ASSEMBLY

STEP  
53

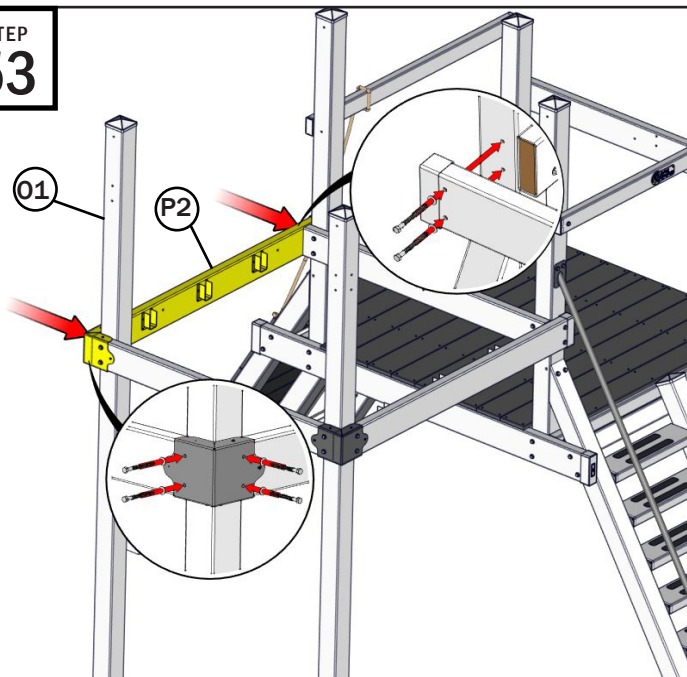

**Note: DO NOT OVER-TIGHTEN.** Fasten them enough so the parts touch.  
**If the vinyl starts to dent or dimple, you know it is tight enough.**

- Place "P2" with the corner bracket around "O1" & the end cap side on the climber tower. The joist hangers will be facing inwards to the tower & the joist openings are facing upwards.
- Use (6) 9/16" x 4" Lags & 3/8" Washers to fasten "P2" to "O2" & to the climber tower.

STEP  
54

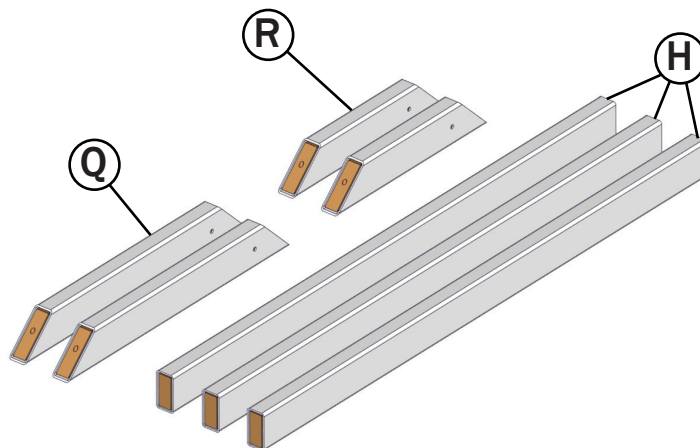

Locate the "Extension Post Bundle" which will include...

- H: (3) 55 3/4" 2x4 Joist
- Q: (2) 28" 2x4 Brace
- R: (2) 19" 2x4 Brace

STEP  
55

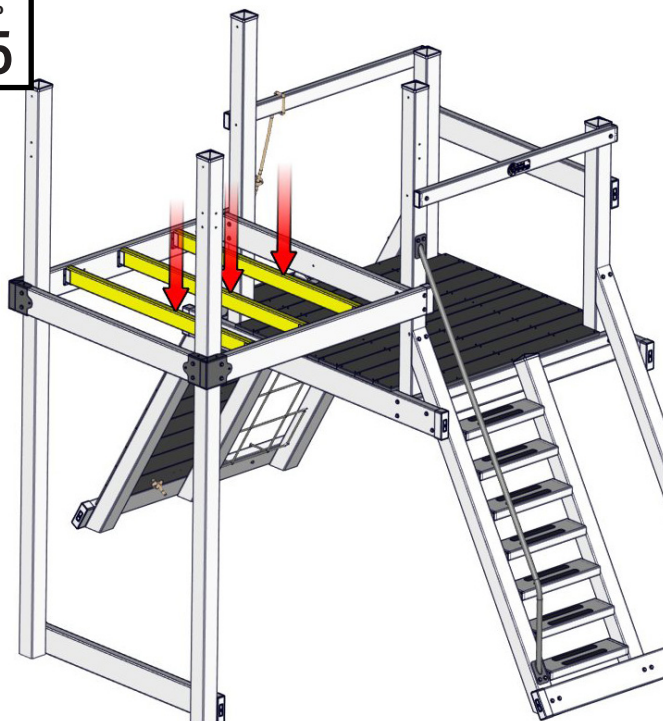

- Place "H" in the joist hanger slots.

STEP  
56

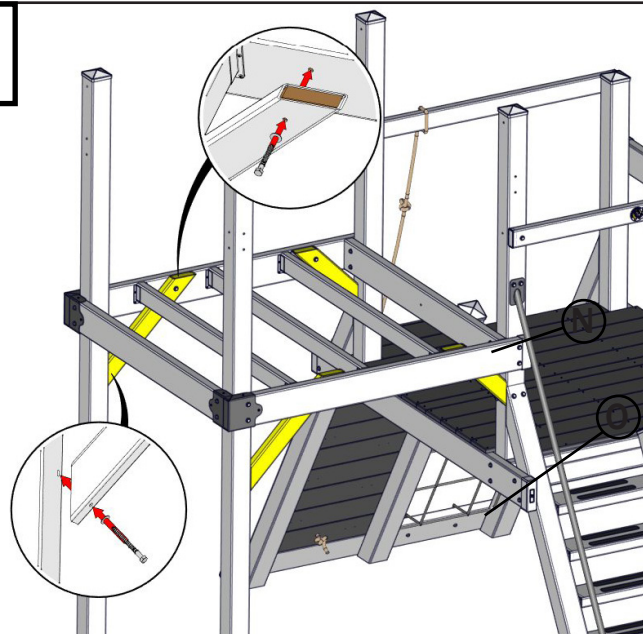

**Note: DO NOT OVER-TIGHTEN.** Fasten them enough so the parts touch.  
**If the vinyl starts to dent or dimple, you know it is tight enough.**

- Place the braces with the end holes facing down and the side holes on top. The larger Braces (Q) will be away from the tower while the shorter Braces (R) will be closest to the climber tower.
- One brace at a time, you will use (1) 9/16" x 4" Lags & 3/8" Washers to fasten the bottom of the brace to the 4x4 post.
- Then use, (1) 9/16" x 3" Lags & 3/8" Washers to fasten the side top, side of the brace to the 2x6 tower framing.



## EXTENSION TOWER ASSEMBLY

STEP  
57



Locate and prepare the "Floorboard Bundle" which includes...

- M1: (1) 3 3/8" x 59 1/2" Floorboard
- M2: (8) 5 1/2" x 59 1/2" Floorboard
- M4: (2) 5 1/2" x 53 3/4" Floorboard

You will continue to use the "Floor Hardware" bag.

STEP  
58

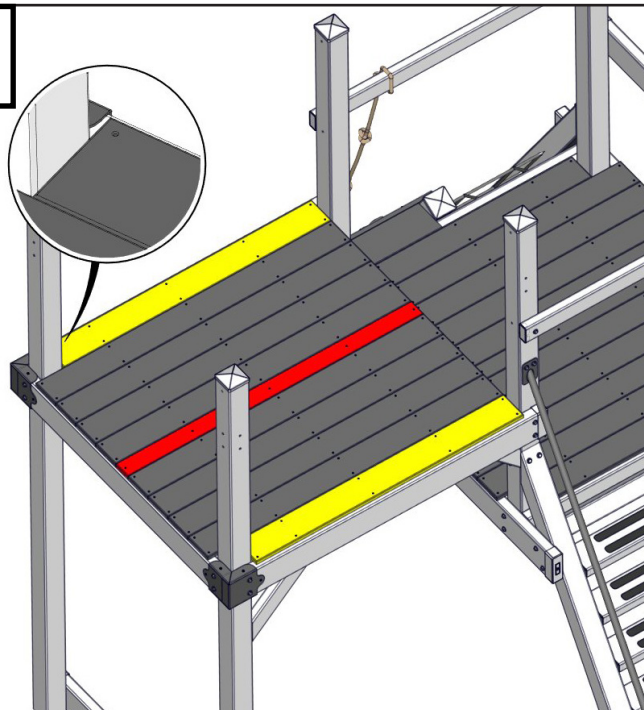

- Place the (8) "M2"s perpendicular from the joists below them.
- Place "M1" in the center of the tower.
- Place the (2) "M3"s on the sides. Make sure the corners with the pre-punched holes are facing outward.
- Center the floorboards. The boards are not 100% accurate. Run your fingers along both sides of the floorboards and adjust them one by one to make them as centered as possible.

STEP  
59

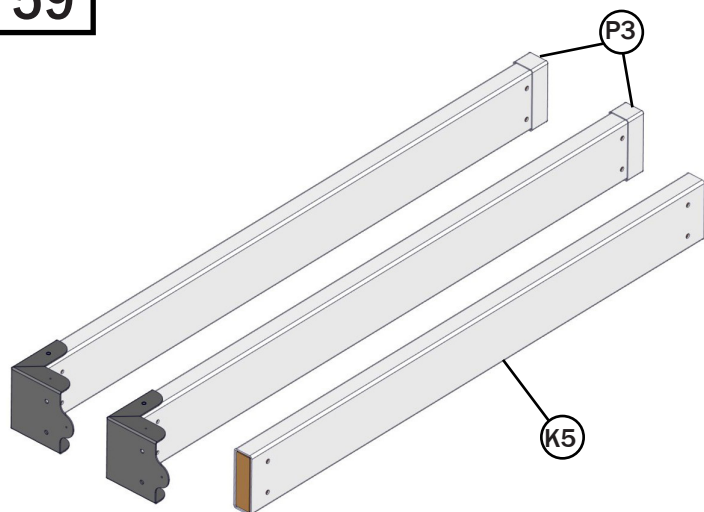

Locate and prepare the "Extension Railing Bundle" which includes...

- K5: (1) 56" 2x6 w/ Roof Partial-Hole
- P3: (2) 64" 2x6 w/ Corner Bracket & End Cap

STEP  
60

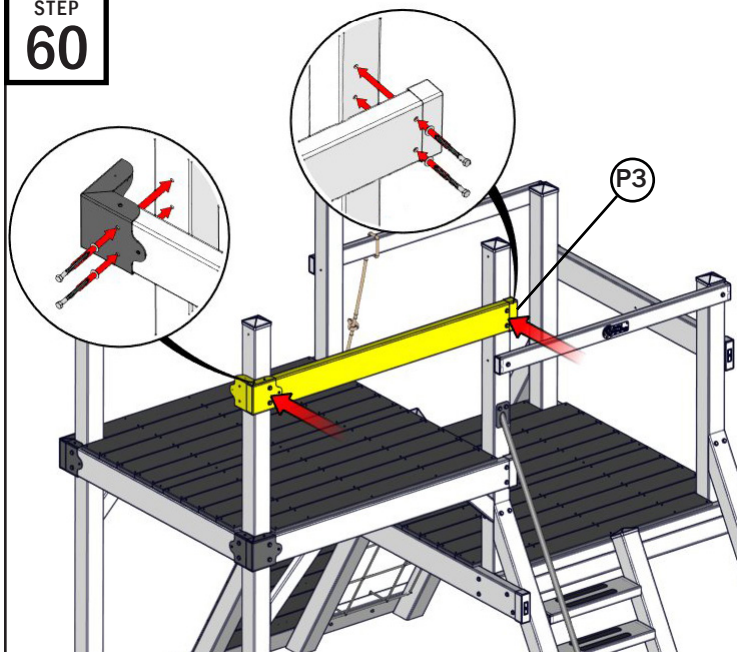

**Note: DO NOT OVER-TIGHTEN.** Fasten them enough so the parts touch. If the vinyl starts to dent or dimple, you know it is tight enough.

- Place one of the "P3" items on the front of the tower with the end cap on the climber tower side.
- Using (4) 9/16" x 4" Lags & 3/8" Washers, drill into the large holes of the 2x6 so that the tip of the lags are showing on the other side.
- Use the tip of the lags to find the holes on the 4x4 posts.
- Fasten the Lags the into the 4x4 post.

# EXTENSION TOWER ASSEMBLY - SWING FRAME ASSEMBLY

STEP  
61

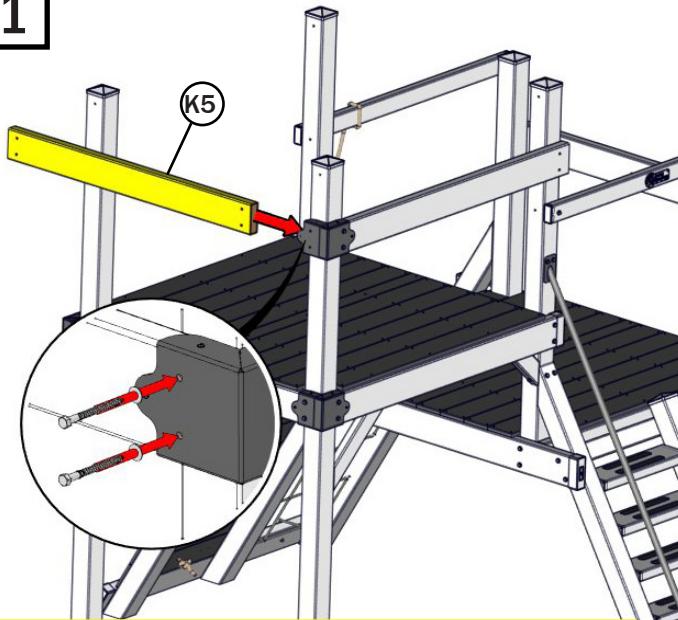

**Note: DO NOT OVER-TIGHTEN.** Fasten them enough so the parts touch.  
**If the vinyl starts to dent or dimple, you know it is tight enough.**

- Place "K5" inside the corner bracket opening. Make sure the partial hole is facing inward on the tower.
- Line up the holes on "K5" with the corner bracket.
- Finish fastening the front corner bracket with (2) 9/16" x 4" Lags & 3/8" Washers.

STEP  
62

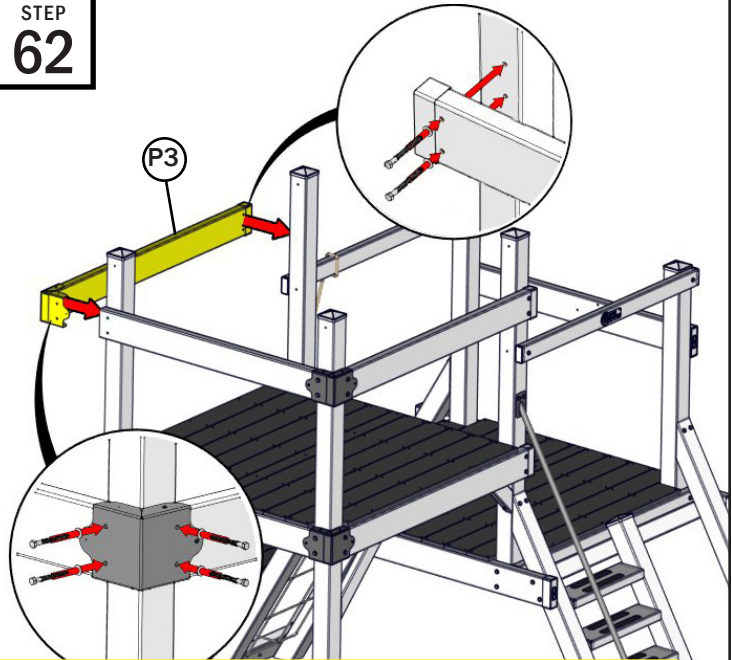

**Note: DO NOT OVER-TIGHTEN.** Fasten them enough so the parts touch.  
**If the vinyl starts to dent or dimple, you know it is tight enough.**

- Place the other "P3" with the corner bracket fitting around "K5" & the end cap side closer to the climber tower.
- Use (6) 9/16" x 4" Lags & 3/8" Washers align and fasten this piece with the tower.

STEP  
63

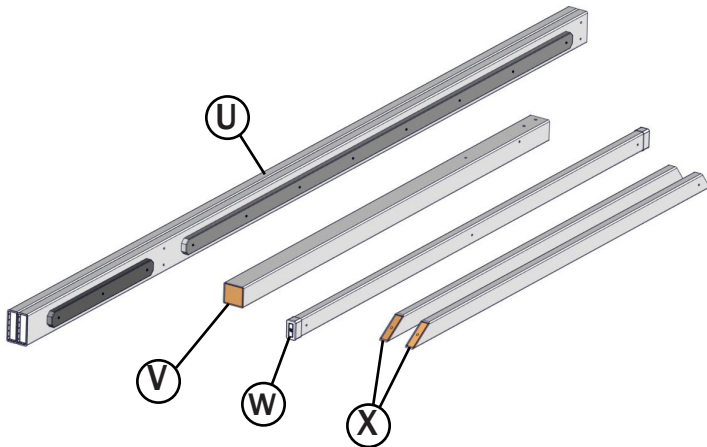

Locate the "Swing Beam" & "Swing Frame" Bundles which will include:

- P: (1) 126" Swing Beam (The only item in the Swing Beam Bundle.)
- Q: (1) 92" 4x4 Post
- R: (1) 106" 2x4 Ground Runner
- S: (2) 89" 2x4 Brace

Also locate the "Swing Frame" & "Swing Hook" Hardware bags.

STEP  
64

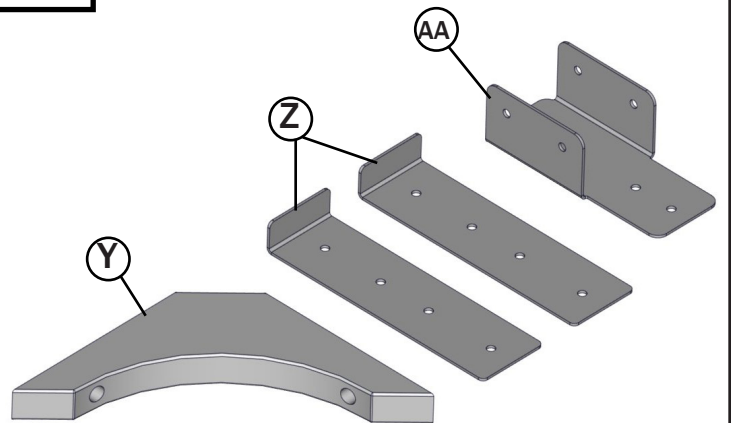

You will also want to locate the "Swing Support Bundle" which includes:

- T: (1) Poly Brace
- U: (2) Swing Beam Post Plate
- V: (1) Swing Beam Bracket



# SWING FRAME ASSEMBLY

STEP  
65

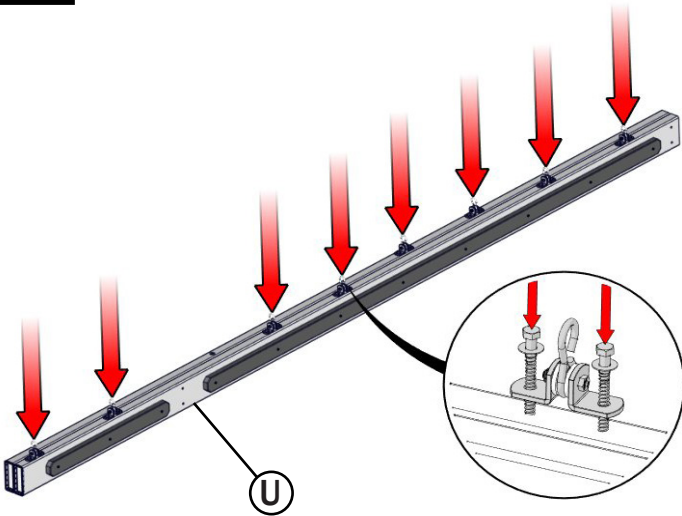

- Place "U" on the ground with the holes facing upwards.
- Open the "Swing Hook Hardware" bag.
- Place the swing bearings aligning them with the pre-drilled double holes. Ignore the single hole towards one of the ends for now.
- Fasten the bearings using (12) 9/16" x 4" Lag (2 per bearing).

STEP  
66

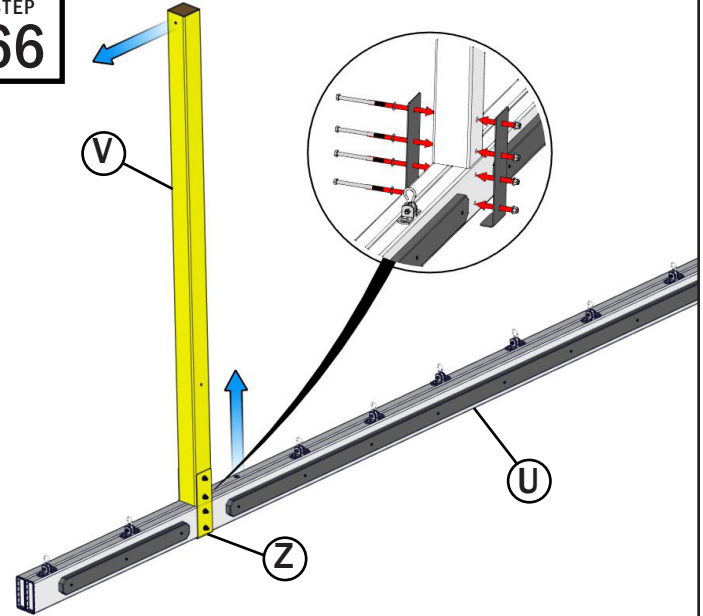

**Note: DO NOT OVER-TIGHTEN.** Fasten them enough so the parts touch.  
**If the vinyl starts to dent or dimple, you know it is tight enough.**

- Place "V" on top of "U" on the side of the single hole. "V" has a hole on one end that is centered. Make sure that hole is on the opposite and is facing away from "U"
- Place both "Z"s on each side of "U" & "V" aligning the holes as shown with the short end of "Z" going underneath "U".
- Fasten them together using (4) 9/16" x 5" Bolts, (8) 3/8" Washers and (4) 9/16" Locking Nuts.

STEP  
67

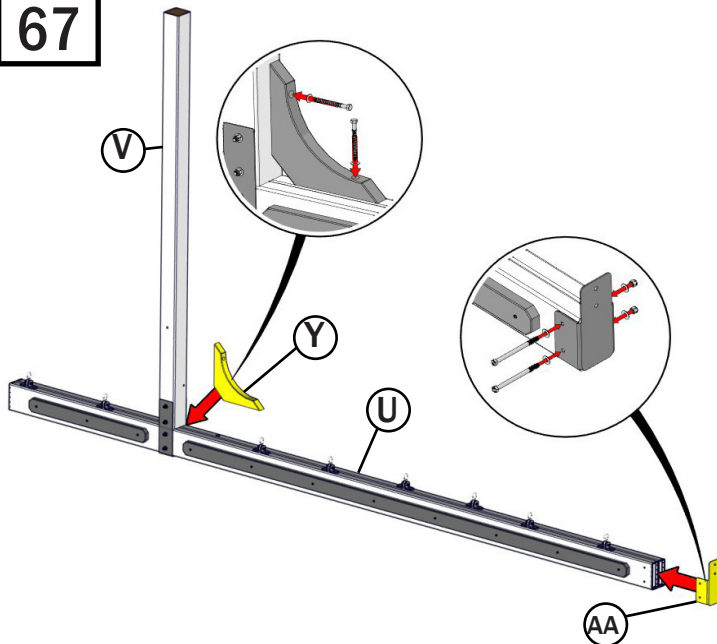

- Place "Y" in the corner between "V" & "U" aligning the holes of "Y" with the single holes on "V" & "U".
- Fasten "Y" using (2) 9/16" x 4" Lags & 3/8" Washers.
- Slide "AA" on the other side of "U" aligning the side holes on both. Make sure the straight section on "AA" faces upwards.
- Fasten "AA" to "U" using (2) 9/16" x 5" Bolts, (4) 3/8" Washers and (2) 9/16" Locking Nuts.

STEP  
68

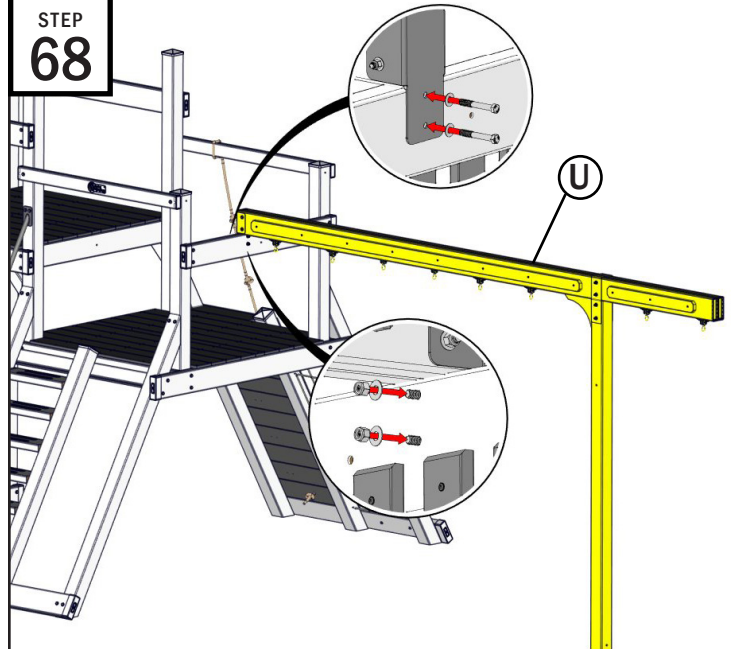

**Note: DO NOT OVER-TIGHTEN.** Fasten them enough so the parts touch.  
**If the vinyl starts to dent or dimple, you know it is tight enough.**

- Flip the Swing Frame upright and rest the unsupported end of "U" on the railing of the tower with the bracket on the inside of the tower.
- Align the holes on the bracket with the holes on the 2x6 Railing.
- Fasten them together using (2) 9/16" x 2 3/4" Bolts, (4) 3/8" Washers and (2) 9/16" Locking Nuts.

## SWING FRAME ASSEMBLY - ROOF ASSEMBLY (1)

STEP  
69

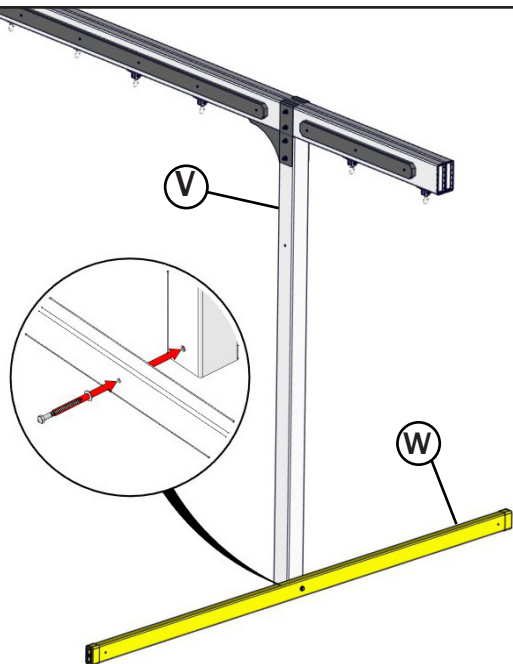

**Note: DO NOT OVER-TIGHTEN.** Fasten them enough so the parts touch.  
**If the vinyl starts to dent or dimple, you know it is tight enough.**

- Place "W" on the ground on the outside of "V".
- Align the center hole on "W" with the hole at the bottom of the "V".
- Fasten together using (1) 9/16" x 4" Lags & 3/8" Washers.

STEP  
70

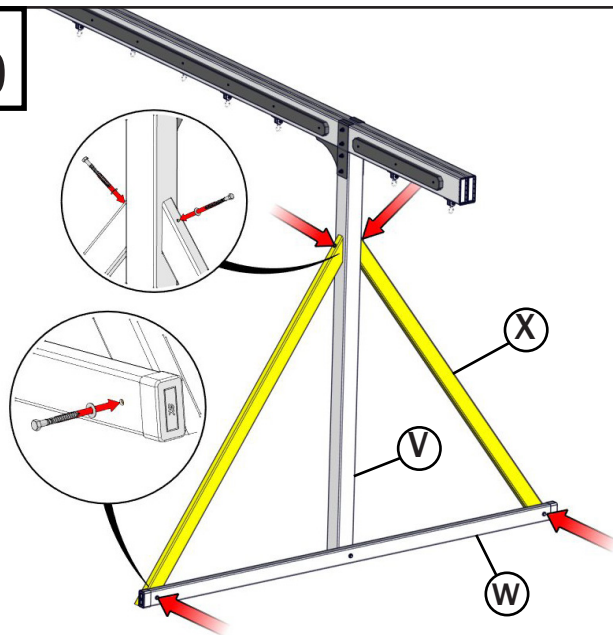

**Note: DO NOT OVER-TIGHTEN.** Fasten them enough so the parts touch.  
**If the vinyl starts to dent or dimple, you know it is tight enough.**

- Place the (2) "X" braces on both side of the "V". Align the pre-drilled holes. You may need to flip the ends if the holes don't line up.
- Fasten the top of "X" to the 4x4 Post using (2) 9/16" x 4" Lags & 3/8" Washers.
- Fasten the bottom of "X" ends to the "W" 2x4 using (2) 9/16" x 3" Lags & 3/8" Washers.

STEP  
71

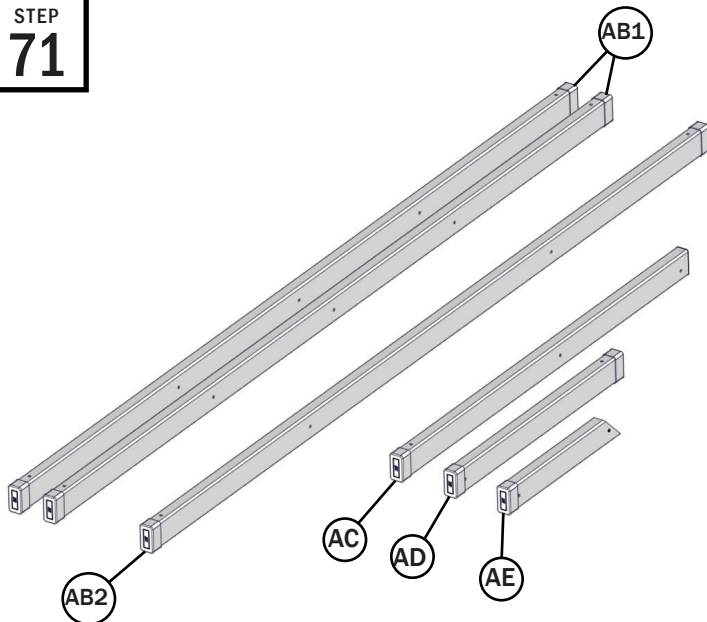

Locate and prepare the "Roof Railing Bundle 1 & 2" which includes...

- AB1: (2) 120" Roof 2x4 Railing
- AB2: (1) 120" Roof 2x4 Railing w/ Center Partial Hole
- AC: (1) 61 5/8" 2x4 Railing
- AD: (1) 35 3/4" 2x4 Railing
- AE: (1) 24" 2x4 Brace

You will continue to use the "Roof Hardware" bag.

STEP  
72

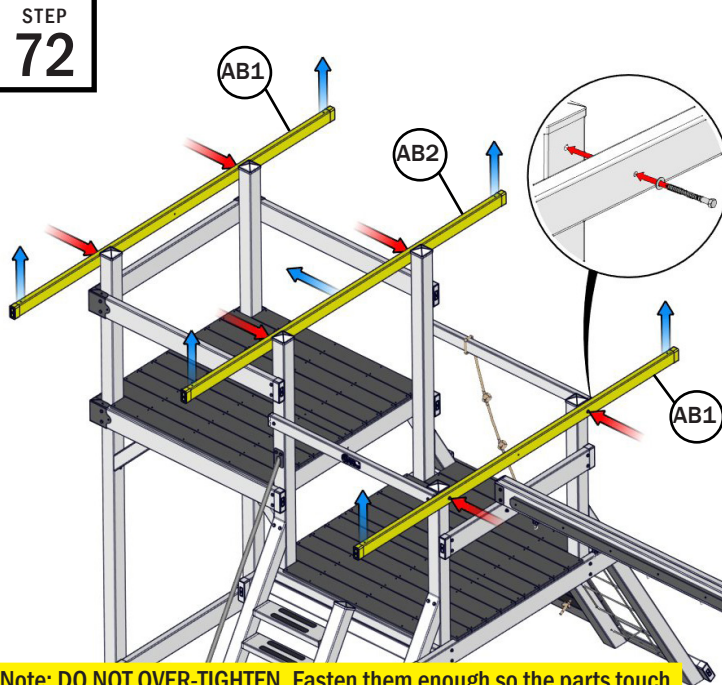

**Note: DO NOT OVER-TIGHTEN.** Fasten them enough so the parts touch.  
**If the vinyl starts to dent or dimple, you know it is tight enough.**

- One at a time, place both the roof railings at the top of the 4x4 posts with the end holes facing upwards. Both "AB1"s will be on the outside of the tower. "AB2" will be in the center with the center hole facing the extension tower.
- Fasten each item using (2) 9/16" x 4" Lags & 3/8" Washers.



## ROOF ASSEMBLY (1)

STEP  
73

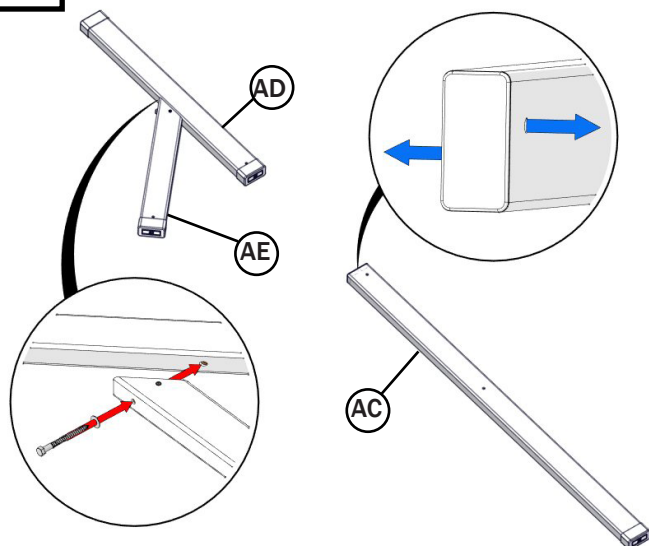

- “AC” will have an end cap on one end with 2 different holes on the sides. The upper hole will be on the extended tower side when the lower hole will be on the climber tower side.
- “AE” will get fastened to “AD” with (1) 9/16” x 4” Lags & 3/8” Washers. Make sure “AE” is on the same side as “AD” that has the through hole on the side of it. “AD” will have a hole on the top of it. That will be on the opposite end facing away from “AE”.

STEP  
74

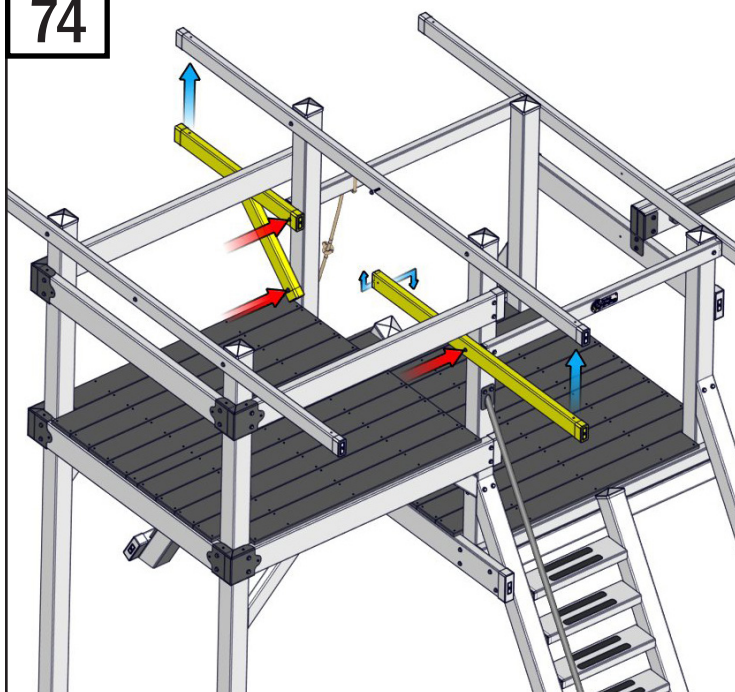

- As oriented in the previous step, you will place them on the extension tower the same way. Make sure the end holes are facing upwards and will be on the outside of the towers.
- Using (3) 9/16” x 4” Lags & 3/8” Washers, fasten the items to the tower.

STEP  
75

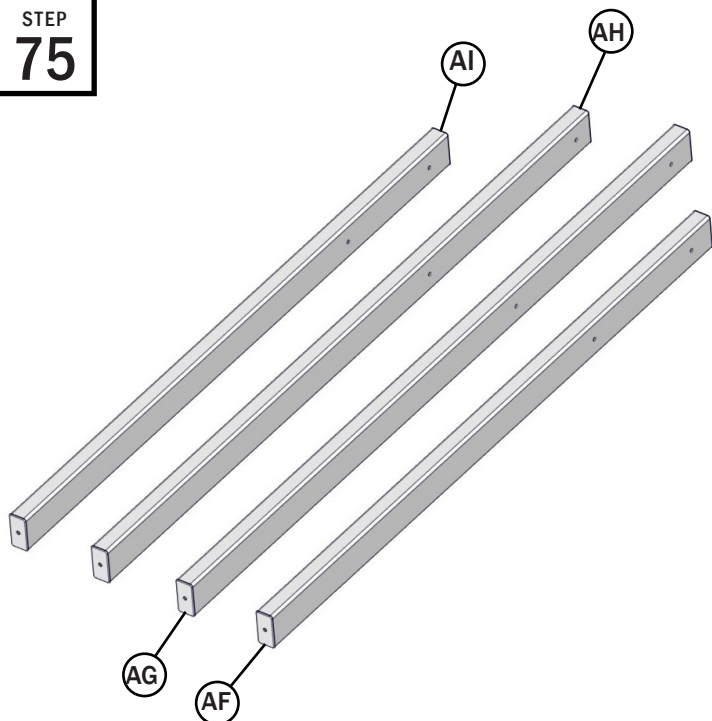

Locate and prepare the “Roof Vertical Bundle” which includes...

- AF: (1) 64 1/8” Roof 2x4 Vertical
- AG: (1) 72 7/8” Roof 2x4 Vertical
- AH: (1) 70 1/2” Roof 2x4 Vertical
- AI: (1) 61 3/4” Roof 2x4 Vertical

Note all lengths and holes. It is important to get all items in the right place.

STEP  
76

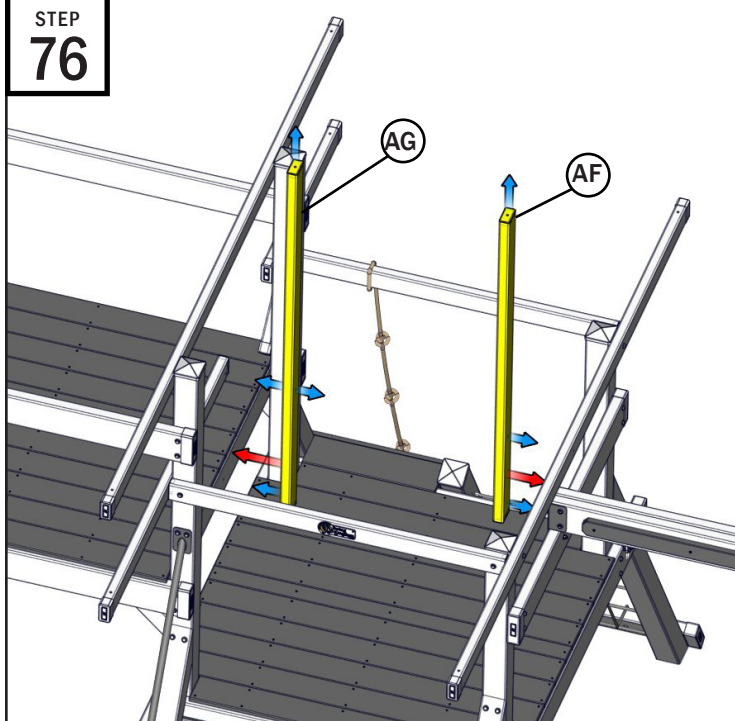

- Place “AF” & “AG” (the longest & 2nd shortest 2x4) on the inside of the climber tower. The end holes on both will be facing upwards.
- “AF” has 2 holes towards the bottom on one side. Those holes will be facing outwards and “AF” will go on the right side of the climber tower.
- “AG” has 2 holes towards the bottom. The bottom most hole is on one side. That side will go against the railings.

## ROOF ASSEMBLY (1) - POLY SLAT ASSEMBLY

STEP  
77

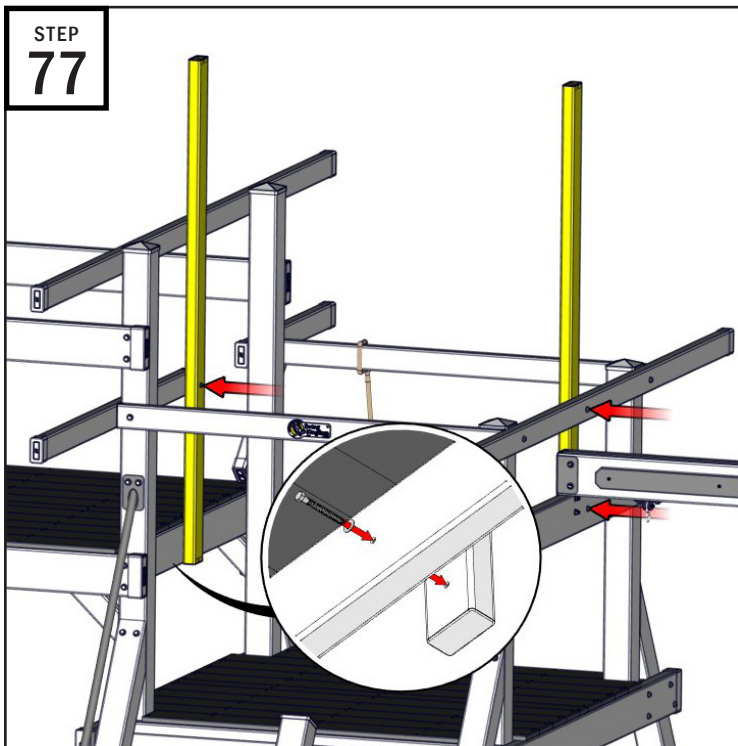

- Using (4) 9/16" x 3" Lags & 3/8" Washers, fasten "AF" & "AG" to the tower.
- All screws will go in through the right side of the tower except bottom left, which will go through the left side (under the extension tower)

STEP  
78

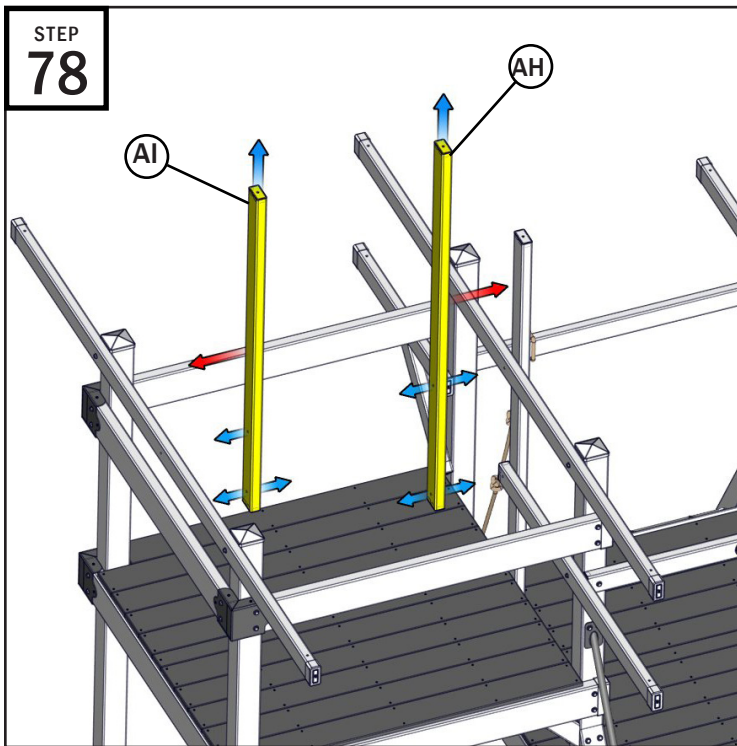

- Place "AH" & "AI" (2nd longest & the shortest 2x4) on the inside of the extended tower. The end holes on both will be facing upwards.
- "AH" will go on the right side towards the climber tower. The holes on this are through holes, so the orientation does not matter.
- "AI" has 2 holes towards the bottom. The upper hole is only on one side, which will go against the railings on the left side of the tower.

STEP  
79

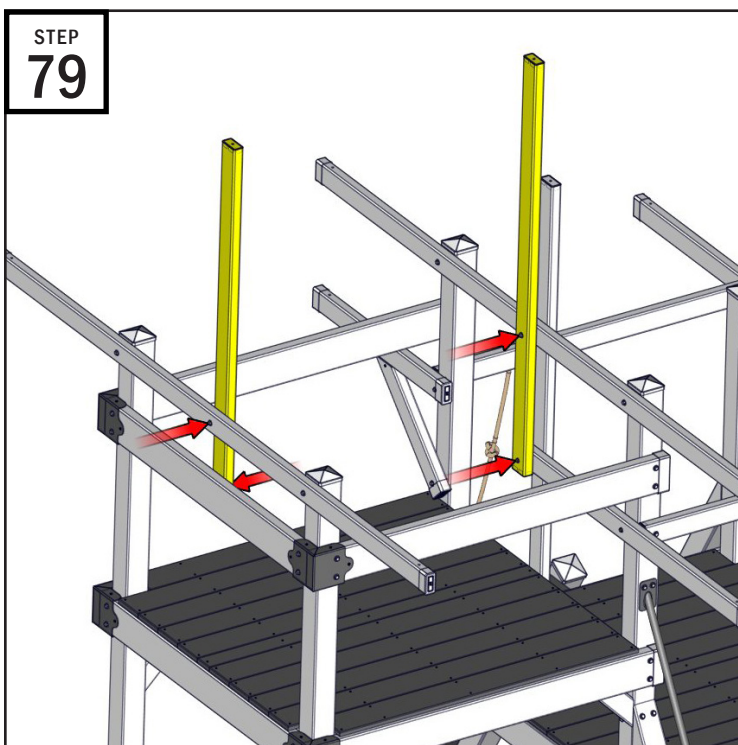

- Using (4) 9/16" x 3" Lags & 3/8" Washers, fasten "AH" & "AI" to the tower.
- All screws will go in through the left side of the tower except bottom left, which will go through the right side.

STEP  
80

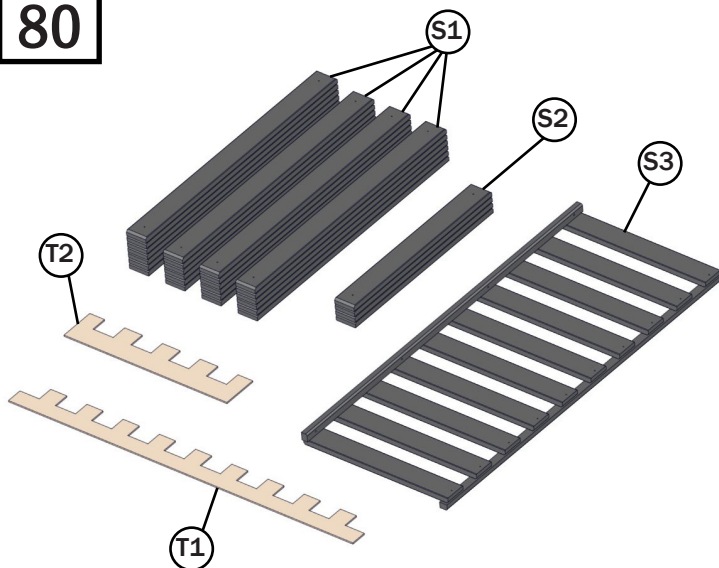

Locate the "Poly Slat Bundle" & the Slat Templates which will include...

- S1: (25) 3/4" x 2 5/8" x 33 3/8" Poly Slats
- S2: (4) 3/4" x 2 5/8" x 24" Poly Slat
- S3: (1) Poly Slat Assembly
- T1: (1) 5x5 Poly Slat Template
- T2: (1) Extension Poly Slat Template

Also locate the "Poly Slat Hardware" bag.



## POLY SLAT ASSEMBLY

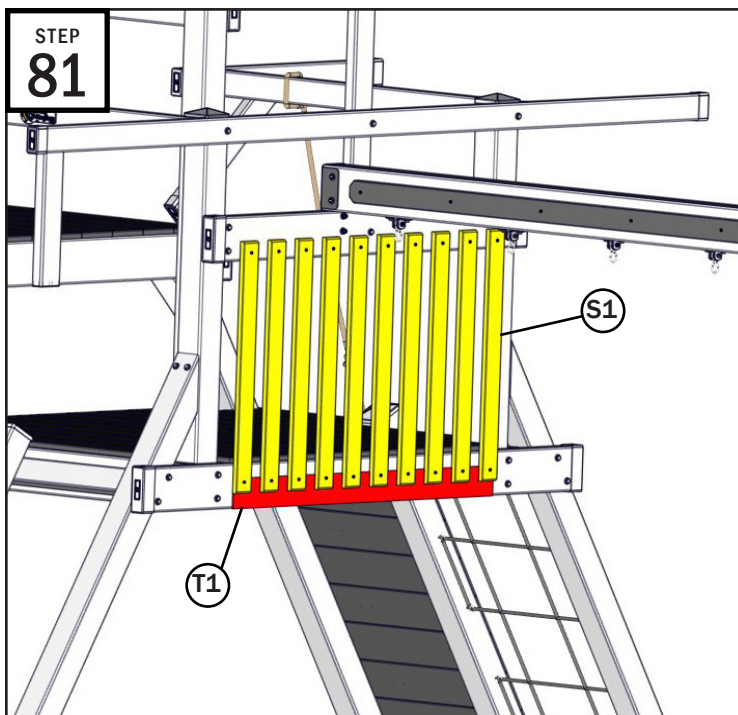

STEP  
81

- Use the #2 Square Drive Bit, drill 2" Washer Head Screws into "T1" just enough so it is not or barely protruding through the other side.
- On the right side of the tower, place "T1", aligning the bottom flush with the bottom of the 2x6 and center on the tower. Have a 2nd person or use a clamp to hold "T1" securely.
- One at a time, place "S1" in the groove of "T1" and fasten the bottom screw into the 2x6.

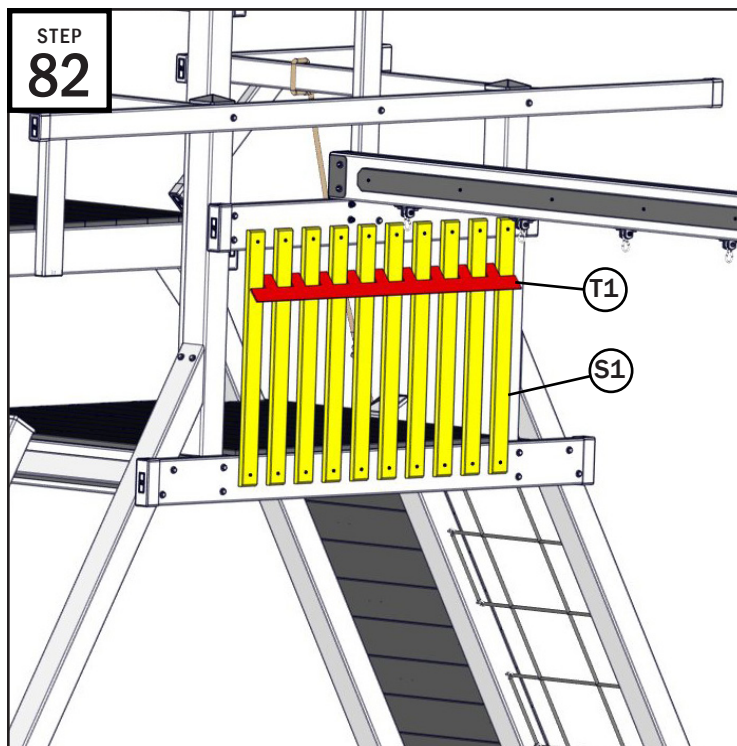

STEP  
82

- Slide "T1" to the top of the slats holding them against the railing.
- Use a level on the first slat to get it aligned correctly. "T1" will help align the rest of the slats.
- Fasten the top slats with the same hardware in the previous step.

Note: This side of the tower will use 10 slats to cover the entire side.

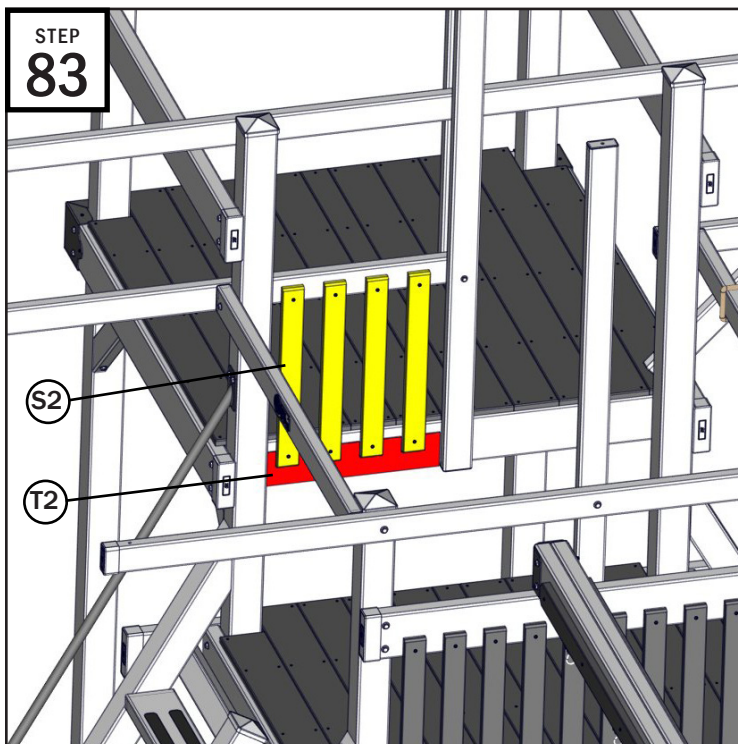

STEP  
83

- Grab the smaller slats (S2) & template (T2).
- Repeat the same process between the two towers on the left side. "T2" will fit between the posts & the (4) "S2" will fit in the grooves of "T2".

Note: This area will use all 4 Small slats. You are done using "T2".

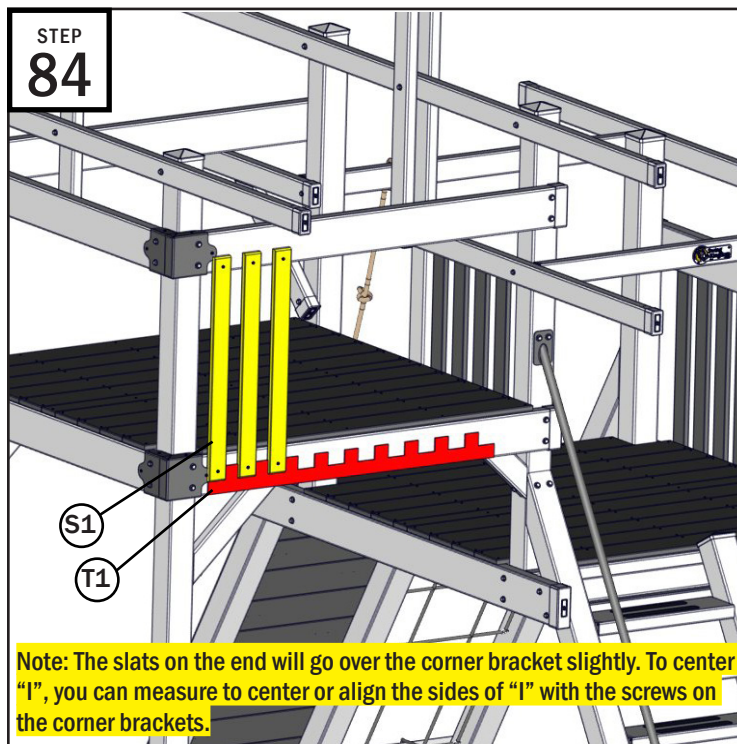

STEP  
84

Note: The slats on the end will go over the corner bracket slightly. To center "I", you can measure to center or align the sides of "I" with the screws on the corner brackets.

- Grab 3 more "S1" slats & "T1".
- Repeat the same process on the front of the extended tower. The edge of "T1" will align around the smaller screw on the corner bracket.

Note: This area will use all 3 slats on this side of the front



## POLY SLAT ASSEMBLY - ROOF ASSEMBLY (2)

STEP  
85

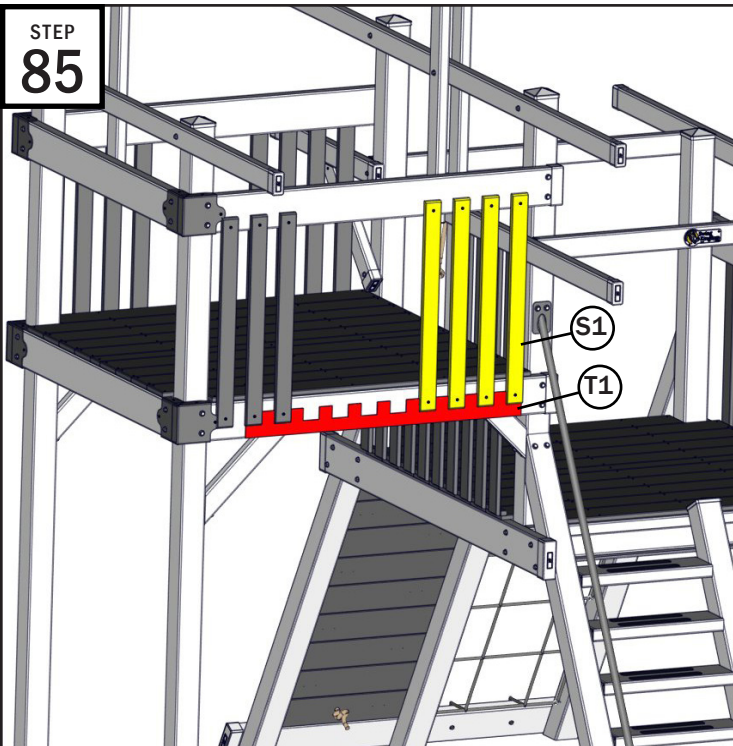

- On the same side, move "T1" down 1 "S1" so that "T1" is further to the right of the tower. This way you can reach far enough to mount the rest of "S1" for this side of the tower.

Note: The entire front side will have 7 poly slats (3 on the left & 4 on the right) & will leave an opening for the slide.

STEP  
86

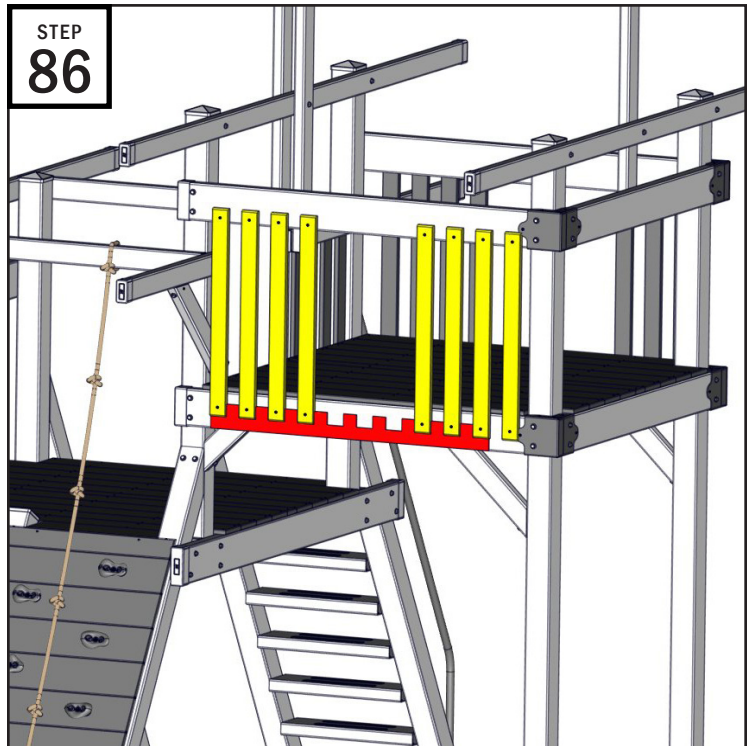

- Repeat the process on the back side of the extended tower.

Note: The entire back side will have 8 poly slats (4 on each side) & will leave an opening for the tic-tac-toe board.

STEP  
87

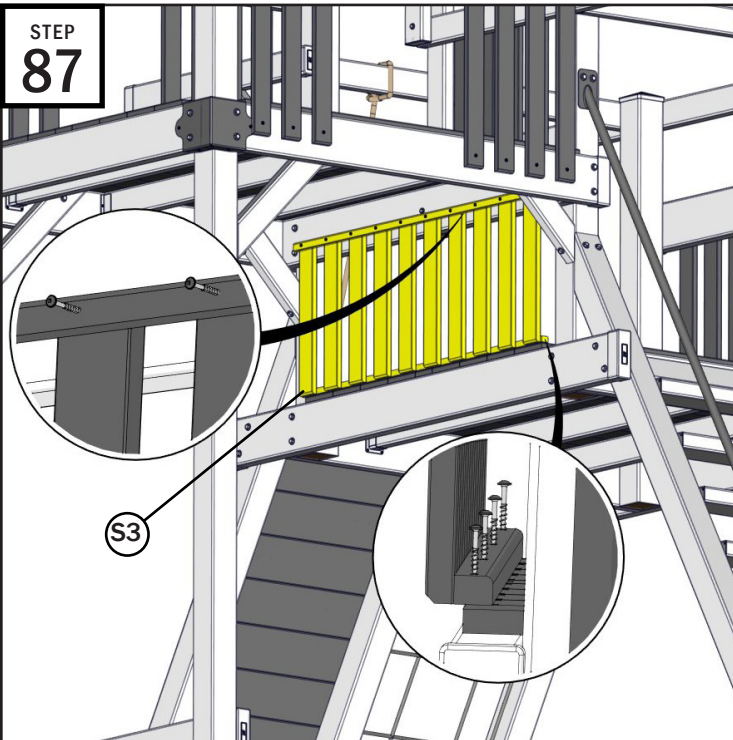

- "S3" will fit between the 2 towers, underneath the deck of the extended tower. The flat slim section with a flat base will sit right on the edge of the climber tower while the top section will sit against the 2x6 floor on the extended tower.
- Fasten these using 2" Washer Head Screws.

STEP  
88

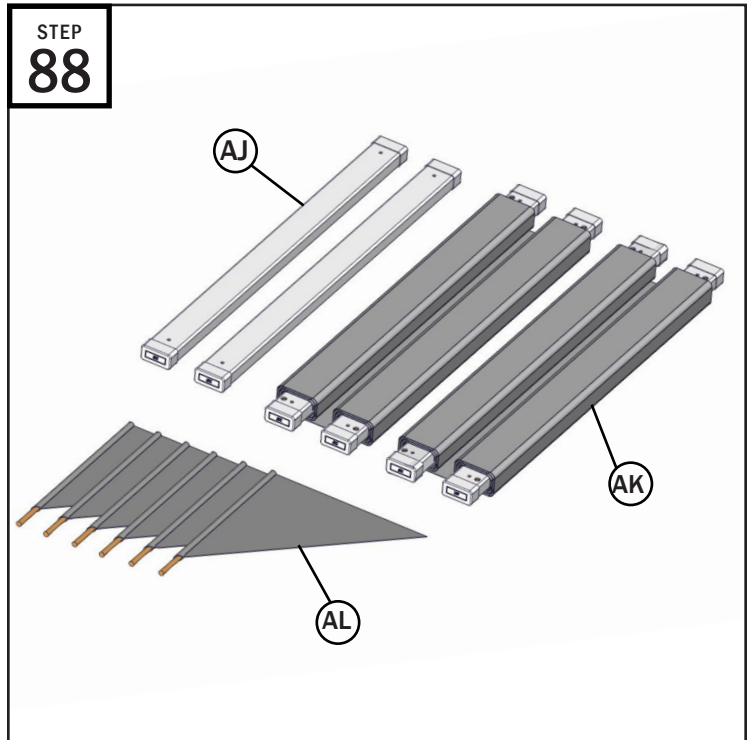

Locate the "Roof Canvas Bundle" which will include...

- AJ: (2) 59 1/2" Roof Horizontal 2x4
- AK: (2 total) (1) Canvas Roof with (2) 62 1/2" 2x4s
- AL: (1) Roof Flags

Also locate the "Roof Hardware" bag again.



## ROOF ASSEMBLY (2)

STEP  
89

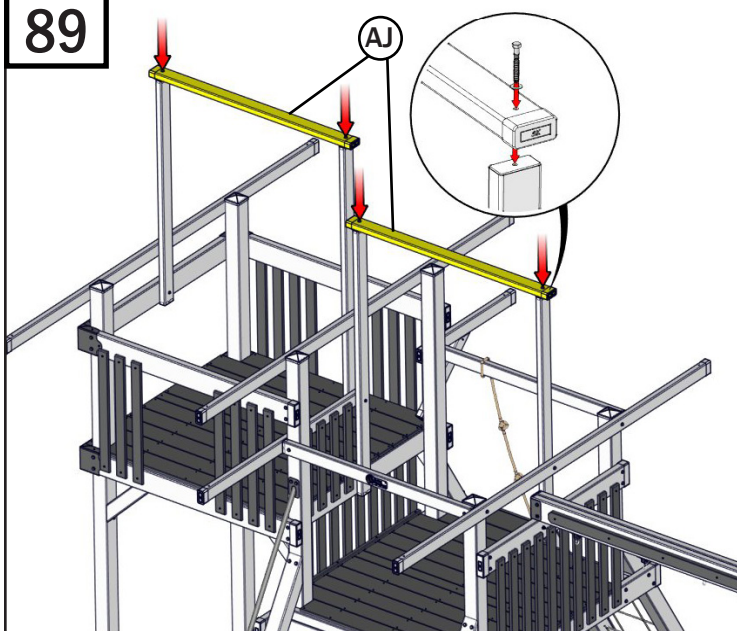

**Note:** DO NOT OVER-TIGHTEN. Fasten them enough so the parts touch. If the vinyl starts to dent or dimple, you know it is tight enough.

- Place "AJ" on top of the roof vertical pieces. 1 "AJ" will go over the climber tower & the other will go over the extension tower.
- The holes on "AJ" will line up with the top holes on the roof vertical pieces.
- Fasten "AJ" to the vertical pieces using (4) 9/16" x 4" Lags & 3/8" Washers.

STEP  
90

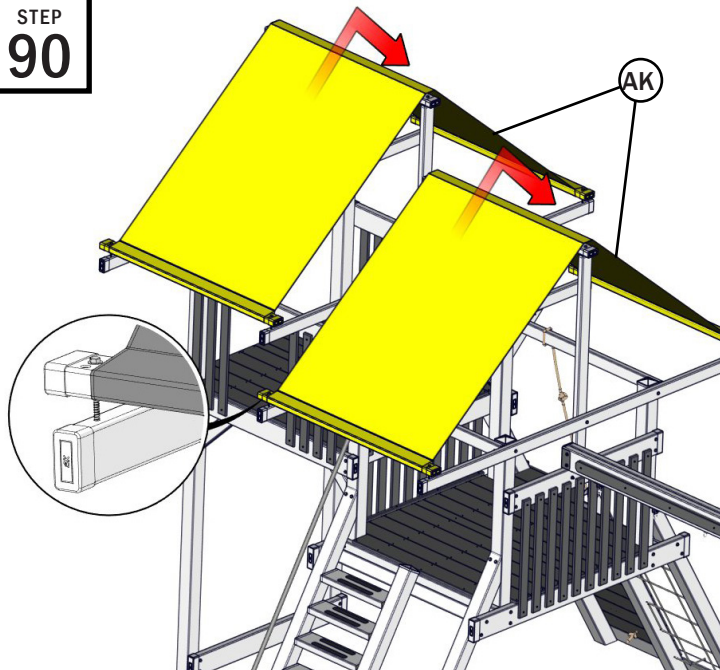

- Place one of the "AK" boards on one of the ends of the long railings. Make sure larger holes on "Z" are facing upwards.
- Using (2) 9/16" x 4" Lags & 3/8" Washers, drill into the smaller "AK" holes and drill into the railing end holes enough so that "AK" stays in place like the detail view above.
- Drape the "AK" Canvas over "AJ".
- Place the other "AK" board on the other end of the long railings.
- Repeat for the other canvas roof.

STEP  
91

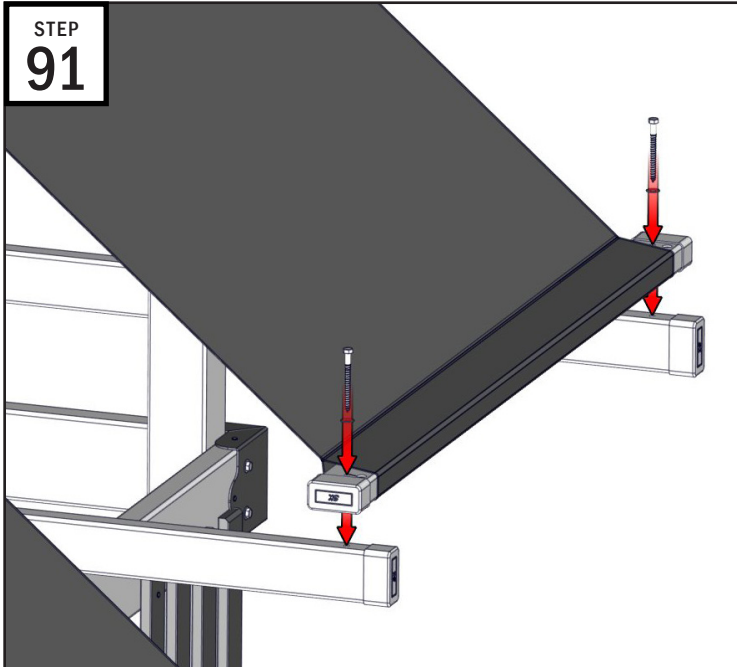

**Note:** DO NOT OVER-TIGHTEN. Fasten them enough so the parts touch. If the vinyl starts to dent or dimple, you know it is tight enough.

- Align the holes on the other side of the roof.
- Fasten using (2) 9/16" x 4" Lags & 3/8" Washers.
- Finish fastening the 2 Lags used to hold the original "Z" board from the previous step.

**Note:** This step will help tighten the canvas, so keep an eye on the canvas during this step.

STEP  
92

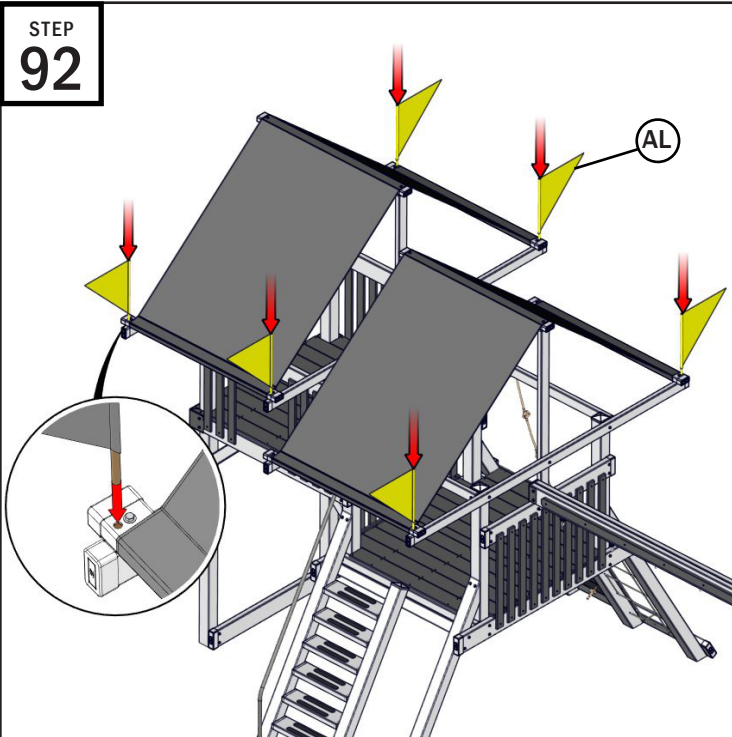

- The boards on the ends of the canvas will have larger holes.
- Place the (6) "AL" Flags in each of them. (The climber tower has 2 that won't be used since the roof railing above it will be in the way.)

## ACCESSORY INSTALL

STEP  
93

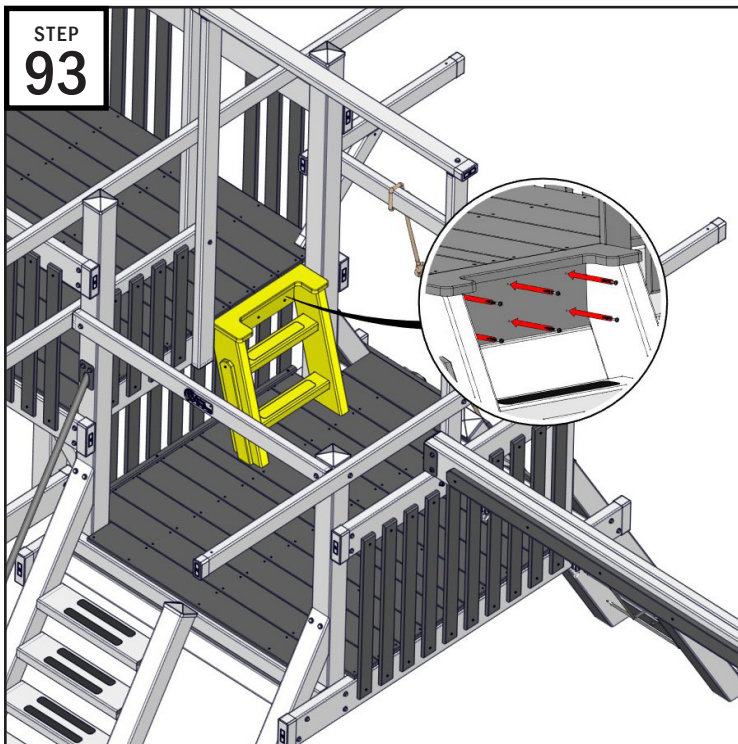

Locate the Ladder & the “Accessory Hardware” bag.

- Place in on the climber tower leading up to the extended tower in the opening.
- Using the 2 Square Drive Bit, drill (6) 2” Washer Head Screws through the back poly on the ladder into the tower 2x6.

STEP  
94

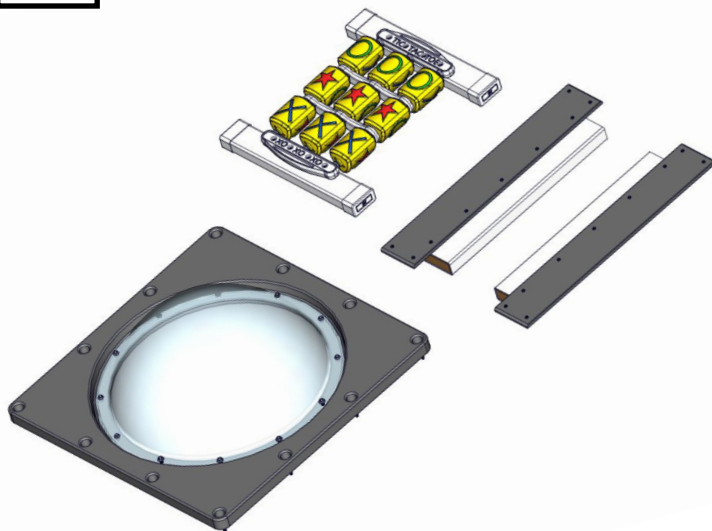

Locate the “Bubble Attachment Bundle” which includes...

- 26 1/4” 2x6 w/ poly attached

Locate the Bubble Panel & the Tic-Tac-Toe Panel.

STEP  
95

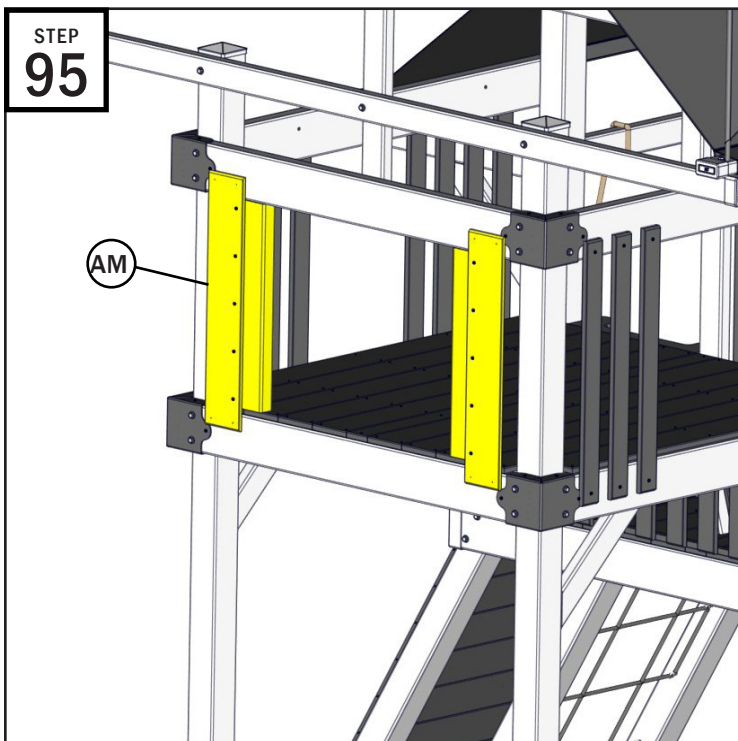

- On the far left side of the tower, place both “AM”s with the 2x6 between the decking & the railing. The Poly pieces will face away from each other.

STEP  
96

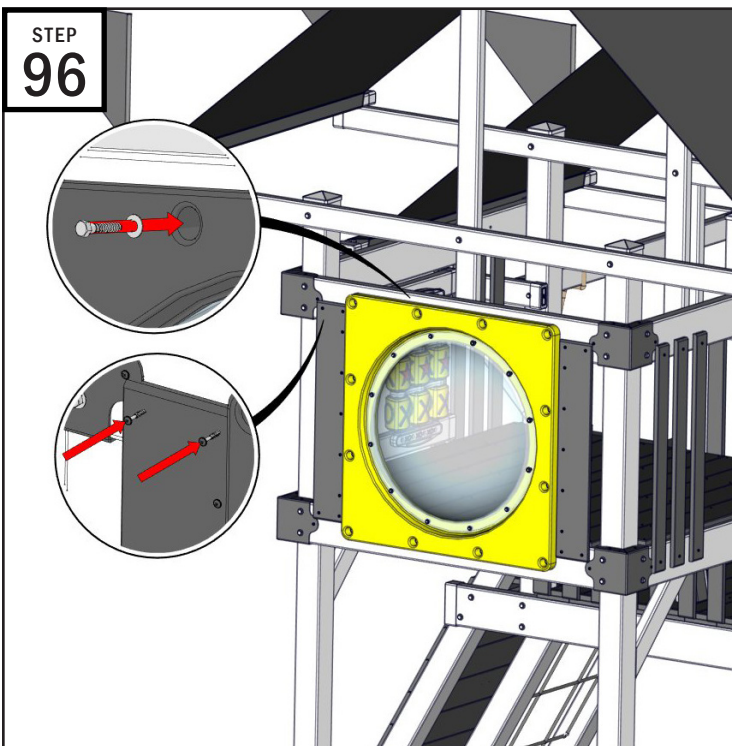

- Place the Dome on the Plate by lining up the holes and use the bolts provided with the bubble panel.
- Place the Bubble Panel between both “AM”s.
- Fasten the “AM”s using (8) 2” Washer Head Screws.
- Center the panel & Fasten to the tower using the lags provided.



## ACCESSORY INSTALL

STEP  
97

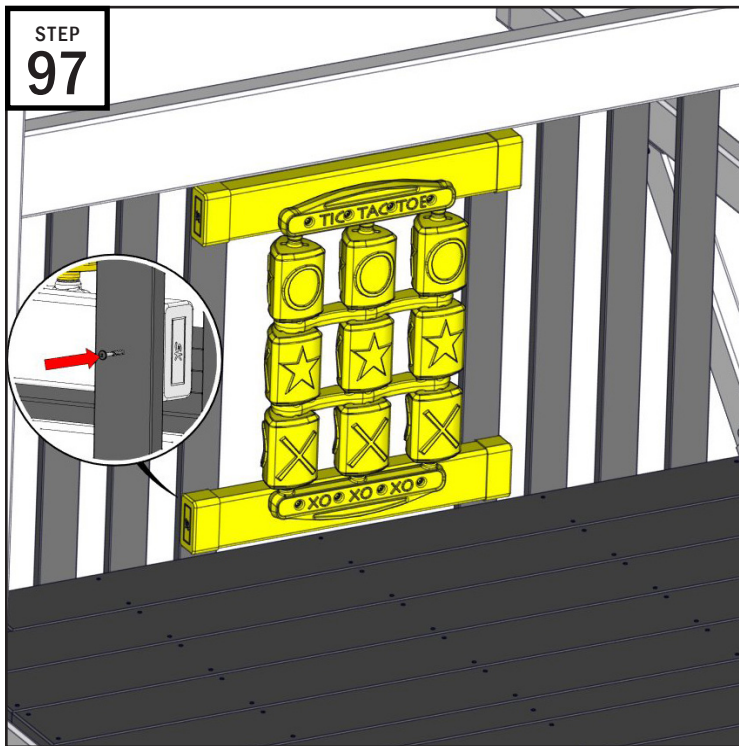

- Place the Tic-Tac-Toe Panel on the inside, back of the extended tower.
- Center the panel
- On the outside of the tower, fasten the panel to the poly slats using (4) 2" Washer Head Screws.

STEP  
98

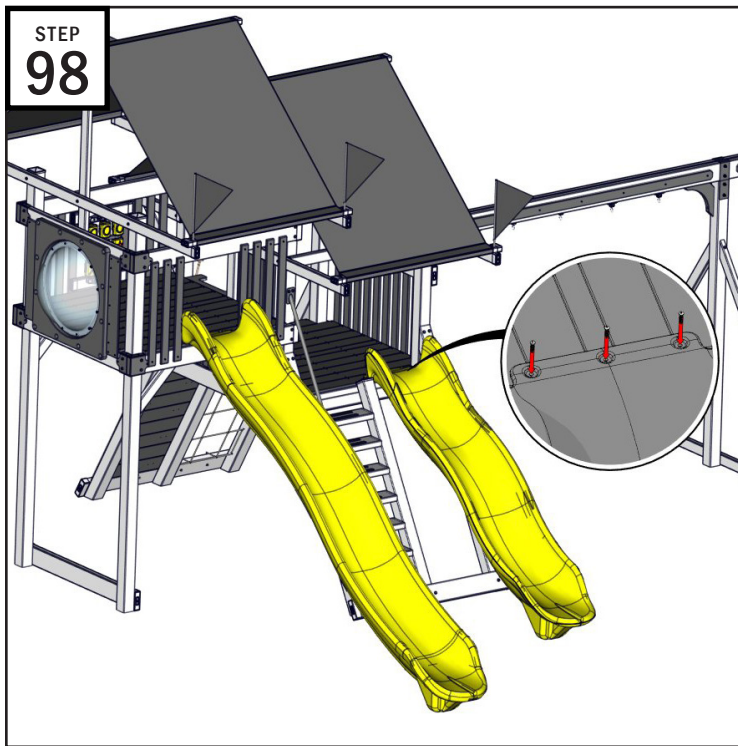

- Locate the 2 Avalanche slides. There will be a 10' & a 14'.
- Place the 10' on the climber tower next to the steps.
- Using (3) 1/4" x 1 1/4" Pan Head Screws & 5/16" Washers to fasten the slide to the tower decking.
- Place the 14' slide on the front of the extended tower & repeat the same fastening process.

STEP  
99

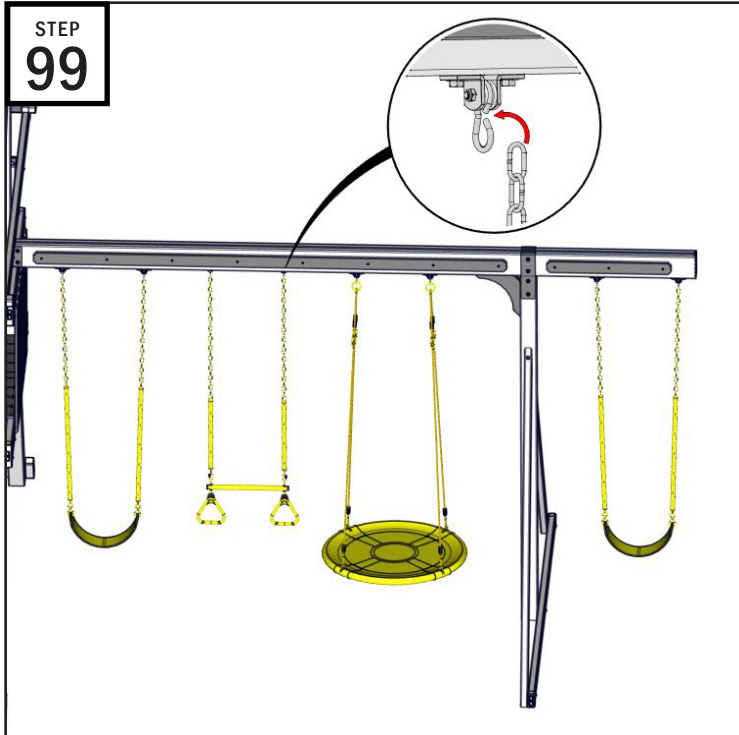

Locate the (2) Belt Swings, Trapeze, & the Web Swing.

- Hang all items from the Swing Hooks on the Swing Beam.
- There will be excess chain to adjust the height of the swing to the appropriate height.

STEP  
100

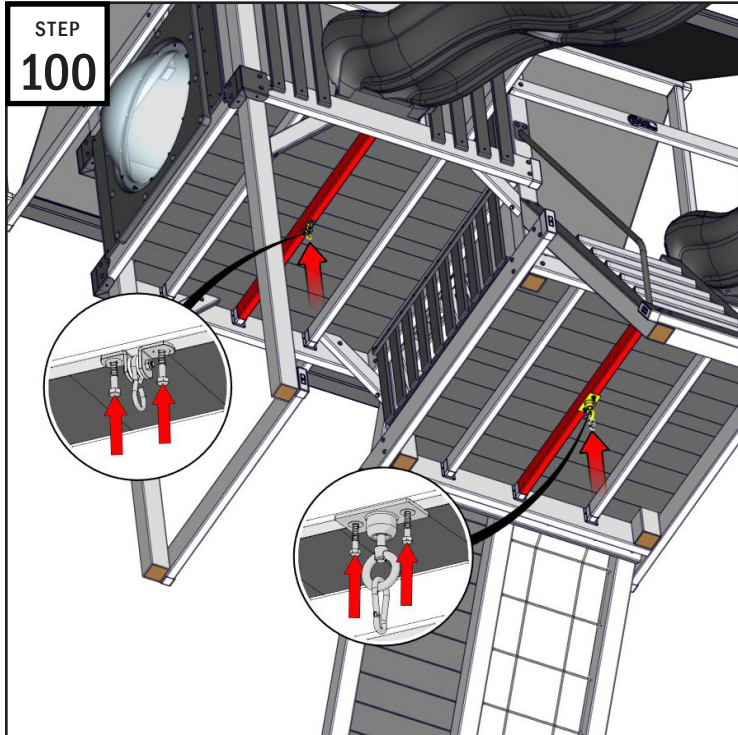

- In the Swing Hook Hardware, there should be (1) swing hook & (1) tire swivel attachment. The tire swivel will go under the climber tower & the swing hook will go under the extension tower.
- Like on the Swing Beam, mount these using (4) 9/16" x 3" Lags & 3/8" Washers. They will go on the center-most point on the center joists.



## ACCESSORY INSTALL - STAKE INSTALL

STEP  
101

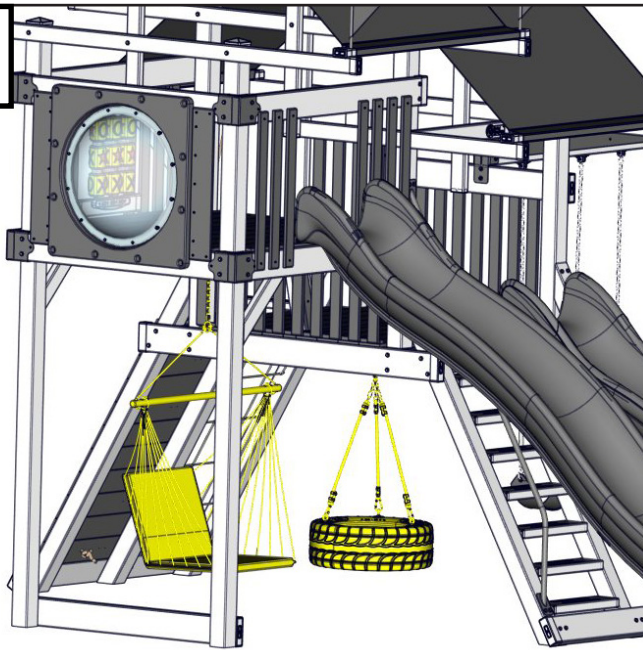

Locate the Hammock Swing & the Tire Swing.

- Hang the Hammock Swing onto the swing hook under the extension tower.
- Hang all 3 chains from the tire swing onto the swivel hook underneath the climber tower.

STEP  
102

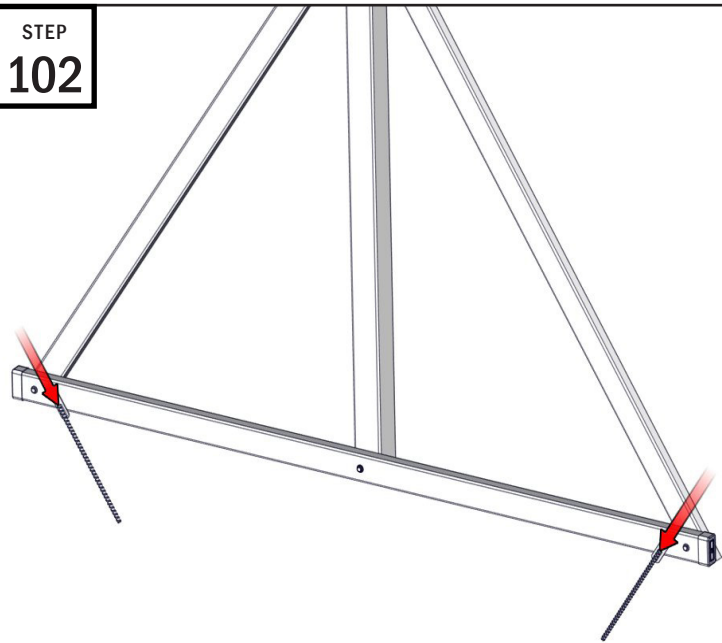

Locate the "Stake Bundle". This bundle will include:

- (2) Stakes
- (2) 1/2" x 1 1/2" Lags
- (2) 5/16" Washers

Using a hammer, drive a Stake into the ground at 45° (perpendicular to the swing braces) near the ends of the ground 2x4 of the Swing Frame.

STEP  
103

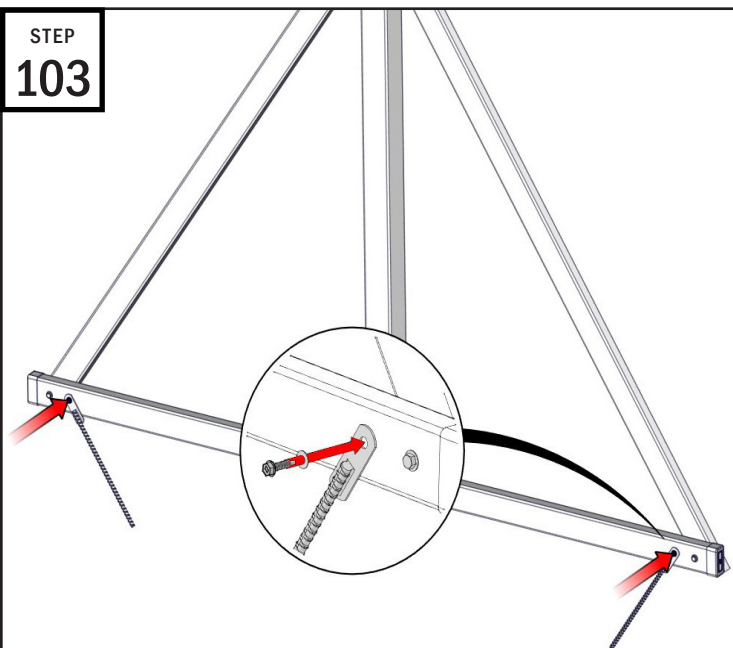

- Fasten the stakes to the Swing Beam using (2) 1/2" x 1 1/2" Lags and (2) 5/16" Washers.

The playset is now complete. Sometimes the vinyl will rub against itself in shipping. If you notice any marks, use Windex and a rag or steel wool to clean. Do not overuse steel wool as it can permanently scratch the playset.

# COMPLETED PLAYSETS

Mega Climber 55 shown in Almond & Green



Mega Climber 55 shown in White & Gray





# Swing Kingdom

MIGHTY PLAYSETS. SERIOUS FUN.

Technical Issues?

Contact us at:

Support@swingkingdom.com

717-656-4449